



Troughton Crescent Coventry CV6 1BH

**SHELDON
BOSLEY
KNIGHT** LAND AND
PROPERTY
PROFESSIONALS



1087.00 sq ft arranged over two floors.

Key Features

- Overlooking Moseley Avenue Park
 - Sought After Location
 - Three Bedrooms
 - End Of Terrace
 - Driveway To Front
 - Garden Room/Study
- Kitchen With Separate Utility
- Ample Living Accommodation
 - Generous Garden
 - Garage





The Property

This well maintained home overlooks Moseley Avenue Park and is situated with an abundance of local amenities. With also being within walking distance of Coventry City Centre and high performing primary & secondary schools.

The ground floor offers a welcoming entrance hall, opening out onto the lounge with feature bay window, fitted kitchen, extended utility room and lastly a separate dining room with sliding patio doors that open out onto the rear garden.

The first floor comprises of a family bathroom, two double bedrooms and a single bedroom, with bedroom one also offering built in wardrobes and a feature bay window.

Externally, you are met with a family sized garden space, with rear access and also access to the garage and garden room which is currently being finished to be a fully functional room. To the front you have a two space driveway with a brilliant view onto the park.









To view this beautiful home, please call
Sheldon Bosley Knight Sales on 02476 635555

Floorplan

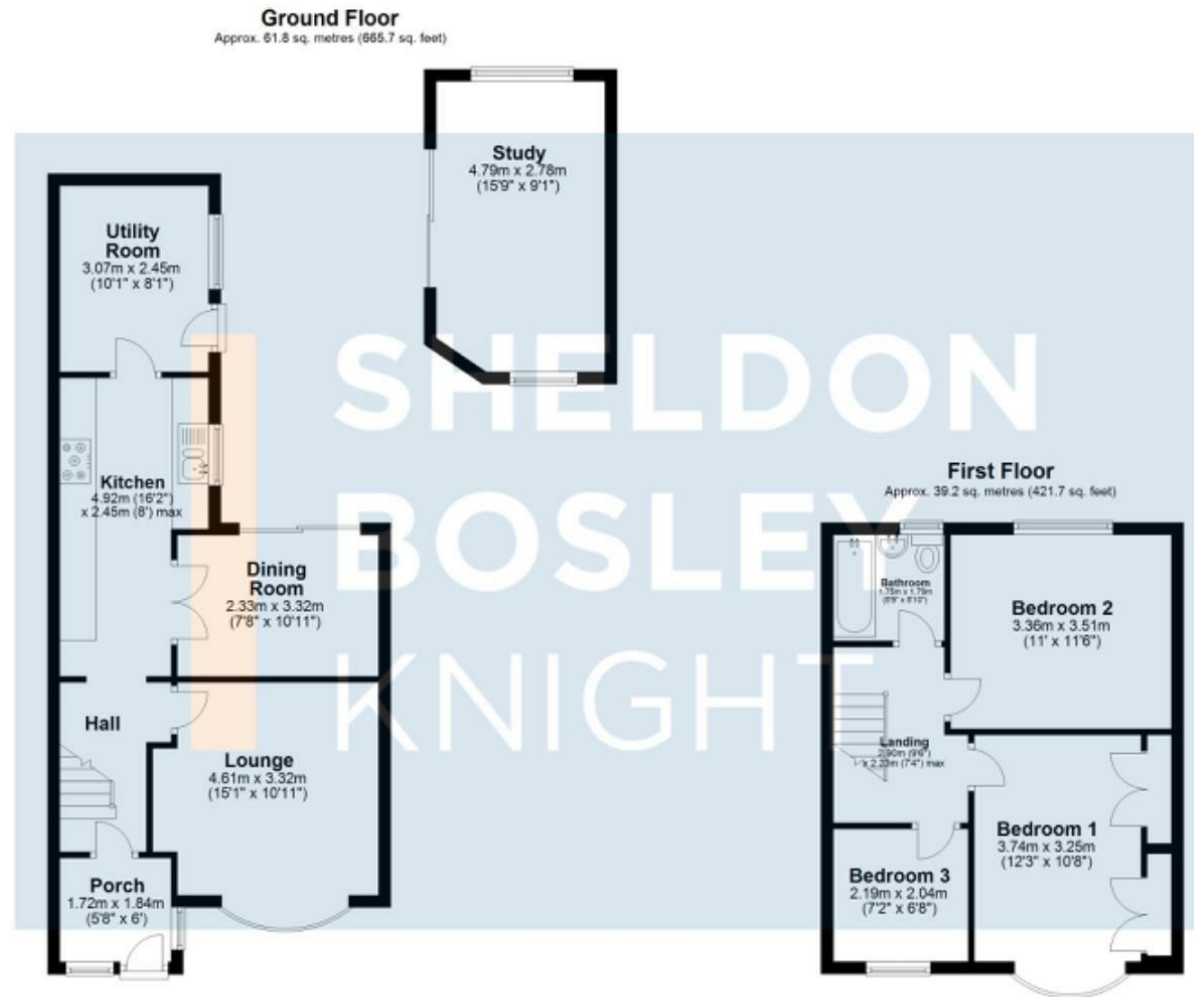

Total area: approx. 101.0 sq. metres (1087.4 sq. feet)

All efforts have been made to ensure that the measurements on this floorplan are accurate however these are for guidance purposes only.
Plan produced using PlanUp.

To book a free no obligation market appraisal of your property contact your local office