



42 Hammond Close
Weldon NN17 3FH

£255,000



42 Hammond Close

Weldon NN17 3FH

Showhome Condition! This fabulous stone built three bedroom property is situated in the sought after village of Weldon and has been much improved by the current owners. Features include a superb contemporary kitchen/breakfast room, well proportioned living room and a downstairs wc. Upstairs offers a master bedroom with en-suite shower room, two further bedrooms and a contemporary family bathroom. It doesn't stop there, as the front and rear gardens have been lovingly tended. An extended paved patio leads to a lawned garden with inset flower beds and a variety of fruit trees, along with that all important shed tucked neatly to the side of the property. The front garden too has been planted with flower beds and shrubs, whilst a driveway provides off road parking for several vehicles. All you need is your furniture !





Floor Plan

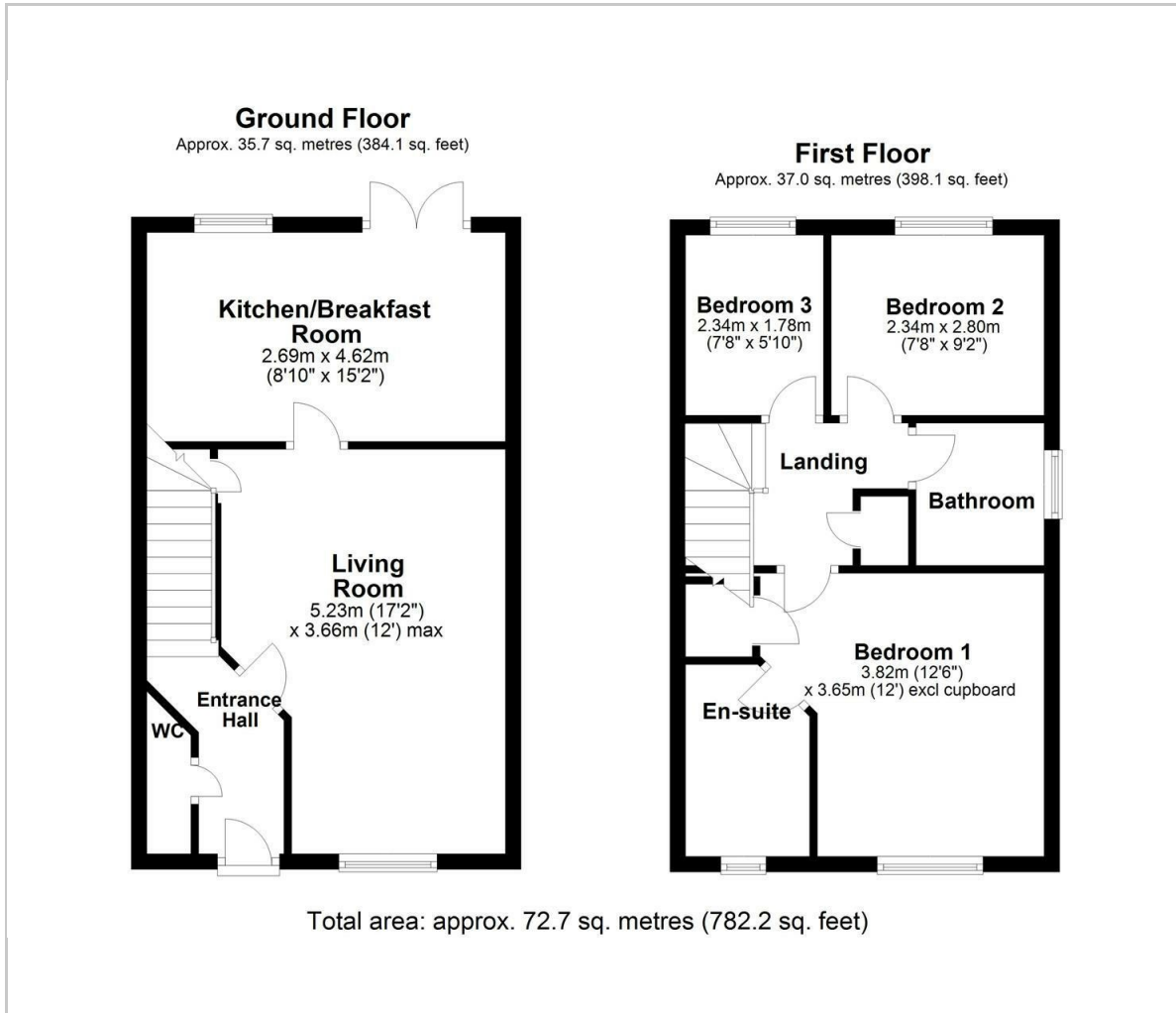

Viewing

Please contact our Priors Estate Agents Office on 07721396411 if you wish to arrange a viewing appointment for this property or require further information.

These particulars, whilst believed to be accurate are set out as a general outline only for guidance and do not constitute any part of an offer or contract. Intending purchasers should not rely on them as statements of representation of fact, but must satisfy themselves by inspection or otherwise as to their accuracy. No person in this firm's employment has the authority to make or give any representation or warranty in respect of the property.

Corby Enterprise Centre London Road, Corby, Northants, NN17 5EU
 Tel: 07721396411 Email: simon@priorsestateagents.co.uk priorsestateagents.co.uk

Area Map



Energy Efficiency Graph

