

CURRAN
BIRDS
+ CO

Forget Me Not Cottage, Chevin Road
Milford, Derbyshire
£189,950



CURRAN BIRDS + CO

Welcome to CB+CO, where *dedication* meets *excellence*, and impeccable service is our hallmark.



CHARACTER GRADE II LISTED STONE COTTAGE - An attractive Grade II listed, three storey stone cottage, set in the heart of Milford's conservation area. This property would be ideally suited to a first time buyer or as a potential holiday let and is situated in this attractive village located between Duffield and Belper. This property offers easy access to beautiful countryside walks and has a delightful view towards the Milford Chimney from its courtyard rear garden.

This delightful two bedroom character property offers a wealth of character and charm and in brief comprises a charming living dining room with beautiful stone fireplace with log burner and beamed ceiling leading to a fitted kitchen with access to the rear courtyard garden. The first floor landing leads to a spacious primary bedroom and the second floor landing leads to bedroom two and bathroom.

Outside, the property has a compact courtyard rear garden with brick store and delightful views.





The Detail

Upon entering Forget Me Not Cottage, the traditional wood-paneled door creates an immediate sense of warmth, leading into the delightful living and dining area. This charming space is enhanced by a recessed stone fireplace with a cast iron log burner and stone lintel, creating a cosy focal point. The beamed ceiling with built-in shelving adds character, while the two front-facing windows allow plenty of natural light. The kitchen, situated at the rear, features classic cream shaker-style units with pine handles, combining both functionality and rustic charm. The Belfast sink with a chrome mixer tap takes centre stage, while the wood block work surface complements the traditional design. Appliances include an automatic washing machine, space for a standalone dual fuel cooker, and a low-level fridge, offering convenience for everyday living. The kitchen also gives access to the gas central heating boiler.

An open-plan staircase leads you to the first floor, where the spacious primary bedroom offers a front facing window and there is a further staircase leading to the second floor spacious landing leads to a second bedroom benefiting from built-in storage, including a wardrobe, recessed cupboards, and shelving. The bathroom offers a three piece suite with panelled bath with chrome shower unit, pedestal wash basin, and low-level WC, along with built-in shelving for extra storage and rear window.

Outside, to the rear a courtyard garden provides a tranquil space for relaxation, featuring a brick-built outbuilding and scenic views of the Milford chimney and woodland on Chevin Bank, offering a compact and manageable outdoor space.





CURRAN BIRDS + CO

The Location

Forget Me Not Cottage is ideally situated in Milford, offering a peaceful village setting with easy access to both Belper and Duffield, each providing a range of amenities. The village itself boasts a local primary school, making it an excellent choice for families. It is also well-positioned for outdoor enthusiasts, with great countryside walks across the nearby Chevin and along the River Derwent, offering beautiful scenic routes.

For those who enjoy local pubs, the village features excellent options, including the Milford Social Club and the nearby Holly Bush in Makeney, renowned for its extensive selection of cask ales. Additionally, the Palfrey on Hopping Hill is a popular spot for dining, offering a great atmosphere and delicious meals. With its tranquil surroundings and proximity to both Belper and Duffield, this location provides the perfect balance of peaceful village living with easy access to local amenities and recreational opportunities.







Forget Me Not Cottage, Chevin Road

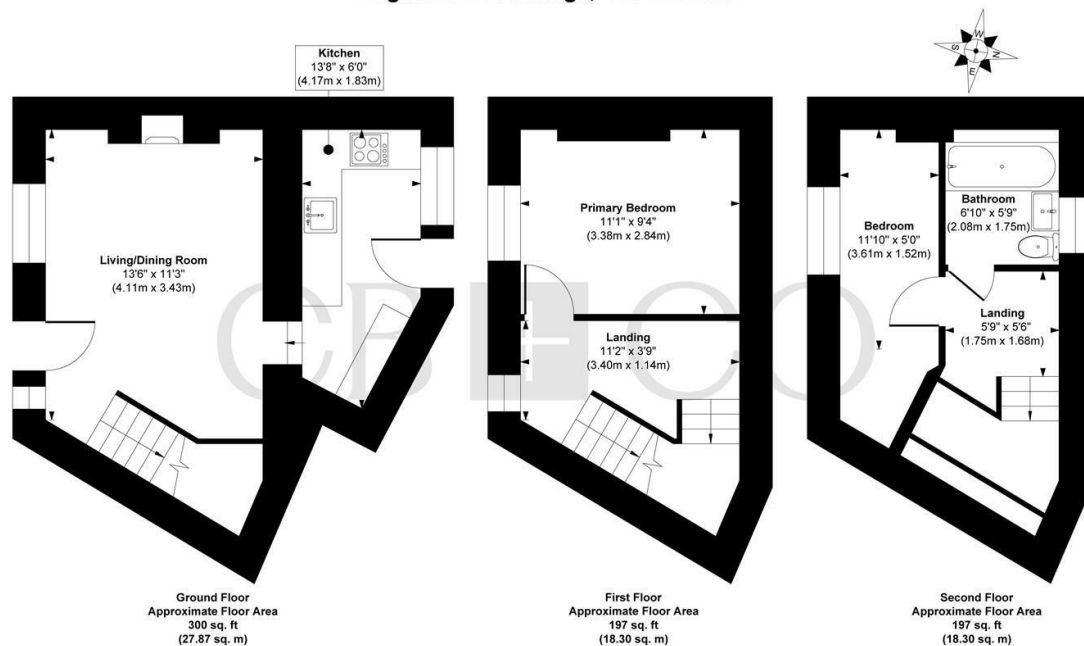

Approx. Gross Internal Floor Area 694 sq. ft / 64.47 sq. m

Illustration for identification purposes only, measurements are approximate, not to scale.
Produced by Elements Property

The Particulars

- Charming Grade II Listed Three Storey Stone Cottage
- Set in Delightful Village Conservation Area
- Wealth of Character & Charm - Gas Central Heating
- Charming Living Dining Room with Log Burner & Fitted Kitchen
- First Floor - Landing & Spacious Primary Bedroom
- Second Floor - Spacious Landing, Bedroom Two & Bathroom
- Compact Courtyard Rear Garden with Brick Store & Delightful Views
- Easy Access to Belper & Duffield
- Close to Delightful Countryside & Riverside Walks
- No Chain Involved

Size

Approx 694.00 sq ft

Energy Performance Certificate (EPC)

Rating

Council Tax Band

A

CURRAN BIRDS + CO

Let's *Talk*

01332 411050
hello@curranbirds.co
curranbirds.co

The particulars above are a guide, not an offer or contract. Descriptions photographs and plans are not statements or representations of fact. Measurements are approximate and not to scale. Prospective purchasers must verify the accuracy of the information within the particulars. Curran Birds + Co does not give any representations or warranties; nor represent the Seller legally. Curran Birds + Co has no liability, for any costs, losses or expenses incurred by the Seller or a prospective buyer relating to the sales and buying transaction. Our Sales Disclaimer, trading names and privacy policy on how your data is processed and used is found in full on our website in our Privacy Statement.

© Curran Birds + Co 2024 All rights Reserved