



CHATTERTON | REES



5 Montague Park, Windsor, SL4 4BD  
£6,500 Per month

 5  4  3  B







# 5 Montague Park

Windsor, SL4 4BD

- Five Bedrooms
- Three Reception Rooms
- West facing Garden
- Tennis Courts
- Four Bathrooms
- Garage
- Gated Development
- Communal Grounds

An excellent 5 bedroom detached house set within an exclusive gated development between Ascot and Windsor. The house spans close to 3500sqft over three floors, including 3 reception rooms, a large garage, utility room and a large west facing garden.

The development has communal grounds, a pond and two tennis courts as well as secure gated entry.

Educational opportunities are extensive and include St. George's Windsor Castle and Upton House in Windsor, St. George's, St. Mary's, Heathfield and Papplewick in Ascot, Lambrook in Winkfield Row, Eton College, Wellington College in Crowthorne and Royal Holloway in Egham.

The M4 provides access to Heathrow Airport, Central London and the West Country and also links to the M25, which in turn provides access to the M3. Rail access is equally convenient with direct services to London (Waterloo)

EPC B. Council Tax Band G. Deposit £9,000. Holding Deposit £1,500.

£6,500 Per month





## Directions







Floor Plans

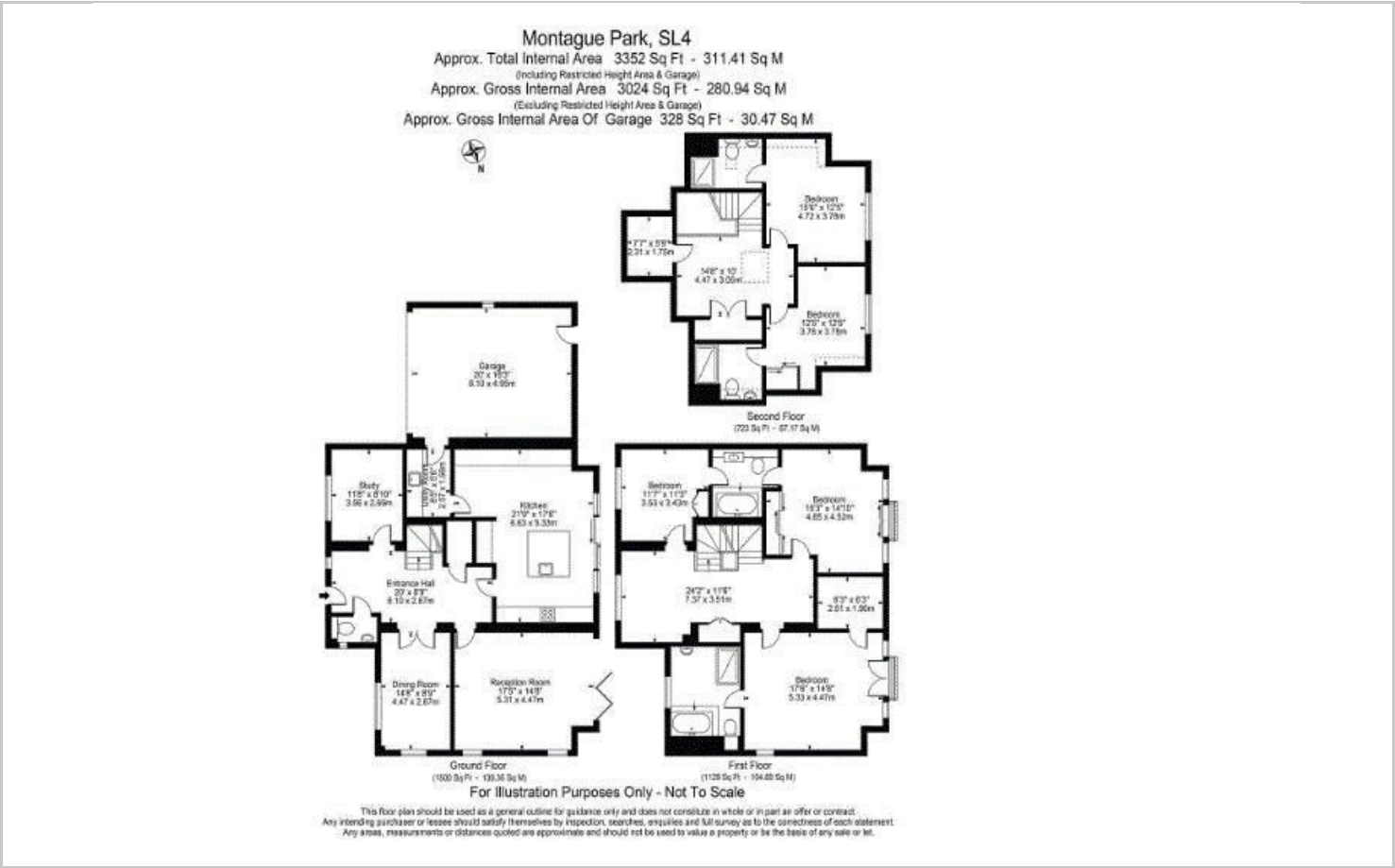

Viewing

Please contact our Sunningdale Country Homes Office on 020 3780 0580 if you wish to arrange a viewing appointment for this property or require further information.

The particulars are set out as a general outline only for the guidance of intended purchasers or lessees, and do not constitute, any part of a contract. Nothing in these particulars shall be deemed to be a statement that the property is in good structural condition or otherwise nor that any of the services, appliances, equipment or facilities are in good working order. Purchasers should satisfy themselves of this prior to purchasing.

Location Map



Energy Performance Graph

