



CHATTERTON | REES



Tory Hall Farm Winkfield Lane, Windsor, SL4 4QU  
Guide price £3,500,000





# Tory Hall Farm Winkfield Lane

Windsor, SL4 4QU

- Five Bedrooms
- Four Reception Rooms
- Separate Studio & One Bed Apartment
- Double Garage
- Equestrian Facilities
- Three Bathrooms
- Outdoor Pool & Pool House
- Home Gym
- Circa 2 acres
- Gated

A stunning gated Victorian country home set in roughly two acres with flexible accommodation, equestrian facilities and beautifully landscaped gardens. Tory Hall Farm boasts six bedrooms, three bathrooms and four reception rooms in the main house, outside offers a separate one bedroom annexe and studio apartment, outdoor pool complete with a pool house, double garage, three stables and a listed barn used as a gym space.

The M4 provides access to Heathrow Airport, Central London and the West Country and also links to the M25, which in turn provides access to the M3. Rail access is equally convenient with direct services to London (Waterloo) available from Ascot and Windsor. Services direct to London (Paddington) are from Slough with a connection to Windsor available. Crossrail, the new high speed service, is due to begin running soon and will link Maidenhead directly with Heathrow and the City.

Educational opportunities are extensive and include Lambrook in Winkfield Row, St. George's and Upton House in Windsor, St. Mary's, Heathfield and Papplewick in Ascot, Eton College, Wellington College in Crowthorne and Royal Holloway in Egham.

Guide price £3,500,000





**Directions**





## Floor Plans

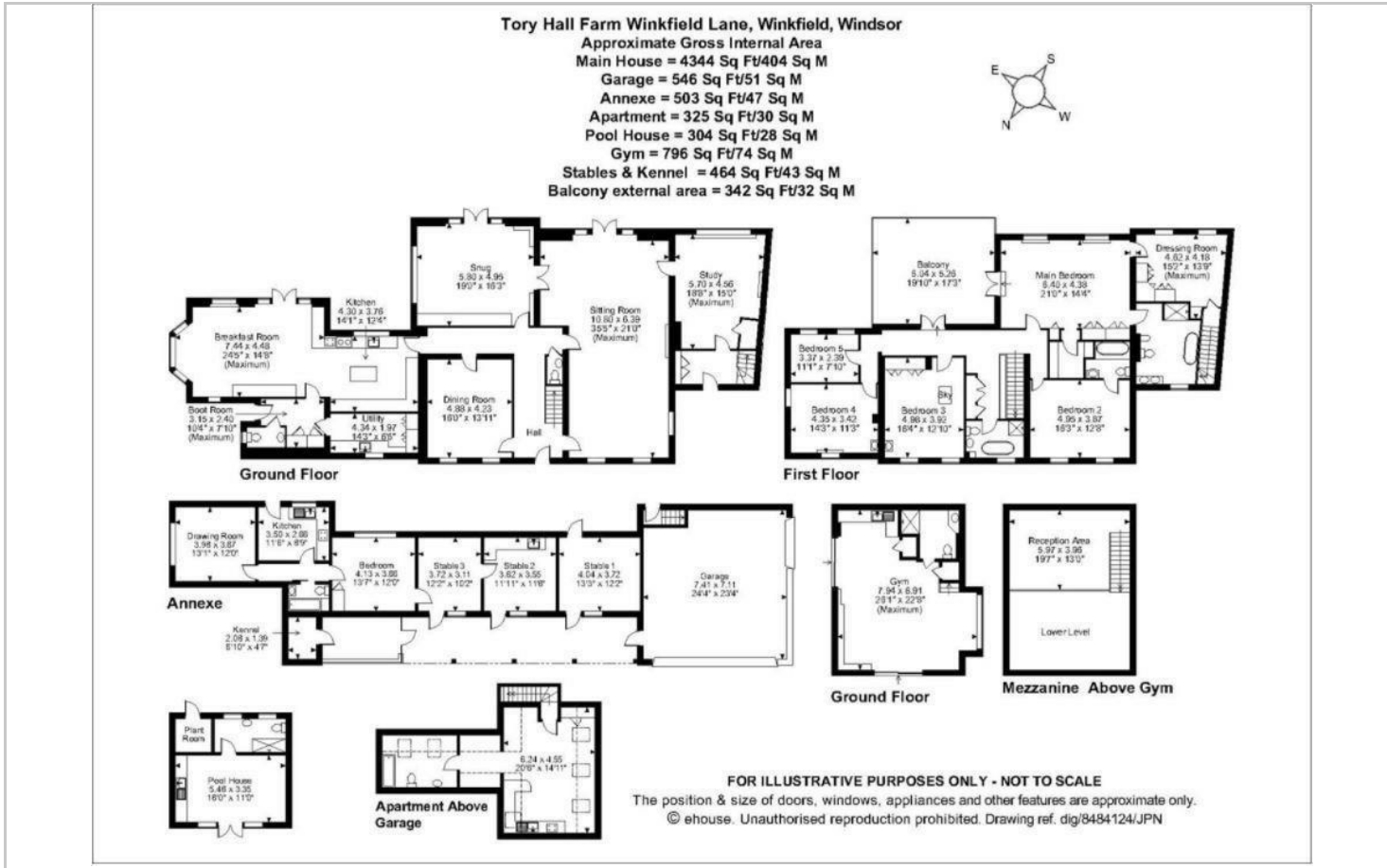

## Location Map

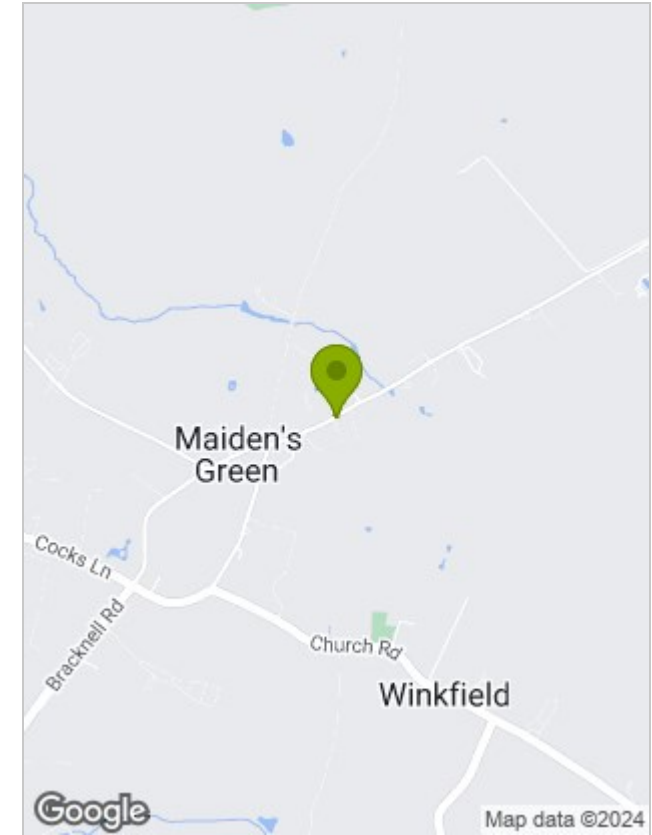

## Viewing

Please contact our Sunningdale Country Homes Office on 020 3780 0580 if you wish to arrange a viewing appointment for this property or require further information.

The particulars are set out as a general outline only for the guidance of intended purchasers or lessees, and do not constitute, any part of a contract. Nothing in these particulars shall be deemed to be a statement that the property is in good structural condition or otherwise nor that any of the services, appliances, equipment or facilities are in good working order. Purchasers should satisfy themselves of this prior to purchasing.

## Energy Performance Graph

