



1 Kelso Road

Coldstream, Berwickshire, TD12 4LG

northwood



Enjoying a leafy setting on the outskirts of Coldstream, within easy walking distance of the town centre, this semi-detached bungalow benefits from private parking and gardens to three sides that offer south-facing country views to the rear. The versatile interiors include three double bedrooms, a bathroom, good built-in storage, and a dual-aspect reception room leading to a bright kitchen with garden access. The property presents exciting opportunities for internal refurbishment and external landscaping within its spacious grounds that house a detached workshop and store.

Extras: The property is sold as seen.

-
- Leafy setting with country views
 - Walking distance to amenities
 - Refurbishment opportunity
 - Semi-detached bungalow
 - Entrance vestibule and hall with storage
 - South-facing living/dining room
 - Fitted kitchen with garden access
 - Three double bedrooms with storage
 - Bathroom with shower-over-bath
 - Generous gardens with workshop/store & sunny rear aspect
 - Private driveway
 - Gas central heating and double glazing
 - EPC Rating - C





“Leafy setting with country views, south-facing living/dining room & three double bedrooms with storage”







**“Generous gardens with
workshop/store and
sunny rear aspect”**





Floorplan

Outbuilding
Approx. 15.5 sq. metres (166.8 sq. feet)

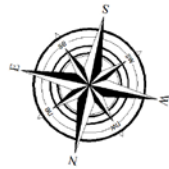
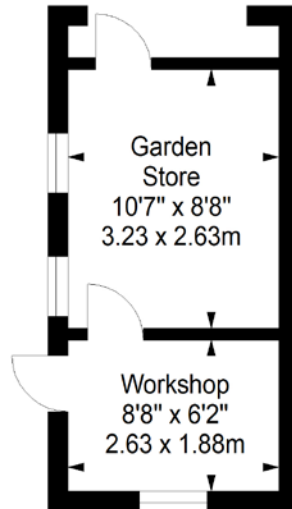

Ground Floor
Approx. 82.3 sq. metres (885.9 sq. feet)

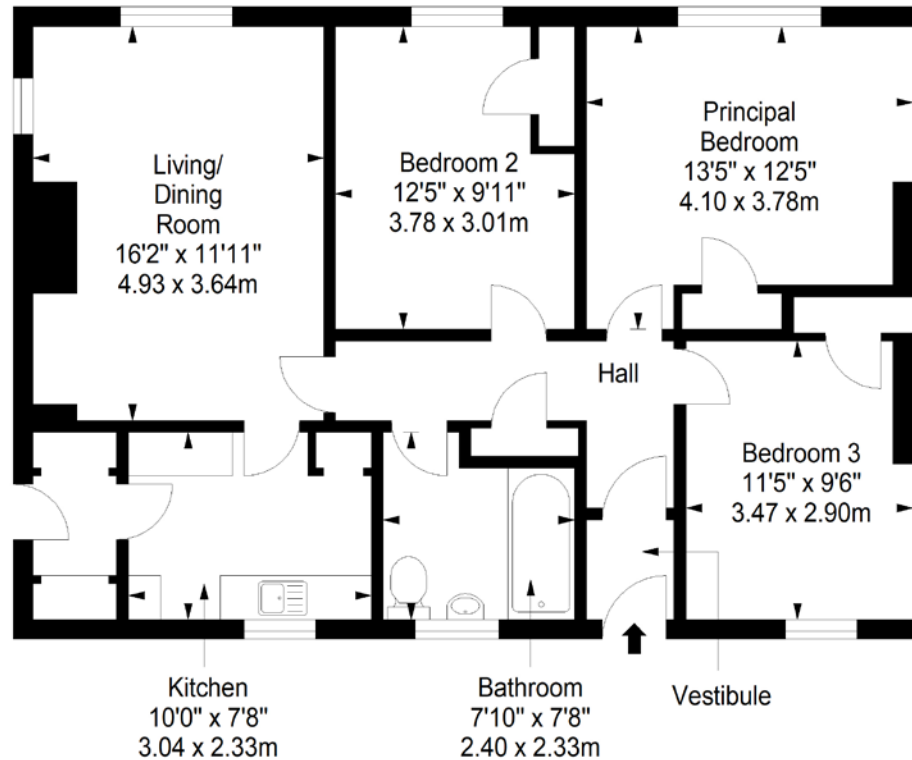

Total area: approx. 97.8 sq. metres (1052.7 sq. feet)