

Approx Gross Floor Area = 779 Sq. Feet

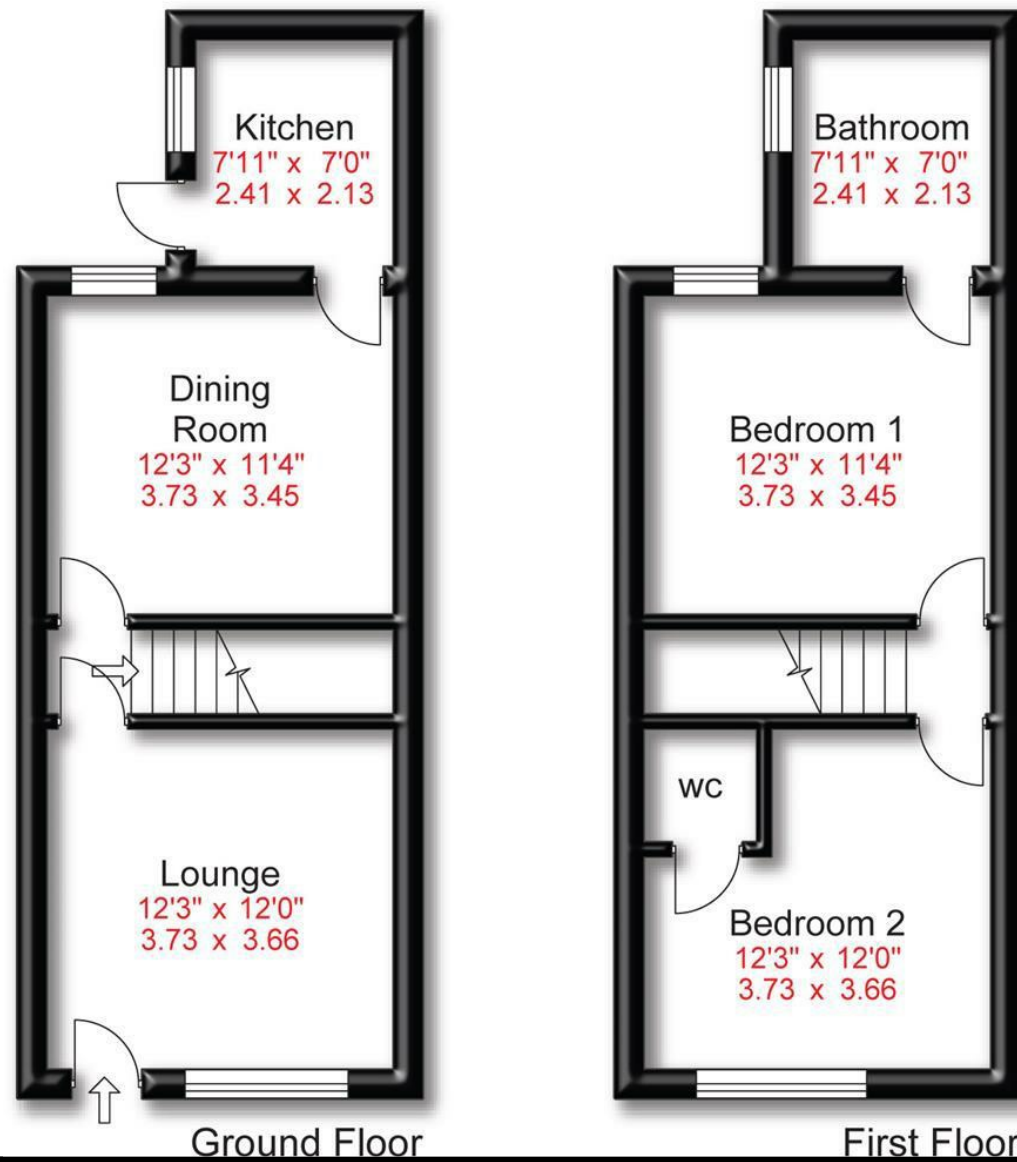

Energy Efficiency Rating		Current	Potential
Very energy efficient - lower running costs			
(92 plus) A			
(81-91) B			84
(69-80) C			
(55-68) D		53	
(39-54) E			
(21-38) F			
(1-20) G			
Not energy efficient - higher running costs			
England & Wales	EU Directive 2002/91/EC		



Belgrave Road |
Offers Over £280,000



88 School Road | Sale | M33 7XB
t: 0161 973 4955
e: sale@hibberthomes.com
www.hibberthomes.com

SALES & LETTINGS

Bedrooms 2

Bath 2

Reception 2

Parking here

Area 926.00 sq ft

Type here



- Ideal For First Time Buyers
- Two W.CS
- Council Tax Band B
- Excellent Investment Property

- Two Reception Rooms
- Close To The Town Centre
- Freehold
- Close To Metrolink

Hibbert Homes are proud to present this two bedroom mid terrace property located in the popular area of Sale. Ideally located within close proximity to Sale Town centre which has an array of shops, restaurants, pubs and bars. The property has excellent transport links with the Metrolink close by and access to the motorway, close to schools and local parks means the property is ideal for first time buyers, couples or families or even buy to let investors.

The property comprises; Lounge, dining room, kitchen, upstairs there is a landing, two bedrooms one with a w/c the other with a bathroom. Externally there is a yard to the rear. A viewing is highly recommended.

