

**Ground Floor**

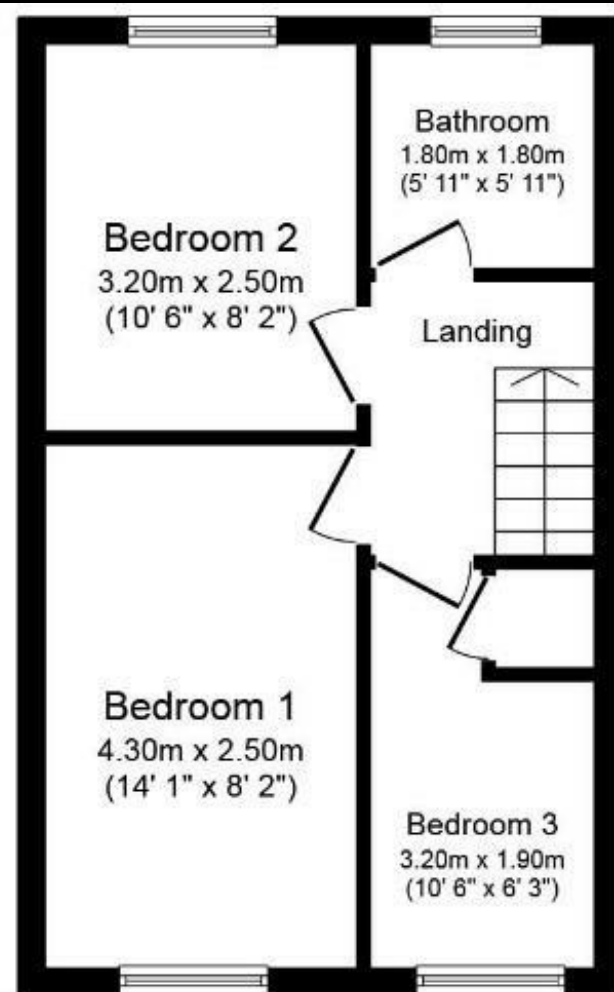

**First Floor**

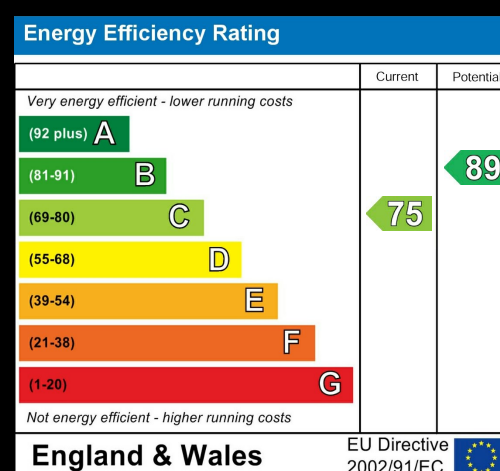

**Amberwood Drive |**  
**£1,300 PCM**



**SALES & LETTINGS**

88 School Road | Sale | M33 7XB  
t: 0161 973 4955  
e: sale@hibberthomes.com  
www.hibberthomes.com

Bedrooms 3

Bath 1

Reception 1

Parking here

Area  
818.06 sq ft

Type here





A WELL PRESENTED THREE BEDROOM MID-TERRACE WITH ENCLOSED PRIVATE REAR GARDEN..... Located in a popular residential location close to Timperley Village. Briefly comprising: Entrance porch. Large spacious lounge with open staircase. Fully fitted dining kitchen which extends across the full width of the property, with patio doors leading out to a delightful rear garden. At first floor level there are three well proportioned bedrooms plus a family bathroom with a modern white suite and a shower over the bath. To the front of the property there is a neatly laid garden. GCH. Unfurnished. AVAILABLE 21/11/25. Council tax band - B. EPC Rating - C.

