

Approx Gross Floor Area = 702 Sq. Feet

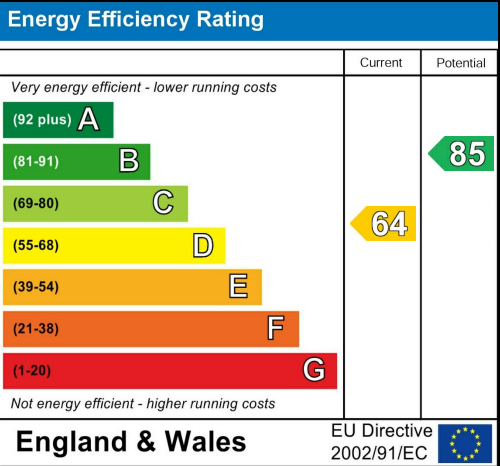

Gateacre Walk |  
Price Guide £270,000

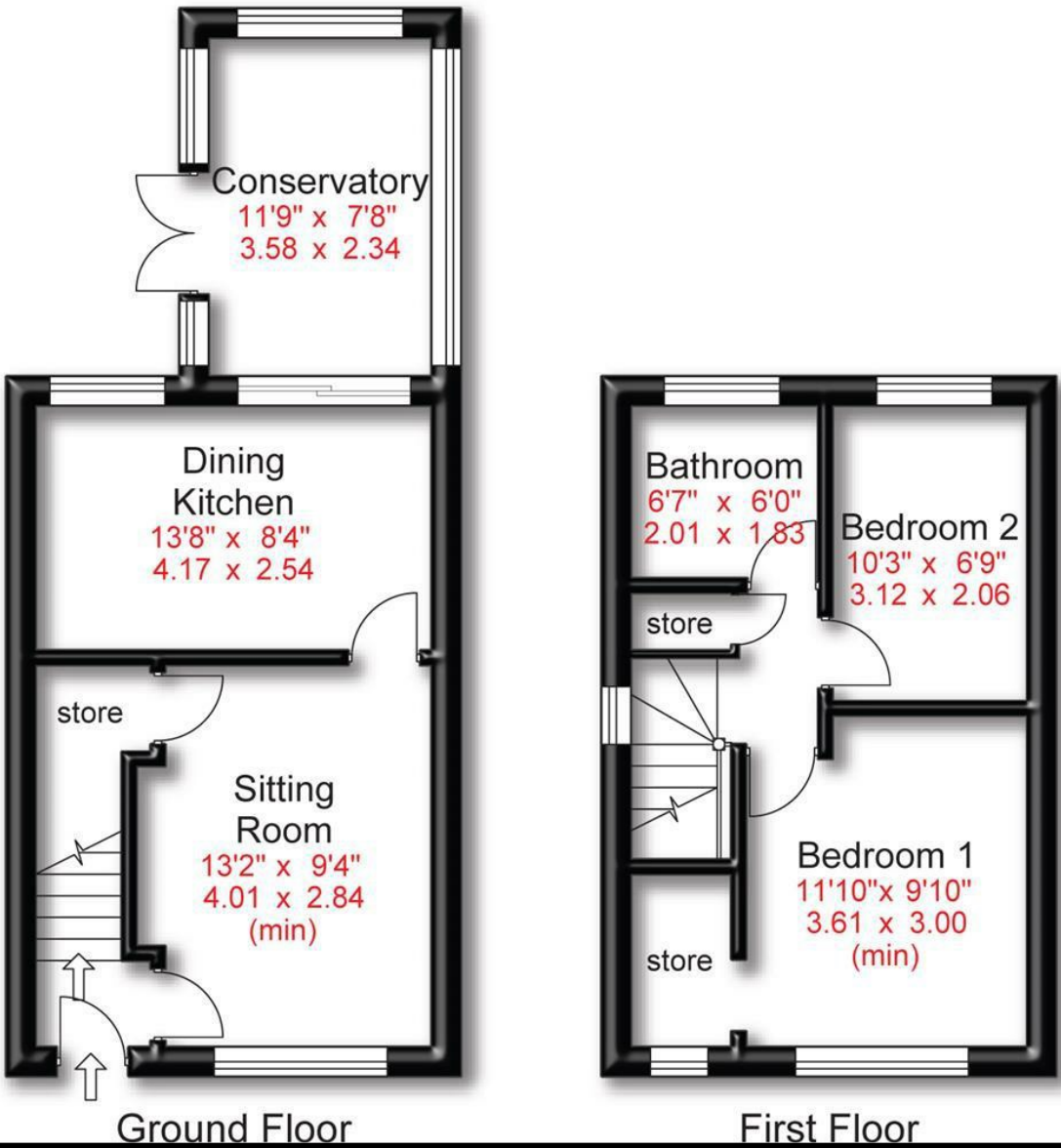

88 School Road | Sale | M33 7XB  
t: 0161 973 4955  
e: sale@hibberthomes.com  
www.hibberthomes.com

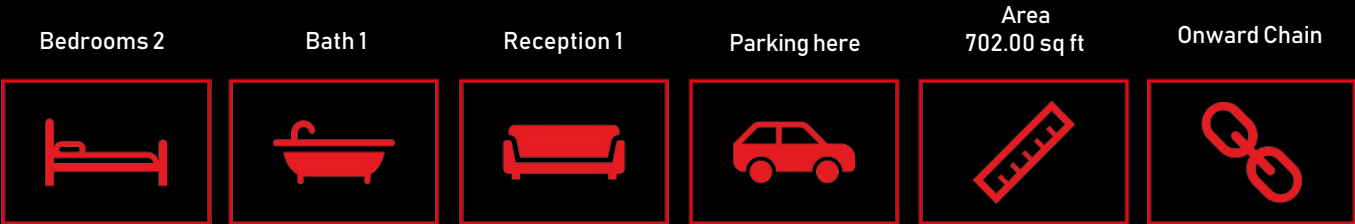



- Immaculate Modern Two Bedroom Semi Detached Home
- Conveniently Located Within Close Proximity To Retail Park
- Private Rear Garden
- Buy To Let Opportunity
- Easy Access To The Metro Link
- Modern Kitchen and Bathroom
- Ideal For A First Time Buyer
- Viewing Highly Recommended

This delightful modern semi-detached home presents an excellent opportunity for first-time buyers. or a buy to let investor. The property has been finished to a high standard throughout by the current vendors. The property is situated within a cul de sac location and close to the metro link which allows easy access to and from the city centre. The property is also close to the retail park, which has an array of shops, and the property is also close to Sale town centre.

The property comprises: entrance hall, living room, kitchen/dining room and conservatory. The first floor has a landing, two bedrooms and a bathroom. Externally, the property has a front and rear garden. To the rear there is a patio area, lawn and fenced boundaries.

A viewing is highly recommended!

