

Approx Gross Floor Area = 891 Sq. Feet

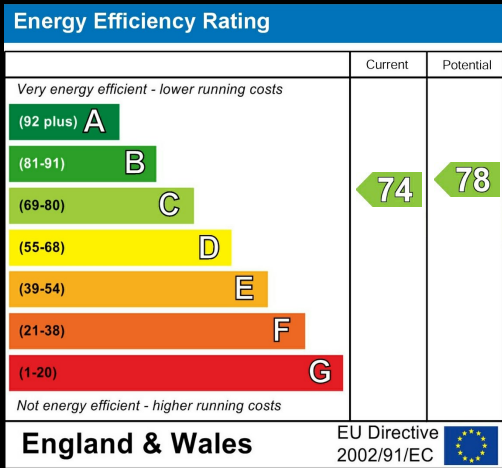

Buxton Crescent |  
Guide Price £200,000

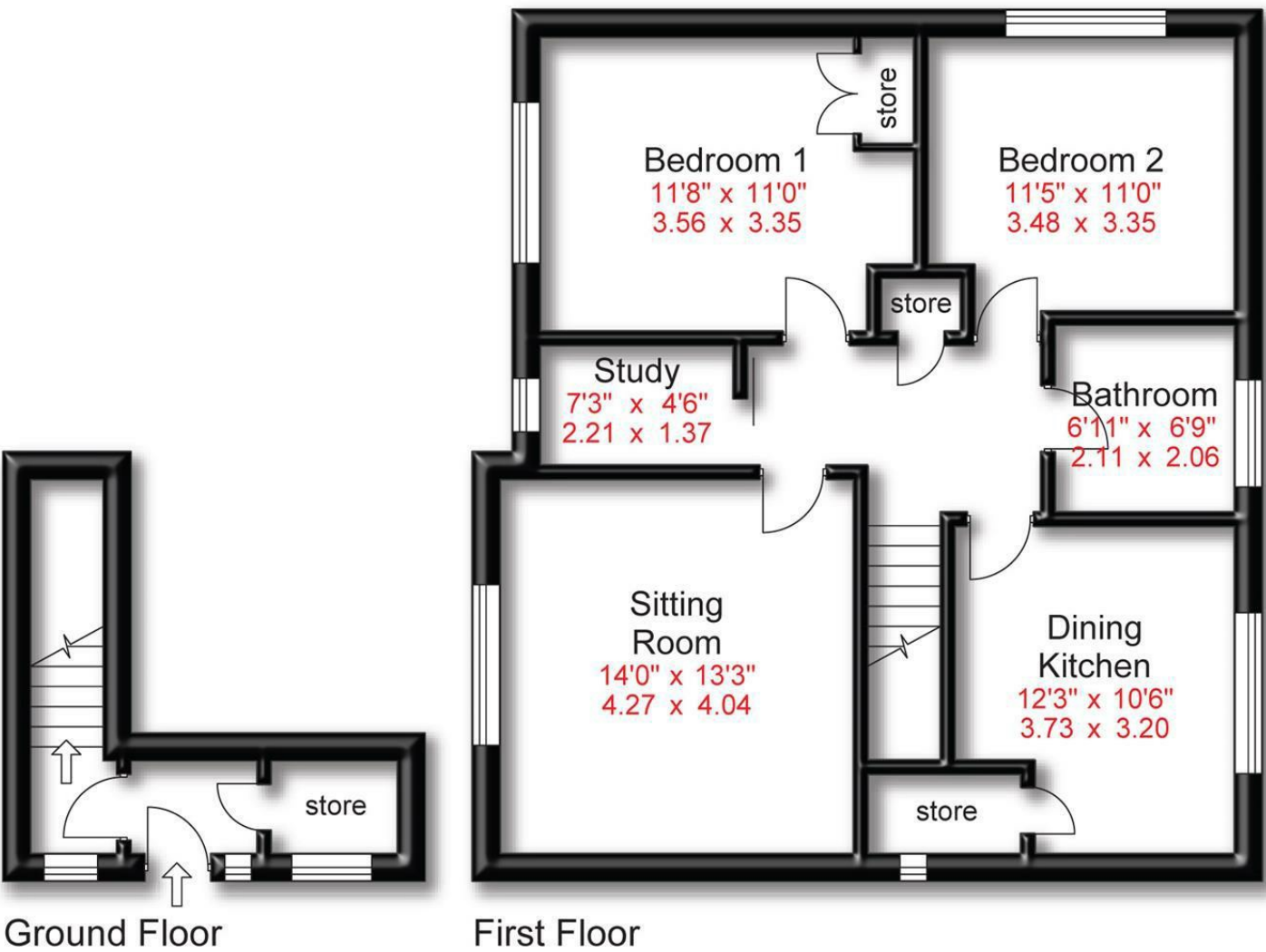

**HIBBERT  
HOMES**

SALES & LETTINGS

88 School Road | Sale | M33 7XB  
t: 0161 973 4955  
e: sale@hibberthomes.com  
www.hibberthomes.com

Bedrooms 3

Bath 1

Reception 1

Parking here

Area 0.00 sq ft

Type here



- No Chain
- Three Bedrooms
- Ideal For First Time Buyers
- Buy To Let Opportunity

- First Floor Apartment
- Close Proximity To The Tram Stop
- Excellent Transport Links
- Shared Garden

**\*\* NO ONWARD CHAIN \*\***

Hibbert Homes are proud to present this first floor three bedroom apartment with a garden. The property is an ideal for a first time buyers or a buy to let investor. Situated within close proximity to the Metrolink as well as the local shops and schools and easy access to the motorway.

Benefiting from its own private entrance the property comprises; entrance hall which has a large storage cupboard and stairs leading to the first floor, once on the hallway there is access to all of the rooms which include the living room, kitchen, bathroom and three bedrooms. Externally you have a front garden and shared garden to the rear.

