

Approx Gross Floor Area = 1184 Sq. Feet

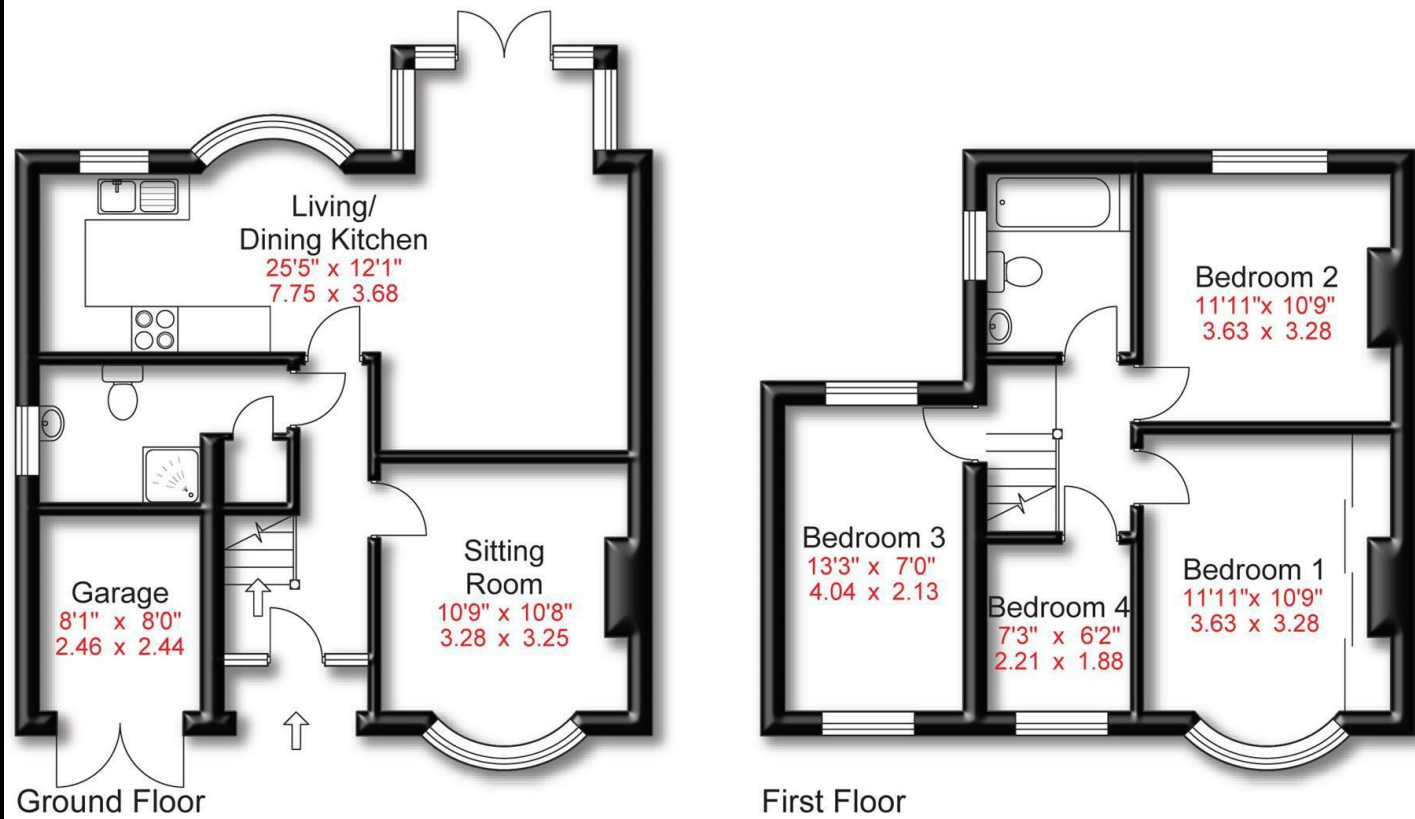

Energy Efficiency Rating		
	Current	Potential
Very energy efficient - lower running costs		
(92 plus) A		
(81-91) B		
(69-80) C		
(55-68) D	65	77
(39-54) E		
(21-38) F		
(1-20) G		
Not energy efficient - higher running costs		
England & Wales	EU Directive 2002/91/EC	



Walton Road |
Offers Over £575,000



88 School Road | Sale | M33 7XB
t: 0161 973 4955
e: sale@hibberthomes.com
www.hibberthomes.com

Bedrooms 4	Bath 2	Reception 2	Parking here	Area sq ft	Type here

- Four Bedroom Extended Semi Detached
- South Facing Garden
- Highly Sought After Location
- Close To Local Schools
- Off Road Parking For Multiple Cars
- Close Sale Town Centre
- Two Bathrooms

Hibbert Homes are proud to present this four bedroom extended semi detached property located within the popular area of Sale. The property is close to Sale town centre and the metro link and the motorway links which makes it ideal for getting to and from the City Centre. The property is a perfect family home ideal for somebody looking to upsize to there forever home. Close to the local schools and parks a viewing is highly recommended.

The property comprises; Entrance hall, living room, downstairs shower room and W/C, open plan kitchen and dining room. The second floor has four bedrooms and bathroom. To the front of the property there is a double driveway, access to the garage and a side gate with access to the garden. To the rear of property there is a split level garden with a patio area and lawn and then to the rear a decked area. The property is south facing so ideal for those summer nights.

