



Somerton Drive, Hatfield Woodhouse, Doncaster



3



1



2

OIRO £269,000

- Stunning modern kitchen
- Luxurious four piece bathroom
- Large formal dining room
- Gorgeous Lounge with feature fire and surround
- Three Double Bedrooms
- Study on landing area
- Freehold
- EPC rating C



I am thrilled to present for sale this immaculate, detached house, nestled in a serene semi-rural location. This fantastic property has been extended to the ground floor and sits on a large plot, ideal for families seeking a peaceful yet engaging lifestyle.

The property boasts three spacious double bedrooms, two of which feature built-in wardrobes, providing ample storage space. The spacious landing is currently used as a study area. The luxurious four-piece bathroom offers a sanctuary for relaxation and rejuvenation after a long day. The double walk in shower cubicle has jets.

The heart of this home is undoubtedly the contemporary kitchen, designed to accommodate all your culinary adventures. Complementing this, you'll find two reception rooms - a cosy front-facing room with a warm, inviting fireplace, and a formal dining room, perfect for entertaining guests or enjoying family meals.



One of the standout features of this property is the South East facing rear garden. It's a well-stocked paradise with an Indian stone patio, perfect for alfresco dining or simply soaking up the sun. The property also includes the added benefit of ample parking and a garage, catering to all your vehicular needs.

The house falls within the catchment area of an excellent primary school, making it perfect for families with young children. And if you love the great outdoors, you're in for a treat with stunning walks right on your doorstep.

This property is rated C for both EPC and Council tax band. So, if you're looking for a perfect balance between comfort, convenience, and nature, this could be your dream home. Don't miss out on this incredible opportunity.

Porch

Entrance Hallway

Dining Room 6.76m x 2.83m (22'2" x 9'4")

Inner Hallway

Kitchen 3.01m x 2.71m (9'11" x 8'11")



Lounge 3.71m x 4.81m (12'2" x 15'10")

Stairs/landing (study Area)

Bedroom One 2.88m x 3.7m (9'5" x 12'1")

Bedroom Two 3.84m x 2.55m (12'7" x 8'5")

Bedroom Three 3.04m x 2.88m (10'0" x 9'5")

WC

Garage and Exterior





Disclaimer

Disclaimer These details are intended to give a fair description only and their accuracy cannot be guaranteed nor are any floor plans (if included) exactly to scale. These details do not constitute part of any offer or contract and are not to be relied upon as statements of representation or fact. Intended purchasers are advised to recheck all measurements before committing to any expense and to verify the legal title of the property from their legal representative. Any contents shown in the images contained within these particulars will not be included in the sale unless otherwise stated or following individual negotiations with the vendor. Northwood have not tested any apparatus, equipment, fixtures or services so cannot confirm that they are in working order and the property is sold on this basis.

AML

Should you wish to make an offer on this property we will complete mandatory Anti Money Laundering (AML) checks on behalf of HMRC. We outsource this process to our partners, Goto. Goto charge a fee for this service.



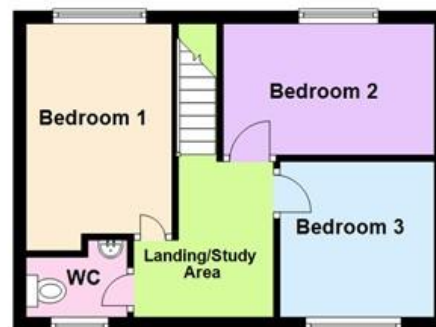



Northwood Doncaster

01302767000

doncaster@northwooduk.com