



Pastures Grove, Hatfield Woodhouse, Doncaster



3



2



2

OIRO £300,000

- CHARMING DORMER BUNGALOV
- GREAT SCHOOL CATCHMENT
- PRESTIGIOUS LOCATION
- SOUTH FACING GARDEN
- NO CHAIN!
- TUCKED AWAY IN THE HEART OF THE VILLAGE
- SHORT STROLL TO SCHOOL & VILLAGE HALL
- DETACHED GARAGE & DRIVEWAY PARKING
- ENERGY EFFICIENT - EPC rating B



WHETHER YOU ARE LOOKING TO UPSIZE YOUR FAMILY OR DOWNSIZE WITHOUT COMPROMISE THEN LOOK NO FURTHER

** ESCAPE THE RAT RACE FOR A PEACEFUL VILLAGE LIFE **** GREAT LOCAL COMMUNITY AND FANTASTIC NEARBY AMENITIES.

VILLAGE HALL, PLAYGROUND, SCHOOL AND METHODIST CHURCH WITHIN EASY WALKING DISTANCE.

BEAUTIFUL WALKS AROUND THE VILLAGE AND ONTO THE HATFIELD MOORS NATURE RESERVE....

This BEAUTIFUL dormer bungalow was built by a well-regarded local builder in 2017 in an



exclusive cul-de-sac. It is accessed via a light and welcoming entrance hallway.

The lounge and dining room boast versatility with fitted sliding doors to separate the two rooms if required. Patio doors lead out onto the lovely south facing garden.

The kitchen is a contemporary shaker style.

A double bedroom with fitted wardrobes and a full bathroom with bath complete the ground floor.

Up to the first floor there are two further large double bedrooms, flooded with light from dormer and Velux windows, and a second bathroom which has a shower cubicle

Outside you will have your own driveway with ample parking space and a detached garage. The well presented rear garden is SOUTH FACING.

NO CHAIN!

ALARMED AND MOVE IN READY!!!!

ENTRANCE HALLWAY

LOUNGE 3.29m x 3.53m (10'10" x 11'7")



northwood



northwood

DINING AREA 2.97m x 3.53m (9'8" x 11'7")

KITCHEN 3.54m x 2.97m (11'7" x 9'8")

BATHROOM ONE 1.98m x 2.46m (6'6" x 8'1")

MASTER BEDROOM 3.29m x 3.54m (10'10" x 11'7")

BEDROOM TWO 3.78m x 4.69m (12'5" x 15'5")

BEDROOM THREE 4.32m x 3.59m (14'2" x 11'10")

BATHROOM TWO 1.98m x 1.76m (6'6" x 5'10")





DISCLAIMER

Disclaimer These details are intended to give a fair description only and their accuracy cannot be guaranteed nor are any floor plans (if included) exactly to scale. These details do not constitute part of any offer or contract and are not to be relied upon as statements of representation or fact. Intended purchasers are advised to recheck all measurements before committing to any expense and to verify the legal title of the property from their legal representative. Any contents shown in the images contained within these particulars will not be included in the sale unless otherwise stated or following individual negotiations with the vendor. Northwood have not tested any apparatus, equipment, fixtures or services so cannot confirm that they are in working order and the property is sold on this basis.



Ground Floor



First Floor

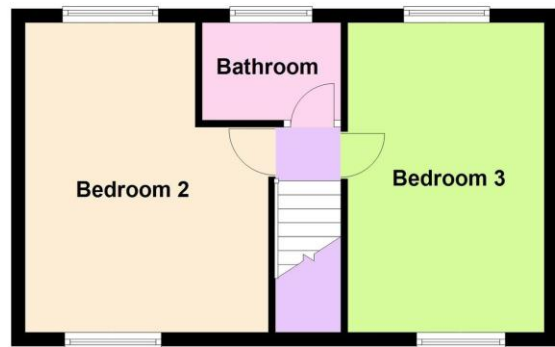

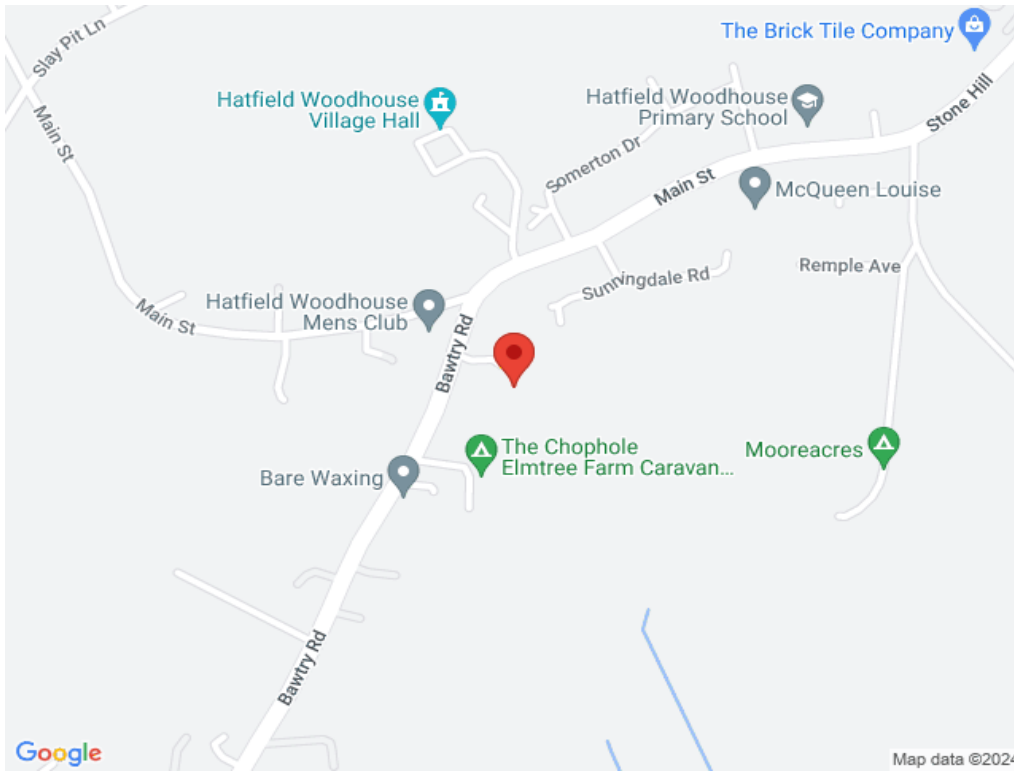

Northwood Doncaster

01302 279196

hatfield@northwooduk.com