



Chapman Close

Snodland ME6 5QZ

£400,000



COUNTRY HOMES

Snodland ME6 5QZ

This modern, mid terrace house offers an open plan lounge/dining area, separate kitchen and downstairs W.C. Heading through the patio doors lies the rear grassed garden, with separate back gate heading out the property. This property has a driveway for two cars as well as a generous amount of visitor bays nearby.

The first floor features 3 good size bedrooms, the master having an EN-SUITE, and a separate family bathroom with a bath and shower.

This delightful property is ideally located for those needing to commute, as Snodland offers a train station with a direct route into London and there are easy links to the M2 and M20, but is situated in a modern concept living development set around the Lakes. A "Good" ofsted rated school within walking distance makes it the perfect family home!

A beautiful property where early viewing is highly recommended to appreciate all it has to offer.

Call now to arrange a viewing!



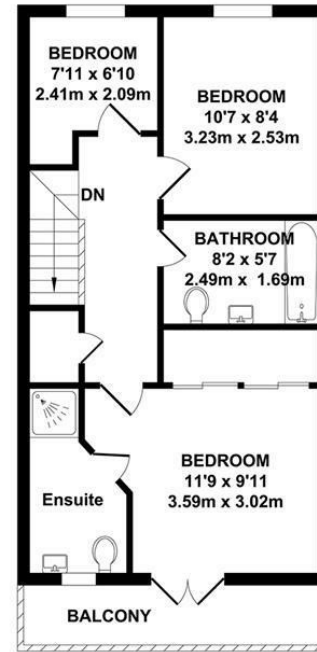
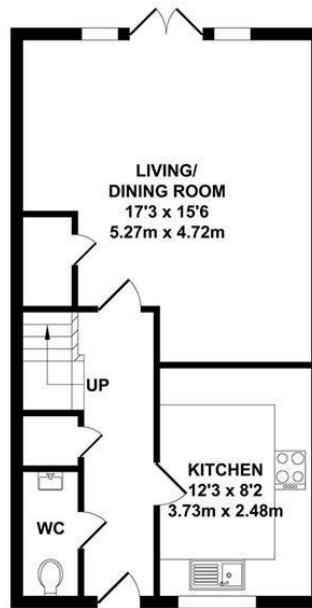

GROUND FLOOR
APPROX. FLOOR AREA
462 SQ.FT.
(42.95 SQ.M.)

FIRST FLOOR
APPROX. FLOOR AREA
462 SQ.FT.
(42.95 SQ.M.)

TOTAL APPROX. FLOOR AREA 925 SQ.FT. (85.90 SQ.M.)

Whilst every attempt has been made to ensure the accuracy of the floor plan contained here, measurements of doors, windows, rooms and any other items are approximate and no responsibility is taken for any error, omission or mis-statement. This plan is for illustrative purposes only and should be used as such by any prospective purchaser. The services, systems and appliances shown have not been tested and no guarantee as to their operability or efficiency can be given.
Zome Media ©2024

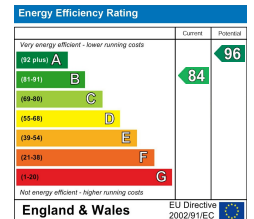

Unit 2 Mid Kent Shopping Centre, Allington, Kent ME16 0PR
01622 94 22 22
allington@khp.me





Location Map

Tenure: Freehold

Council tax band: D

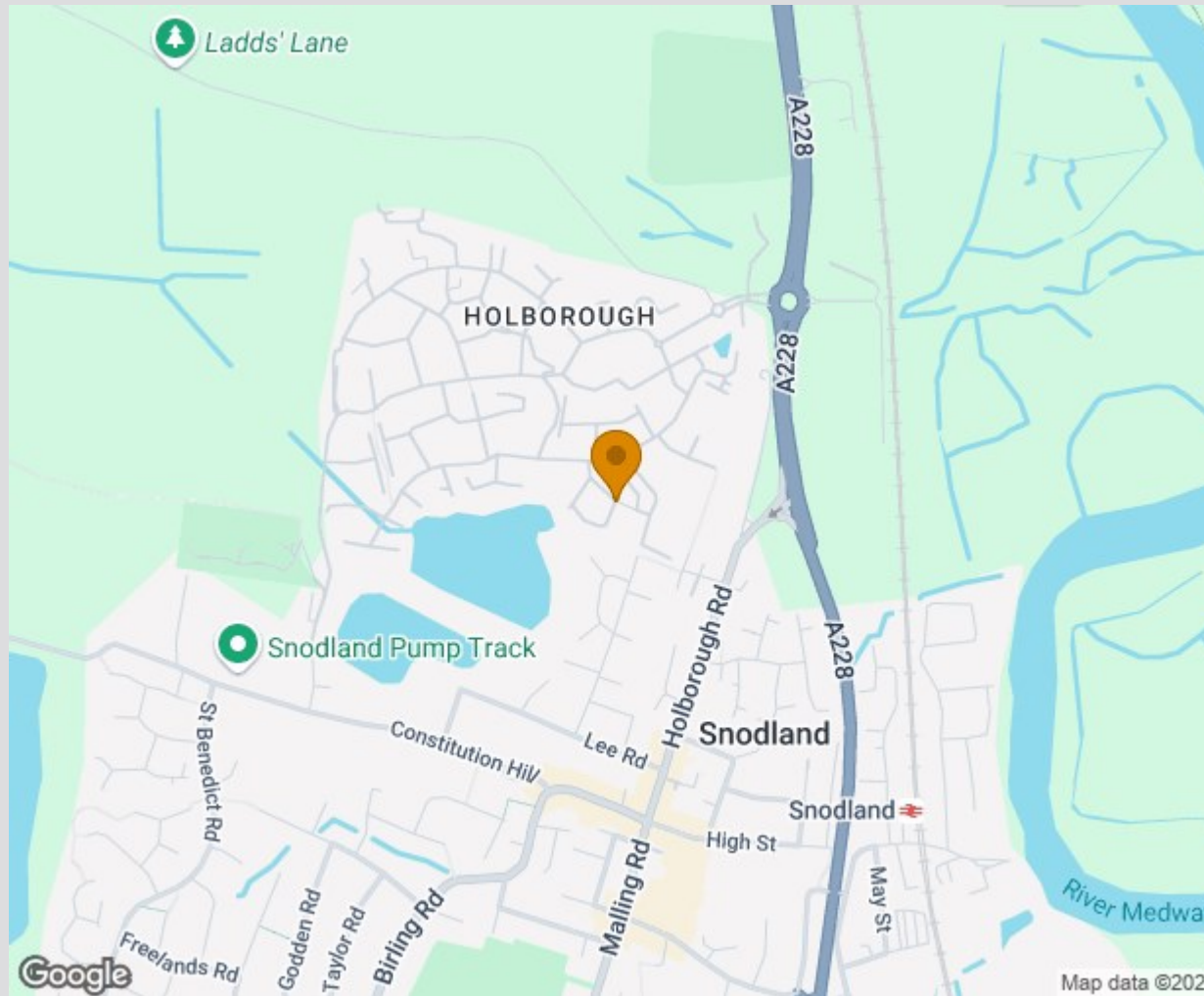

TO VIEW CONTACT: 01622 94 22 22 allington@khp.me

www.khp.me



Zoopla.co.uk
Smarter property search

