

GROUND FLOOR
APPROX. FLOOR AREA
673 SQ.FT.
(62.49 SQ.M.)

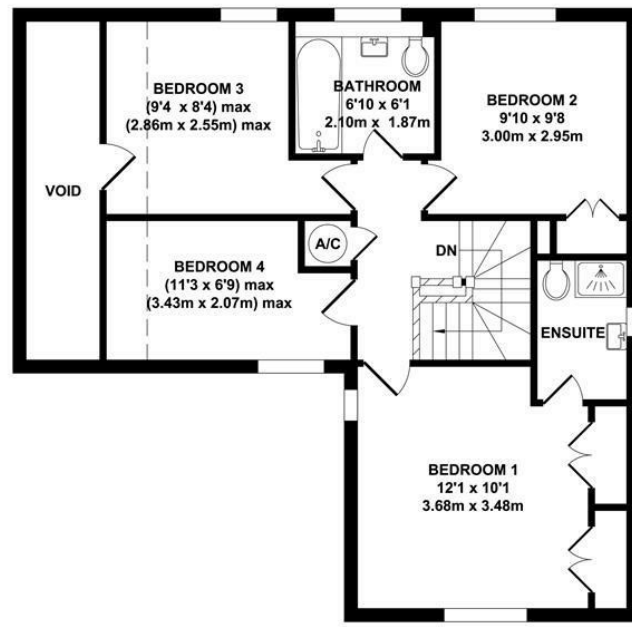

FIRST FLOOR
APPROX. FLOOR AREA
596 SQ.FT.
(55.35 SQ.M.)

TOTAL APPROX. FLOOR AREA 1268 SQ.FT. (117.84 SQ.M.)

Whilst every attempt has been made to ensure the accuracy of the floor plan contained here, measurements of doors, windows, rooms and any other items are approximate and no responsibility is taken for any error, omission or mis-statement. This plan is for illustrative purposes only and should be used as such by any prospective purchaser. The services, systems and appliances shown have not been tested and no guarantee as to their operability or efficiency can be given.
Zome Media ©2024



01622 942 222
allington@khp.me



Gainsborough Drive
Maidstone ME16 0UZ
Offers Over £565,000

Tenure: Freehold

Council tax band: E



Welcome to your dream home in the heart of Allington! This stunning 4 bedroom detached house offers a perfect blend of a pleasant design and comfort over two floors.

Located in the sought-after area of Allington, this property boasts a tasteful interior and the perfect family home!

It has four bedrooms upstairs as well as a family bathroom. The main bedroom has a ensuite with shower. It has a kitchen and dining room, as well as a separate sitting room. The driveway provides space for several cars, leading to the garage. The large secluded garden has a patio area and large grassed area.

Don't miss out on this opportunity

- 4 bedroom detached
- Large driveway provides space for several cars
- Large secluded garden
- Easy access to the M20
- Garage
- Located in the sought-after area of Allington
- Separate sitting room

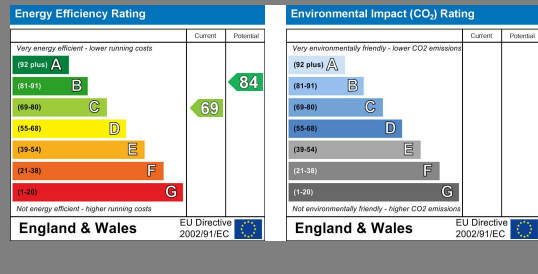

LOCAL INFORMATION FOR ALLINGTON

Allington ensures easy access to the M20, walking distance from Maidstone hospital, and Barming train station, which takes you directly into London Victoria, Bus routes which offers a direct bus route into Maidstone town centre and Mid Kent shopping Centre. The shopping centre is also in walking distance, which provides a hairdressers, Waitrose, Post office, Chemist and a café. There is a large recreational ground close by with a park and tennis courts. Close by to the local Pre - School, Primary and secondary schools as well to Mid Kent college. This all adds to the appeal of this popular location!

ADDITIONAL INFORMATION

Freehold
Council Tax Band E
EPC Rating C

DISCLAIMER

All dimensions are approximate and any floor plans are for guidance purposes only. Reference to appliances and/or services does not imply that they are necessarily in working order. Whilst we endeavor to make our sales particulars as accurate as possible, all interested parties must verify their accuracy themselves.

