



Woodlands Road

Aylesford ME20 7QG

£625,000



COUNTRY HOMES

Aylesford ME20 7QG

Superb 4 bed detached family home set in the highly sought-after Holtwood area.

This beautiful home has been much improved and modernised by the current owners and boasts a large living room overlooking the rear garden. There is a separate dining room, in addition to a lovely conservatory, kitchen with separate utility room plus downstairs cloakroom/WC.

Upstairs are four generous size bedrooms, the master with en-suite and fitted wardrobes and a contemporary family bathroom.

Externally and to the rear is a well-established garden with pond and patio area. To the front of the property is a large driveway with parking for several cars, in addition to the garage and car port to the side.

Situated in a highly desirable location, with easy access to the M20 and within close proximity to shops and schools, this is one property you certainly won't want to miss out on. Call us now to secure your viewing.

- Large detached family home
- En-suite to master bedroom
- 4 good size bedrooms
- Generous living room
- Separate dining room
- Conservatory
- Kitchen & separate utility
- Contemporary bathroom
- Large driveway plus garage
- Excellent transport links



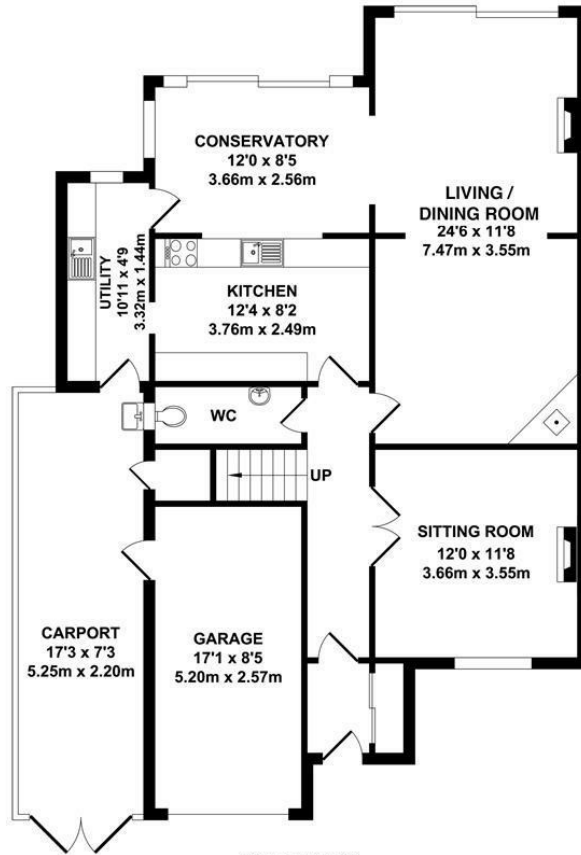

GROUND FLOOR
APPROX. FLOOR AREA
1008 SQ. FT.
(93.67 SQ. M)



FIRST FLOOR
APPROX. FLOOR AREA
586 SQ. FT.
(54.46 SQ. M)

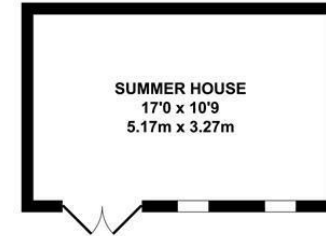

OUTBUILDING
APPROX. FLOOR AREA
182 SQ. FT.
(16.91 SQ. M)

TOTAL APPROX. FLOOR AREA 1776 SQ.FT. (165.04 SQ.M.)

Whilst every attempt has been made to ensure the accuracy of the floor plan contained here, measurements of doors, windows, rooms and any other items are approximate and no responsibility is taken for any error, omission or misstatement. This plan is for illustrative purposes only and should be used as such by any prospective purchaser. The services, systems and appliances shown have not been tested and no guarantee as to their operability or efficiency can be given.

Zome Media ©2024

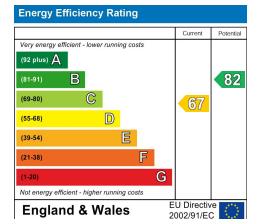





Location Map

Tenure: Freehold

Council tax band: E



TO VIEW CONTACT: 01622 94 22 22 allington@khp.me

www.khp.me

