



# Ash Grove

Allington ME16 0AD

£510,000



COUNTRY HOMES

## Allington ME16 0AD

Are you looking for a versatile detached good size family home in the ever popular area of Allington? This Chalet style property has been extended and converted and as you can see from the floorplan is currently configured as 5 bedrooms, with 2 being downstairs, and with a 2nd kitchen area this could easily be used as an annexed living area. If however you wanted to use these rooms as further receptions, a study or separate dining room, the option is there.

There are 3 bedrooms and a family bathroom to the first floor, making this property ideal for the family, particularly as the well respected primary school is a short walk away.

Well presented by the current owner internally, externally the low maintenance garden to the rear offers good entertaining space and there is access to a larger than normal garage and store room which provides further potential. To the front there is an attractive garden with drive to the side leading to a gated secure parking area and the garage.

A short walk to the amenities in Allington including Waitrose and a short drive to the M20 and Barming train station, this property is worthy of your internal viewing, call today to arrange yours.

- Detached
- Chalet style
- 5 versatile bedrooms
- Annexe potential
- Bathrooms on both floors
- Secure parking and garage
- Popular location
- Attractive rear garden
- Over 1800 sq ft total
- Viewing encouraged



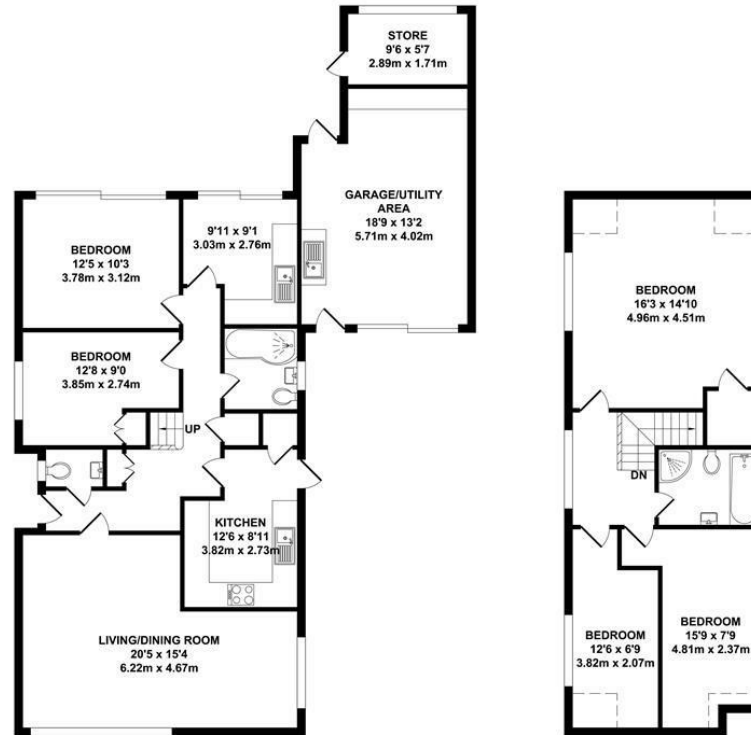

GROUND FLOOR  
APPROX. FLOOR AREA  
1192 SQ.FT.  
(110.76 SQ.M.)

FIRST FLOOR  
APPROX. FLOOR AREA  
615 SQ.FT.  
(57.18 SQ.M.)

**TOTAL APPROX. FLOOR AREA 1808 SQ.FT. (167.94 SQ.M.)**

Whilst every attempt has been made to ensure the accuracy of the floor plan contained here, measurements of doors, windows, rooms and any other items are approximate and no responsibility is taken for any error, omission or mis-statement. This plan is for illustrative purposes only and should be used as such by any prospective purchaser. The services, systems and appliances shown have not been tested and no guarantee as to their operability or efficiency can be given.

Zome Media ©2023

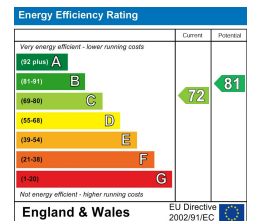





## Location Map

Tenure: Freehold

Council tax band: E

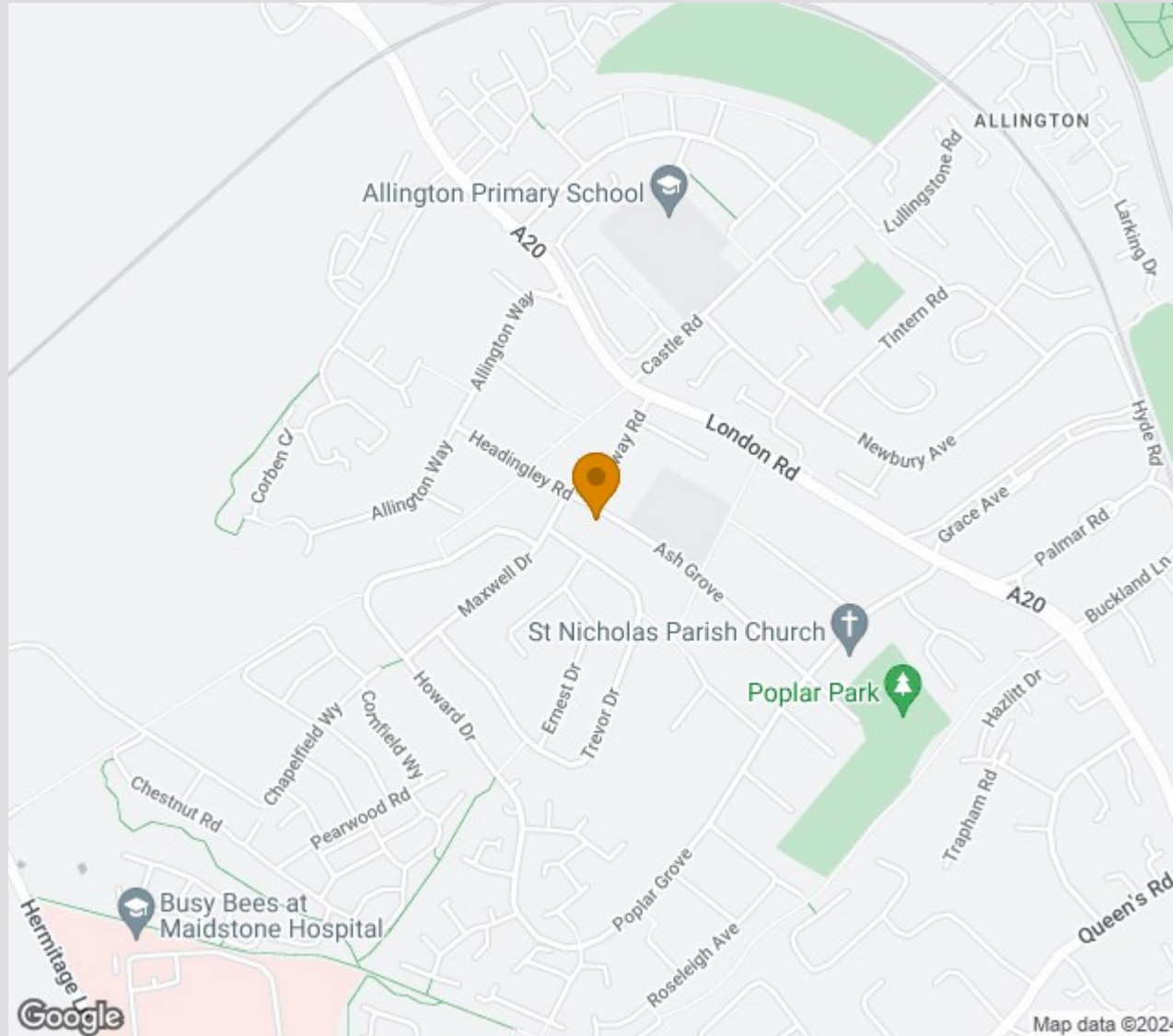

TO VIEW CONTACT:

01622 942 222

countryhomes@khp.me

www.khp.me

