



Sutton Court Road, Sutton

£1,425 Per Month





Ralph James presents a modern 3rd floor apartment with one double bedroom, a spacious living room with rooflight windows, and a well-equipped kitchen. Conveniently located near Sutton's mainline station and town centre.





Ralph James is thrilled to present this contemporary 3rd floor apartment boasting one generous double bedroom. Upon entering the residence, the hallway seamlessly guides you into the expansive living room adorned with rooflight windows, ensuring an abundance of natural light. The modern open-plan layout encompasses a well-equipped kitchen with modern appliances, including a washer/dryer and fridge/freezer. Secure allocated parking and a video entry system are additional perks of this property.

Nouvelle House distinguishes itself as one of Sutton's premier and most conveniently located residential developments. Its proximity to the mainline station, just a short walk away, facilitates a swift journey to Victoria in under 30 minutes. The town center, boasting a plethora of renowned restaurant chains, coffee shops, the St. Nicholas shopping center, and a cinema, further enhances the appeal of this residence.

Please take note that the provided photos serve as a representation of the development's style and finish and may not depict the actual flat. While the floorplan accurately reflects the available flat, the dimensions are approximate and should not be solely relied upon as factual statements.

Need to know

- Modern apartment one spacious double bedroom
- The property features a well-lit living room with rooflight windows, creating a bright and inviting atmosphere
- A contemporary open-plan design includes a fully-equipped kitchen with modern appliances, such as a washer/dryer and fridge/freezer
- The master bedroom comes complete with built-in wardrobes.
- Secure allocated parking and a video entry system enhance the property's safety and accessibility
- Nouvelle House stands out as one of Sutton's premier residential developments, offering convenience with a short walk to the mainline station
- Quick access to Victoria in under 30 minutes makes the location highly desirable for commuters
- The town center, in close proximity, provides a diverse array of dining options, coffee shops, the St. Nicholas shopping center, and a cinema for entertainment
- EPC: C
- Council tax: B

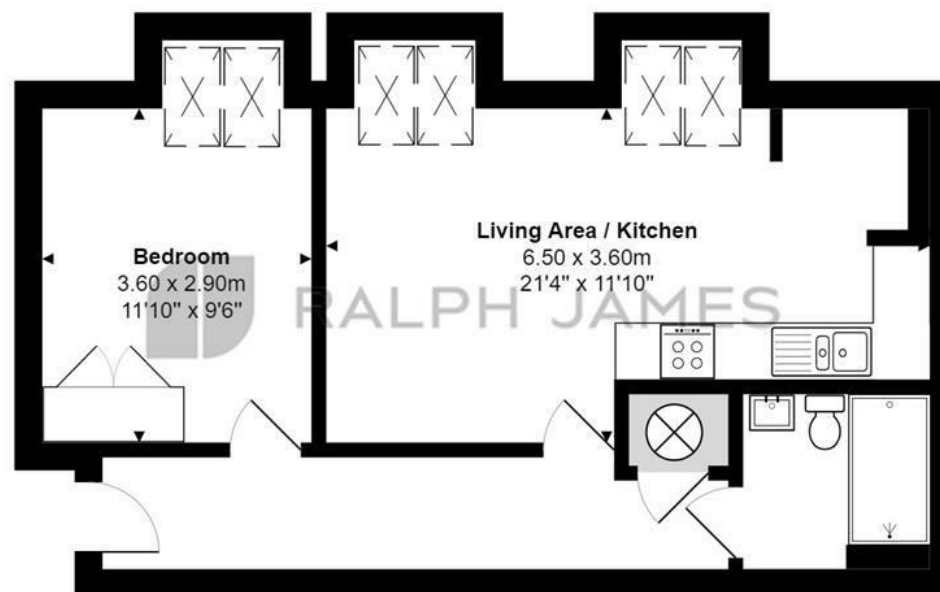

Third Floor

Nouvelle House, Sutton Court Road, Sutton

FOR ILLUSTRATIVE PURPOSES ONLY.

Whilst every attempt has been made to ensure the accuracy of the floor plan shown, all measurements, positioning, fixtures, features, fittings and any other data shown are an approximate interpretation for illustrative purposes only and are not to scale.

No responsibility is taken for any error, omission, miss-statement or use of data shown.

The above statement applies to both 'Still Moving London LTD' and the Company or individual displaying this floor plan.

Unauthorised reproduction prohibited.

Â© Still Moving London LTD (www.stillmoving.london)

Interested?

banstead@ralphjames.co.uk
01737 371 700

#

ralphjames.co.uk

