



Copthill Lane, Tadworth

£1,695,000





“

A truly remarkable country residence in the popular village of Kingswood showcasing a spacious and historical home set within an exclusive and private positioning.

”



Dating back to 1850 when it once owned all of the surrounding land, The Grey House is a beautifully designed and furnished substantial family home, located in an exclusive and envious position within the popular village of Kingswood.

Boasting approaching 5000 square feet of accommodation, this truly remarkable home offers a tremendous amount of flexibility throughout, whilst also benefitting from the detached Forge, which is currently used as an air B & B but could be used for a number of purposes.

The house itself has five well proportioned bedrooms, four reception rooms, spacious kitchen dining room, a large cellar as well as an attached double garage. The accommodation however could be used in a number of different ways and tailored to any families needs, whilst having the seclusion and privacy we are all looking for.

In terms of location, Kingswood station is just a stones throw away, which boasts direct links to London. Other local amenities include the Kingswood arms pub, cafe's, restaurants, along with everyday essentials.



Need to know

- One of Kingswood's oldest historical homes dating back to 1850.
- A substantial five bedroom residence in an exclusive pocket of Kingswood.
- 0.35 acre plot containing The Forge currently used as an air B & B.
- Four spacious reception rooms offering flexible accommodation.
- Set over four floors as well as a useful cellar area.
- Beautifully maintained and original character features.
- Amazing countryside walks for miles across to Banstead and Burgh Heath.
- Attached double garage and private driveway.
- Stones throw away from local amenities including cafe's, restaurant's, and shops.
- Short walk to Kingswood mainline station with direct links to London.

Interested?

banstead@ralphjames.co.uk
01737 371 700

ralphjames.co.uk

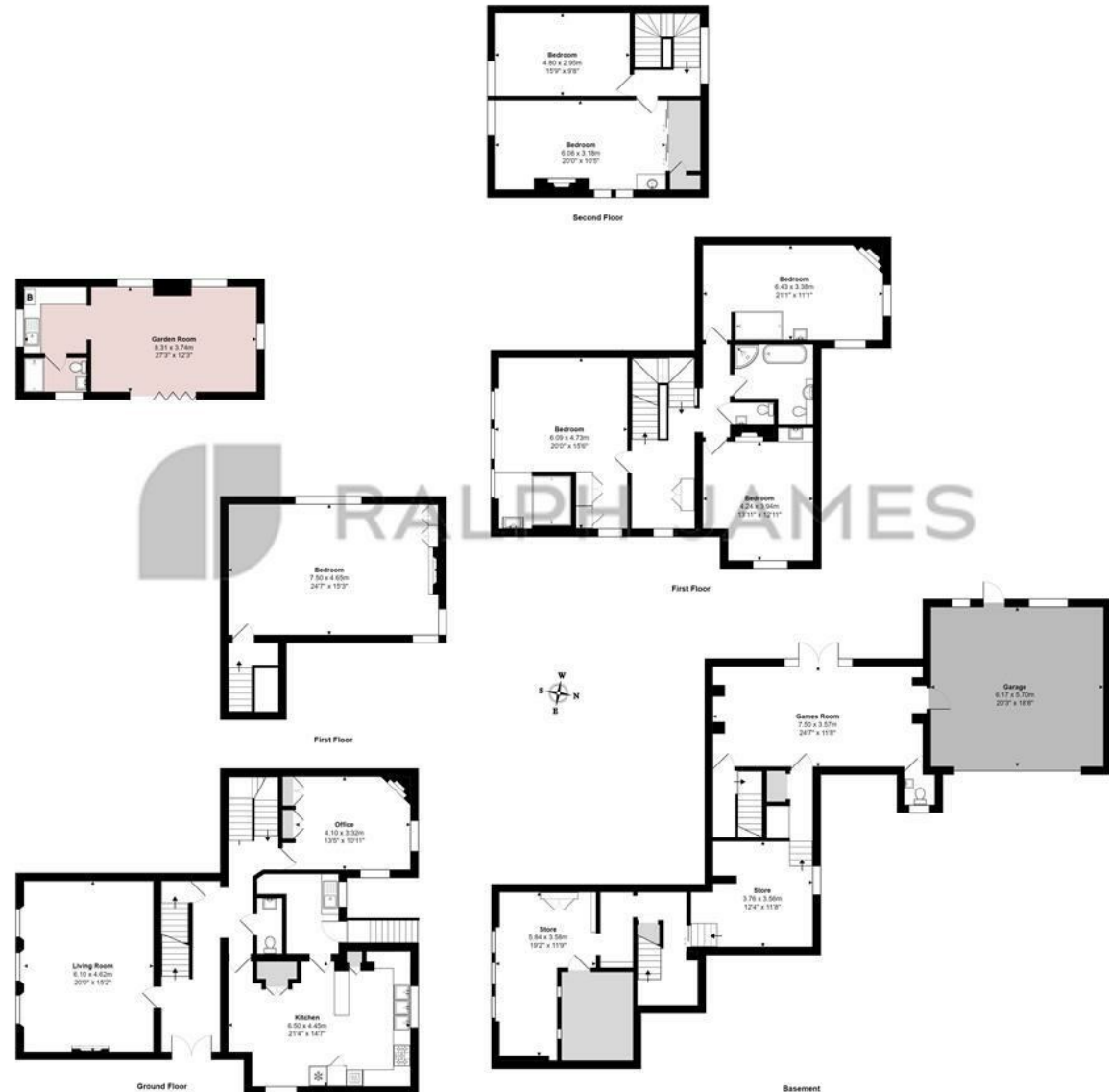

Copthill Lane, Kingswood
Total Area: 417.4 m² ... 4493 ft² (excluding garden room)
FOR ILLUSTRATIVE PURPOSES ONLY

Whilst every attempt has been made to ensure the accuracy of the floor plan shown, all measurements, including, but not limited to, floor, ceiling, height and area, are approximate and should not be relied upon for any legal or financial purposes.

No responsibility is taken for any error, omission, mis-statement or use of data shown.

The above statement applies to both RHP Moving London LTD and the Company or individual displaying this floor plan.

Unauthorised reproduction prohibited.

© RHP Moving London LTD (see adjoining tenders)

RALPH JAMES