



Woodcote Valley Road, Purley

£344,500





If you're looking to retire to a quiet, leafy, residential suburb, but with quick and easy transport links into London, Medford House in Purley could well be the place for you.



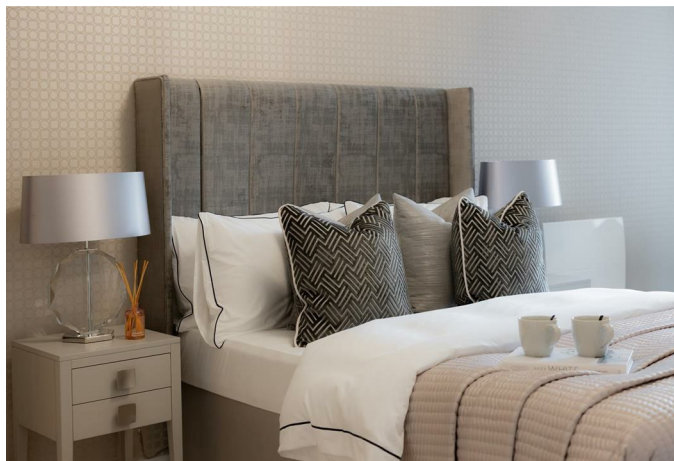
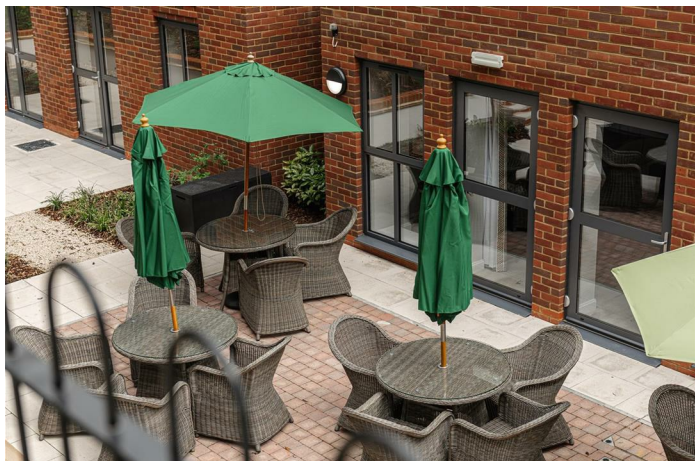

This Retirement Living development in Purley will feature just 29 apartments, reflecting the town's close-knit community feel. These 29 units will feature either two-bedrooms or one-bedroom, and some will have balconies overlooking the beautiful landscaped gardens. Homeowners will have full use of the club lounge, a tastefully designed space where you'll be able to catch up with neighbours and friends.

Property management and maintenance will be taken care of, as will water and sewerage rates. The House Manager will manage the development day-to-day and will be on hand during office hours and you'll have access to a 24-hour emergency call centre. There is a camera-entry system, and accessibility throughout with lifts to all floors.

Need to know

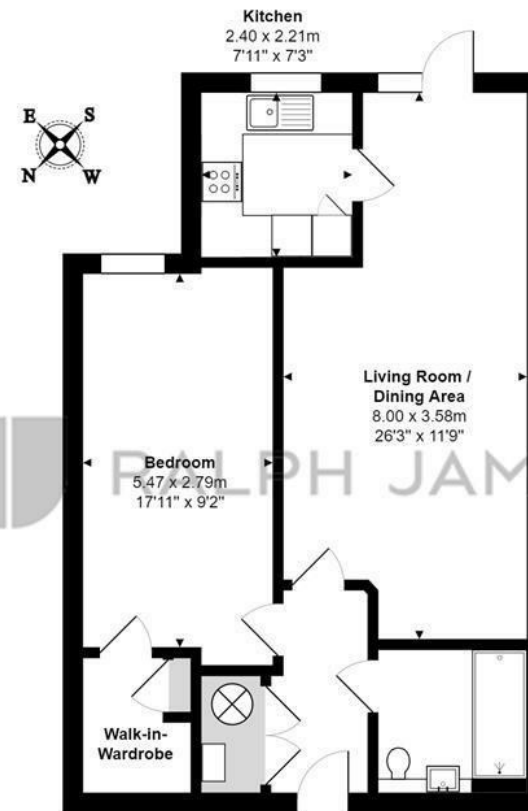

Ground Floor

Medford House, Woodcote Valley Road, Purley

Total Area: 62.3 m² ... 670 ft²

FOR ILLUSTRATIVE PURPOSES ONLY.

Whilst every attempt has been made to ensure the accuracy of the floor plan shown, all measurements, positioning, fixtures, features, fittings and any other data shown are an approximate interpretation for illustrative purposes only and are not to scale.

No responsibility is taken for any error, omission, miss-statement or use of data shown.

The above statement applies to both 'Still Moving London LTD' and the Company or individual displaying this floor plan.

Unauthorised reproduction prohibited.

© Still Moving London LTD (www.stillmoving.london)



Interested?

banstead@ralphjames.co.uk
01737 371 700

#

ralphjames.co.uk