

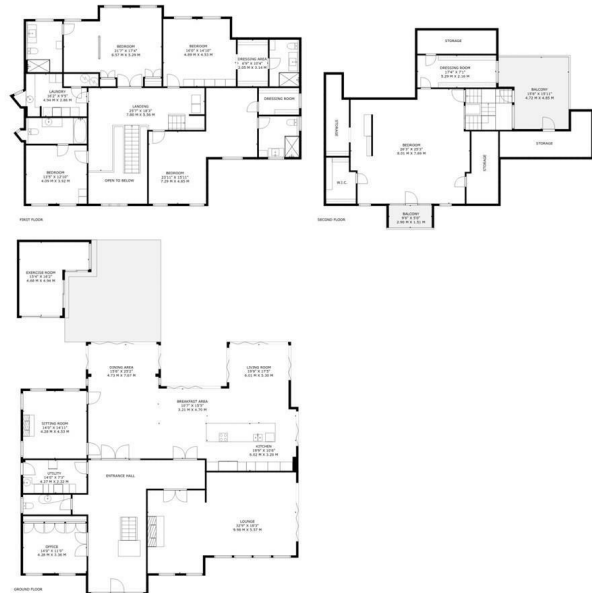

£3,000,000
Cricket Ground Road
Chislehurst, BR7 5HD

FINE & COUNTRY



GROSS INTERNAL AREA: 6030 sq ft, 560 m²
 LOW CEILINGS & OPEN TO BELOW: 358 sq ft, 34 m²
 BALCONIES: 261 sq ft, 24 m²

OVERALL TOTALS: 6649 sq ft, 618 m²

SIZES AND DIMENSIONS ARE APPROXIMATE, ACTUAL MAY VARY. FLOORS MAY NOT BE SHOWN IN THEIR ACTUAL LOCATION



5



5



4



Energy Efficiency Rating

	Current	Potential
Very energy efficient - lower running costs		
(92 plus) A		
(81-91) B		
(69-80) C		
(55-68) D		
(39-54) E		
(21-38) F		
(1-20) G		
Not energy efficient - higher running costs		
England & Wales	81	83
	EU Directive 2002/91/EC	



Agents Note: Whilst every care has been taken to prepare these particulars, they are for guidance purposes only. All measurements are approximate and are for general guidance purposes only and whilst every care has been taken to ensure their accuracy, they should not be relied upon and potential buyers/tenants are advised to recheck the measurements

FINE & COUNTRY

OFFICE ADDRESS
 47B Great Guildford Street
 London Bridge
 SE1 0ES

OFFICE DETAILS
 02076352063
 southeastlondon@fineandcountry.
<https://www.fineandcountry.co.uk>