



## Cutter Lane, SE10

£500,000

A luxurious one double bedrooms apartment with a private terrace and amazing views across the River Thames. The prestigious building is designed by by Design Haus Liberty, the interiors have been inspired by Greenwich Peninsula's unique water-flanked position on the Thames, overlooked from the private terrace.

Located a short walk from North Greenwich bus and tube station, adjacent to the IFS Cloud Cable Car and opposite North Greenwich Pier, transport links are readily available.

### Features

- Amazing River Views
- Access to Residents Roof Terraces
- 24 Hour Concierge
- Chain Free
- Gym
- Swimming Pool

Cutter Lane,  
London, SE10

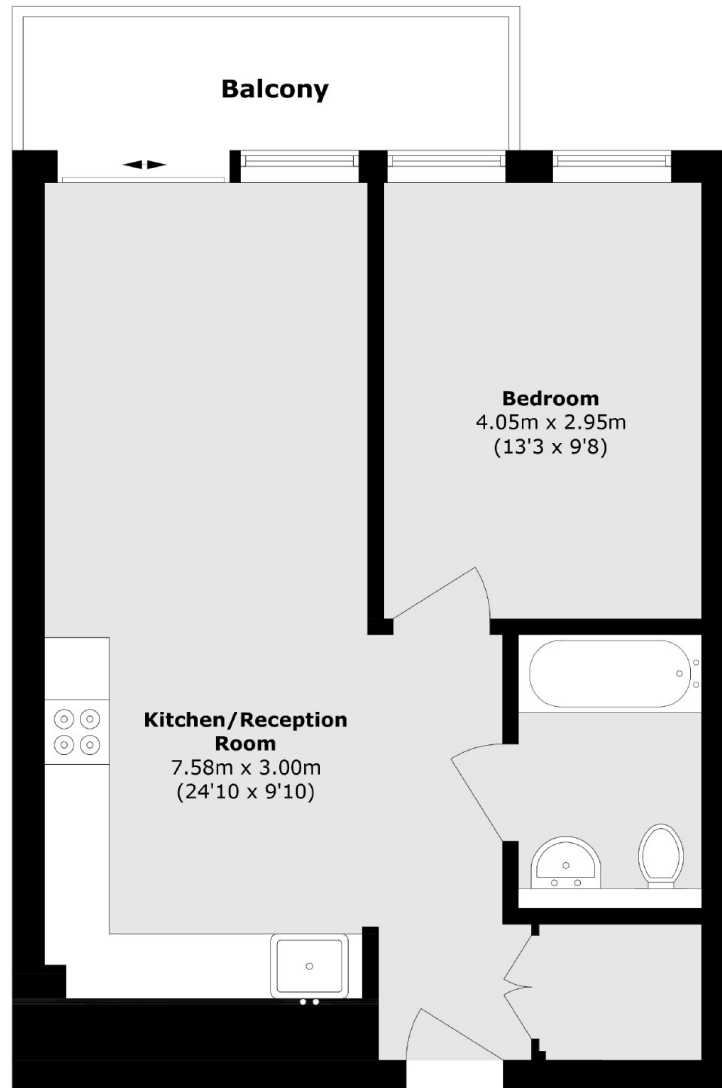

Total area (approx.): 49.7 sq. m (534.9 sq. ft)

Balcony area (approx.): 5.5 sq. m (59.2 sq. ft)