



## River Gardens Walk, SE10

### £550,000

A spacious and beautifully presented two-bedroom, two-bathroom apartment with a private west-facing balcony offering stunning river views. The apartment is one of the largest two-beds in the development, and enviably positioned in the block closest to Greenwich town centre. The balcony overlooks the Thames and treetops of Greenwich, perfect for sunset views. Inside, the apartment is filled with natural light and features a generous open-plan living area. Both bedrooms are doubles, with the large principal bedroom including an en-suite.

River Gardens is a vibrant community offering fantastic on-site amenities, including a concierge, gym, pool, and tennis court. You're moments from the Thames Path, Greenwich Park, and the historic town centre. Excellent transport links: 10 minutes to Cutty Sark DLR or Maze Hill station, with fast access to Canary Wharf, Bank, and London Bridge.

### Features

- Sought After Location
- Amazing City/ River View
- Storage Cage
- Tennis Courts And Gym
- Swimming Pool
- Private Balcony

River Gardens Walk,  
London, SE10

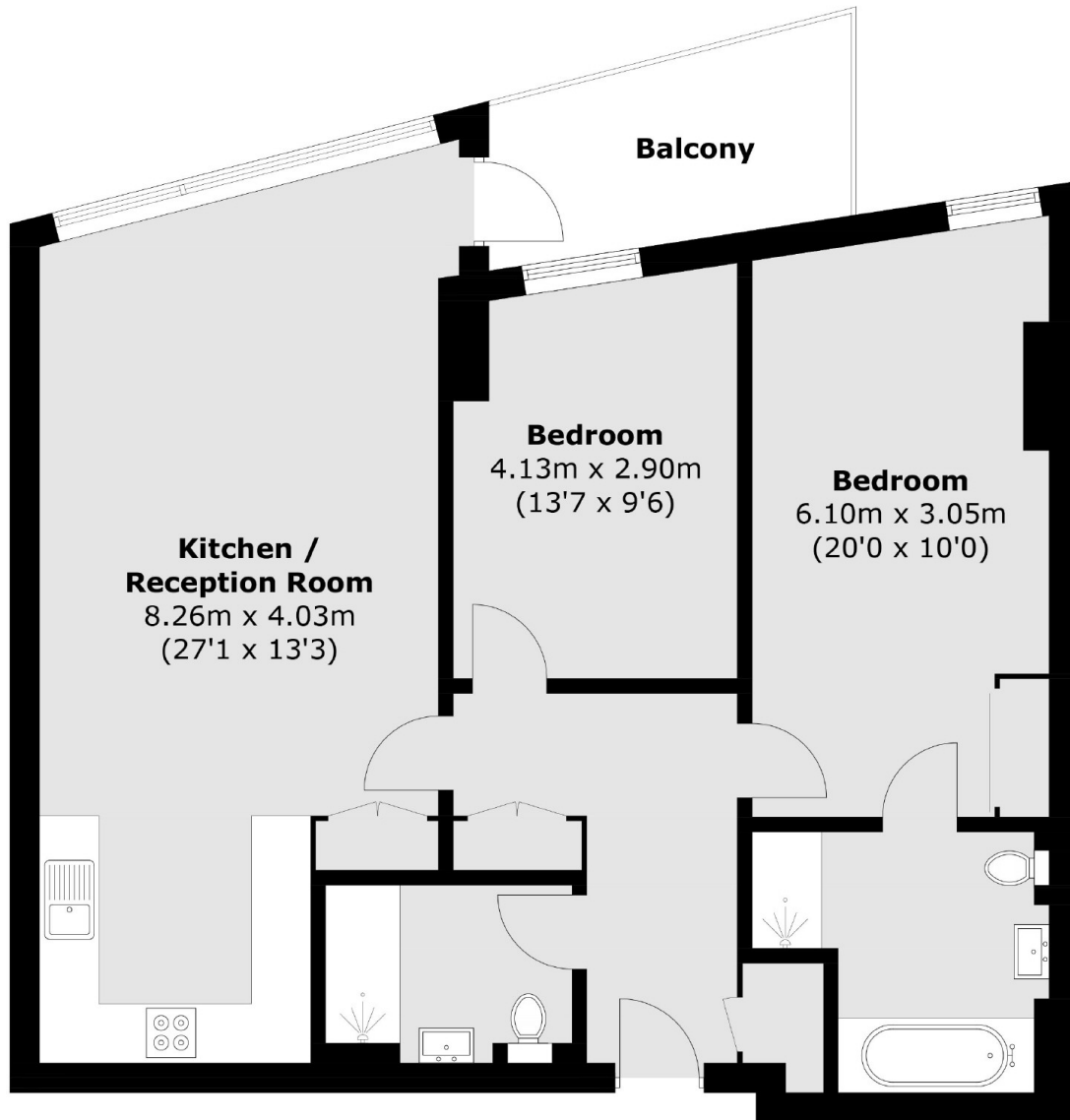

Total area (approx.): 86.8 sq. m (934.3 sq. ft)  
( Excluding Balcony)

**Dexters**

Greenwich  
275 Greenwich High Road  
Greenwich  
London  
Sales  
020 8815 2215

Energy Rating: B. We aim to make our particulars both accurate and reliable. However they are not guaranteed; nor do they form part of an offer or contract. If you require clarification on any points then please contact us, especially if you're traveling some distance to view. Please note that appliances and heating systems have not been tested and therefore no warranties can be given as to their good working order.

 **RICS** | Regulated  
Estate Agent  
and Letting Agent

[dexters.co.uk](https://www.dexters.co.uk)