



Whitworth Street, SE10

£825,000

A beautifully presented two bedroom double fronted period home with a modern interior, located on a quiet road moments from Maze Hill Station. Presented in good condition, the property benefits from a great sized garden and potential to extend STPP.

Whitworth Street is a quiet residential street located a short walk from Maze Hill Mainline Station providing direct links to London Bridge, Cannon Street and St Pancras. Greenwich Park is located nearby as are the many historical attractions of Greenwich including the National Maritime Museum, Royal Observatory and the Royal Naval College. There are an array of local shops, restaurants and cafés along Trafalgar Road for residents to enjoy while larger supermarkets are also within easy reach. A number of popular nurseries and schools for families are also in the local vicinity.

Features

Period Home
Sought After Location
Potential To Extend STPP
Two Bedrooms
Double Fronted
Modern

Whitworth Street, London, SE10

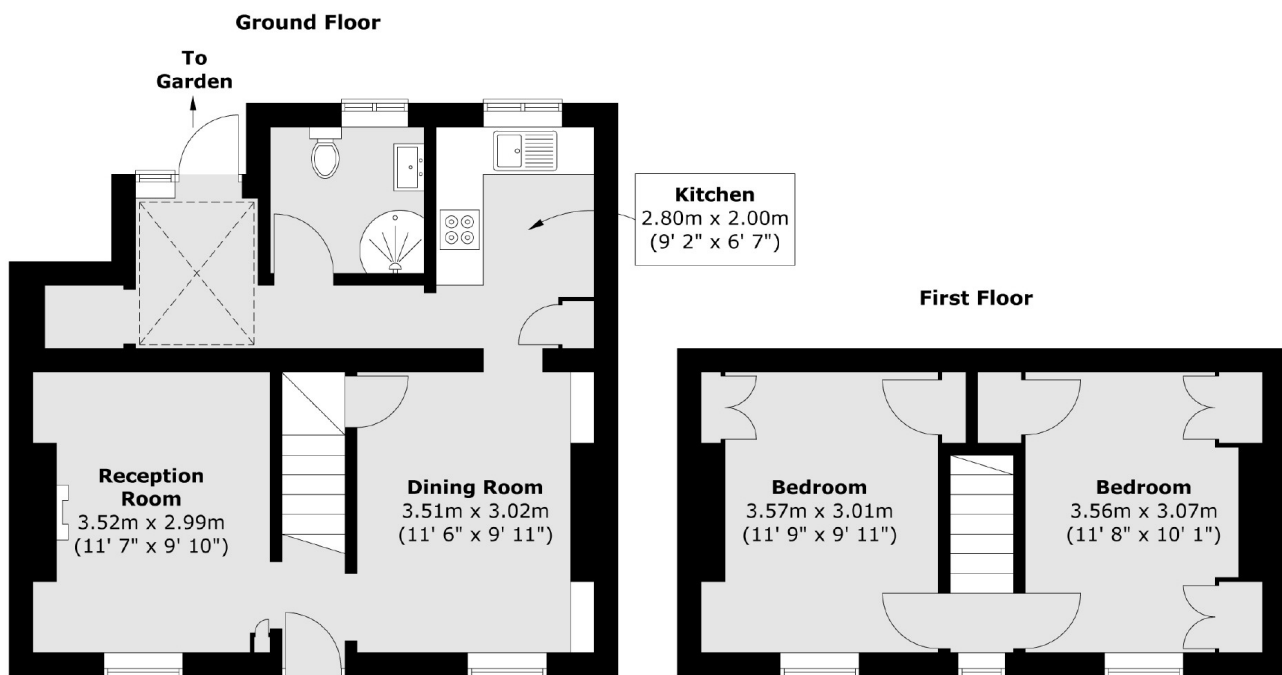

Total area (approx.) : 68.6 sq. m (738 sq. ft)