



## Deals Gateway, SE13

£300,000

A well presented one bedroom modern apartment, situated in this sought after development which benefits from a private balcony and is offered to the market chain free.

Conveniently located adjacent to the Deptford Bridge DLR with an approximate 12 minute journey time to Canary Wharf Jubilee Line. There's also the 453 day & night bus which will take you into the West End/Central London. A short walk will take you into Central Greenwich with an indoor market & an array of bars & restaurants.

### Features

- One Bedroom
- Chain Free
- Modern
- Private Balcony
- Sought After Location
- Ideal First Purchase

Deals Gateway,  
London, SE13

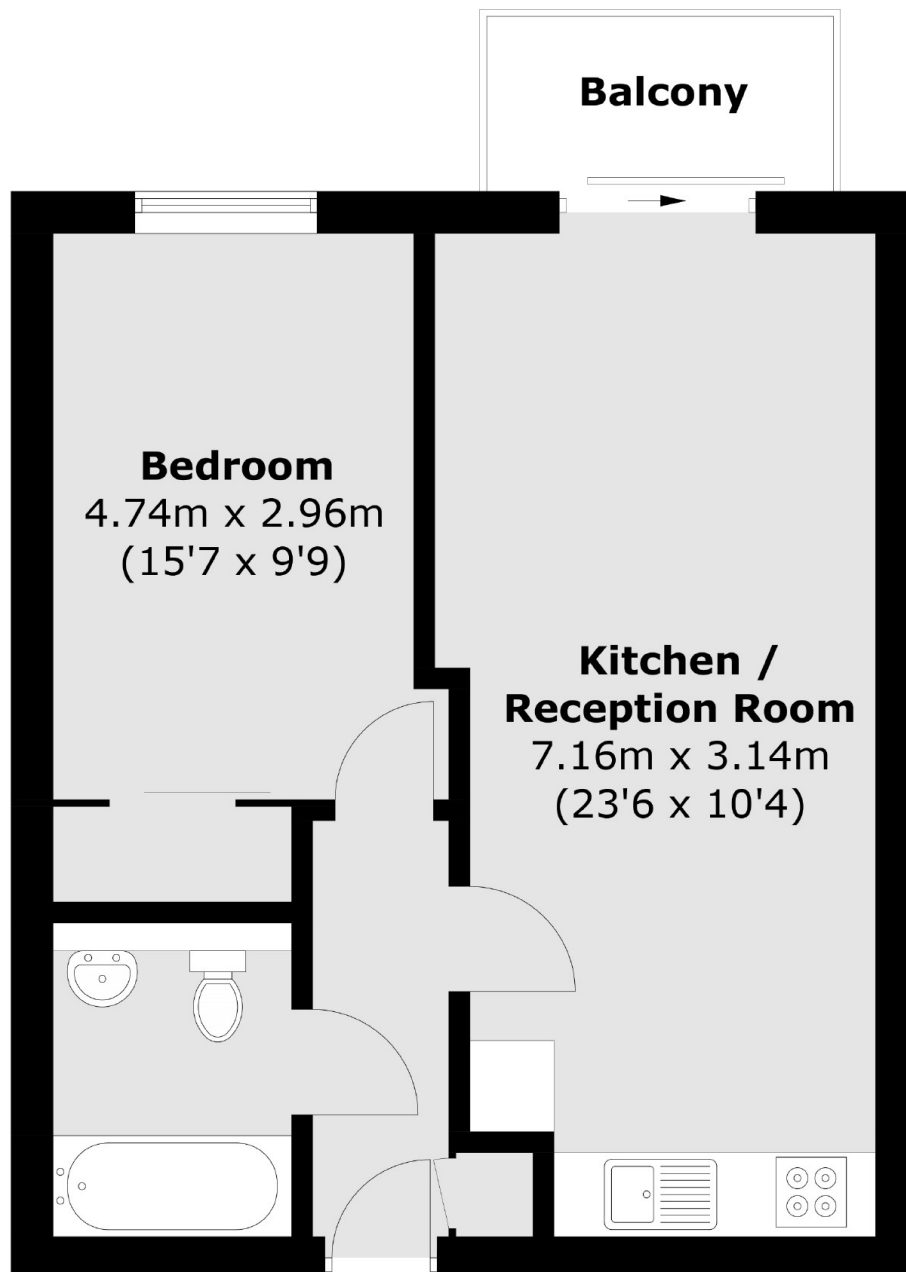

Total area (approx.): 42.3 sq. m (455.3 sq. ft)  
Balcony: 3.1 sq. m (33.4 sq. ft)