



Fingal Street, SE10

£900,000

A newly renovated five bedroom, two bathroom, period family home in a sought after location that has been finished to a phenomenal standard which benefits from a west facing garden and is just under 1,400 sq ft. This property is offered to the market chain free!

Fingal street is well located in East Greenwich, and sits at the foot of the Peninsula. The O2 arena and underground is close by, as is Maze Hill station. Westcombe Park mainline station is a short walk away, as well as local shopping parks and access to buses, which can take you directly into Greenwich town centre.

Features

- Sought After Location
- Newly Renovated
- Extended
- Period Features
- Immaculate Throughout
- West Facing Garden



Fingal Street, SE10

Entering on the ground floor, you are immediately welcomed by a spacious hallway granting access to the dual reception room with its exposed brick work, further along the hallway is the large kitchen and dining area with patio doors leading out onto a private rear west facing garden. On the first floor you will find three spacious double bedrooms and a family bathroom. The top floor offers two further double bedrooms one with a modern shower room and a Juliette balcony with city views.



Fingal Street, London, SE10

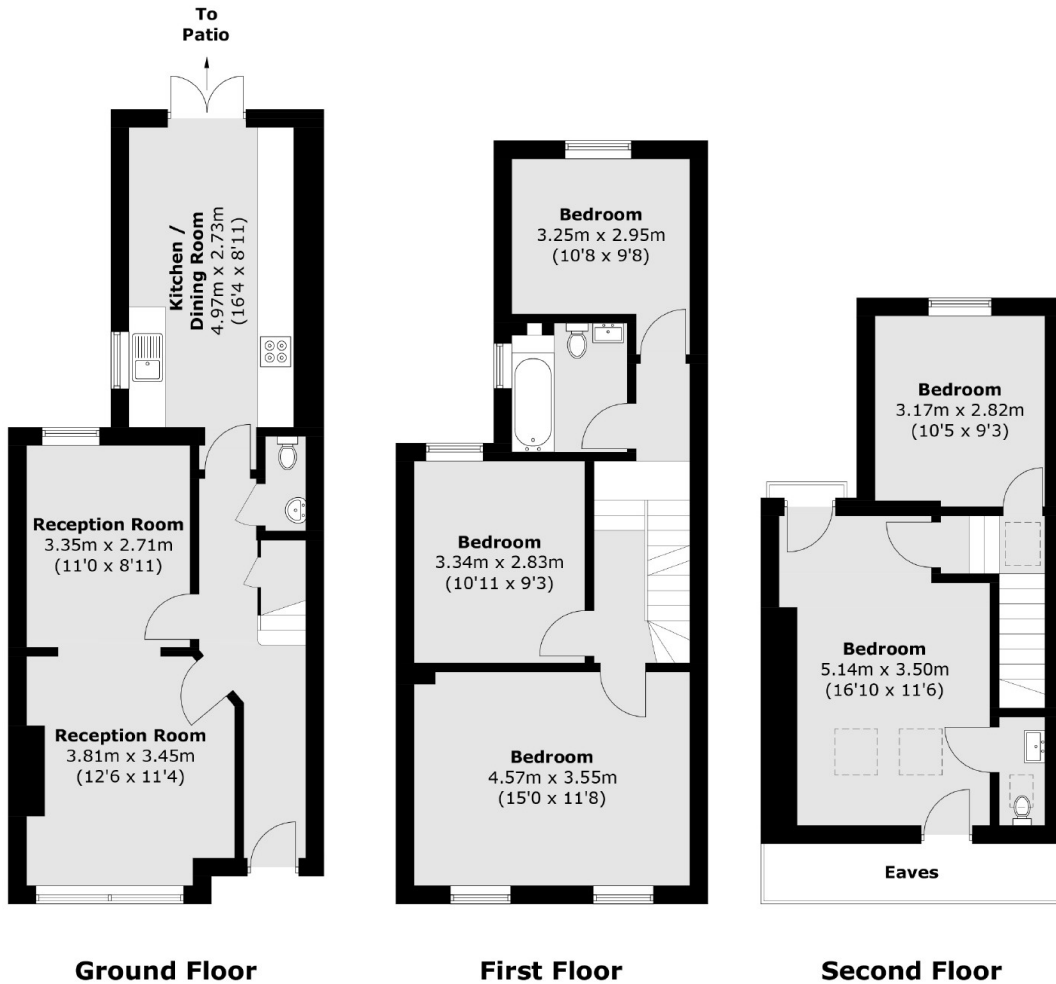

Total area (approx.): 125.9 sq. m (1,355.1 sq. ft)
(Excluding Eaves)