



Deals Gateway, SE13

£275,000

A well presented studio apartment in a modern development in sought after location that has been finished to a high standard and is offered to the market chain free!

Indiana building is perfectly located next to Deptford Bridge DLR, giving access to Canary Wharf in 15 minutes and Bank under 30 minutes. Deptford high street is close by with its array of shops, restaurants and amenities, as well as both Greenwich and Blackheath.

Features

Sought After location
Immaculate Throughout
Private Balcony
Chain Free
Ideal First Purchase
Modern

Deals Gateway,
London, SE13

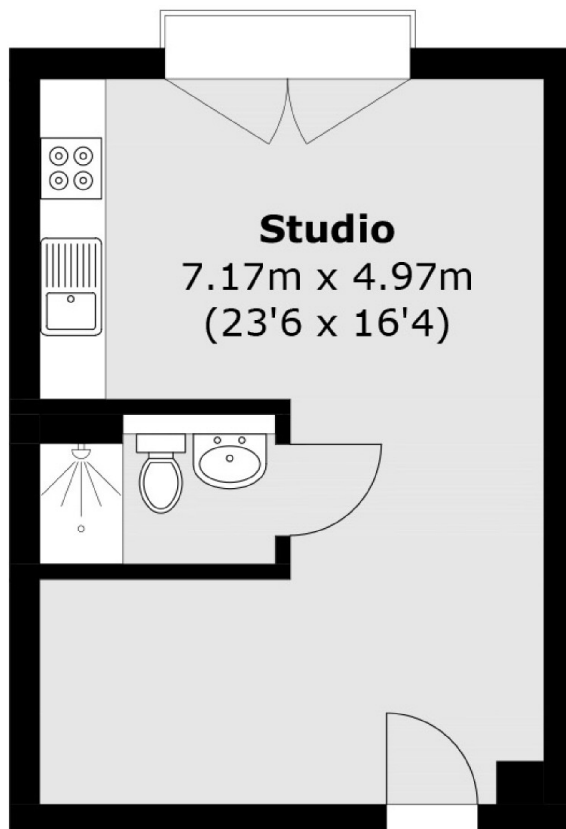

Total area (approx.): 35.5 sq. m (382.1 sq. ft)

(Excluding Balcony)