

Cable Walk, SE10

£623 Per week

A large two bedroom apartment on the third floor of this sought after development. This river facing apartment has wooden flooring, two balconies and access to residents gym and concierge. Parking available via separate negotiation.

Enderby Wharf is within walking distance of Greenwich High Street offering an array of bars, shops and restaurants, Cutty Sark DLR, Maze Hill train station, the O2 arena and North Greenwich (Jubilee line).

Features

- Two Bedrooms
- Two Bathrooms
- Direct River Views
- Two Balconies
- 24 Hour Concierge
- Residents Gym

Cable Walk, London, SE10

Third Floor

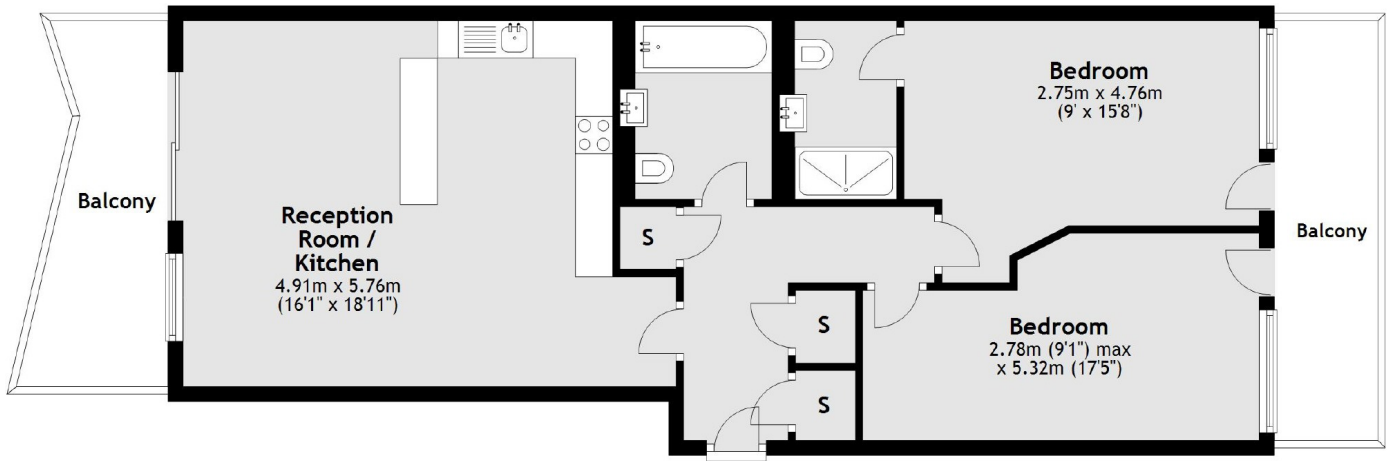

Main area: Approx. 76.4 sq. metres (822.4 sq. feet)
Plus balconies, approx. 15.4 sq. metres (165.9 sq. feet)