



## Telcon Way, SE10

£500,000

A well presented two-bedroom, two-bathroom flat located in the highly sought-after area of East Greenwich. Benefiting from great city views and a private balcony.

Gooch House is situated just a short walk into Greenwich Village with an array of shops, restaurants, and café's together with Royal Greenwich Park. Greenwich also has excellent transports links into central London from Maze Hill mainline station, the Cutty Sark DLR, Jubilee line from North Greenwich Tube station, and the Uber boat services into Canary Wharf.

### Features

- Private Parking Space
- Amazing City Views
- Private Balcony
- Communal Garden
- Sought After Location
- Two Bathrooms

Telcon Way,  
London, SE10

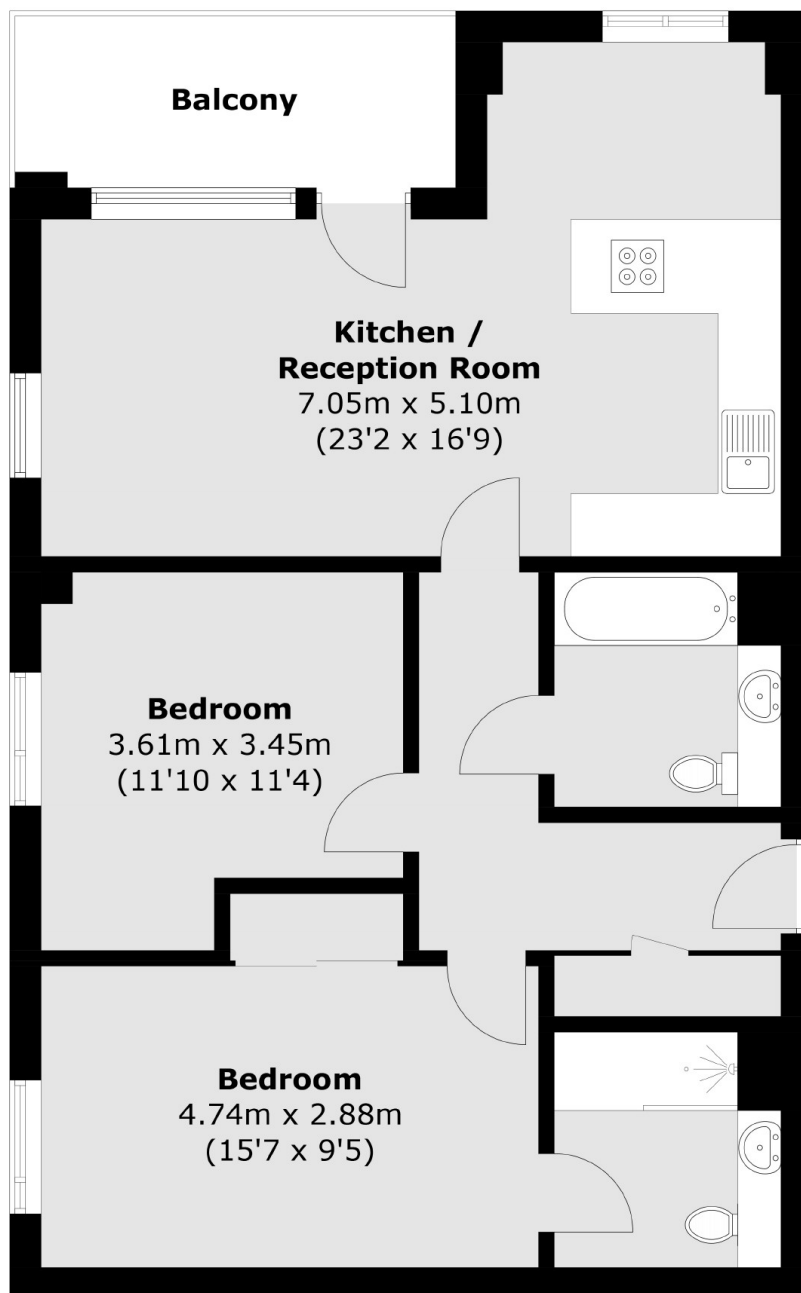

Total area (approx.): 75.6 sq. m (813.7 sq. ft)  
Balcony: 6.9 sq. m (74.3 sq. ft)