



Cutter Lane, SE10

£615,000

This well presented, two bedroom apartment with a private parking space offers fantastic river views. The property further benefits from an allocated parking space, A communal terrace with amazing views and as well as a residents swimming pool and gym facilities.

Cutter Lane is perfectly located for access into the O2 and all the shops and restaurants on offer. You are also next to the Emirates Light Air and North Greenwich underground.

Features

- Spacious Two Bed Apartment
- River Views
- 24Hr Concierge
- Secure Underground allocated Parking Space
- Residents Terraces & Gyms
- Swimming Pool

Cutter Lane,
London, SE10

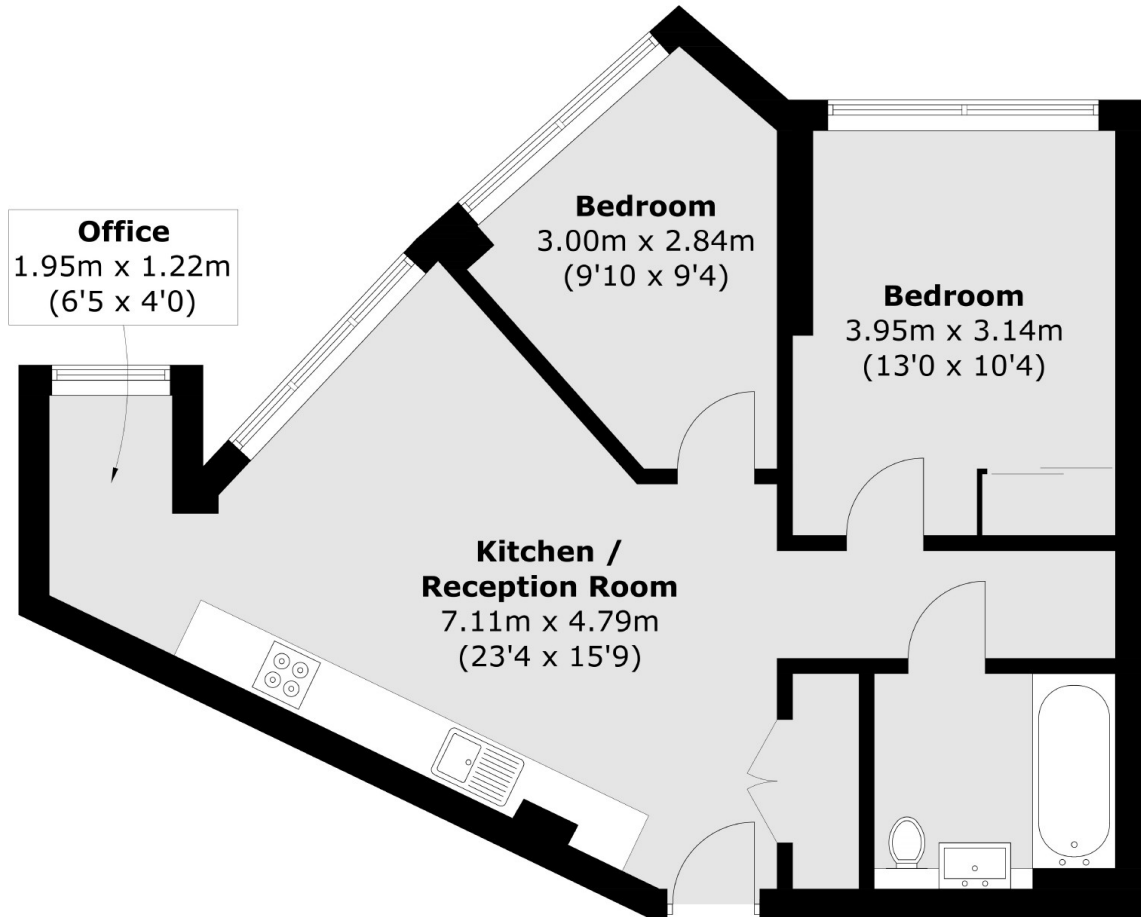

Total area (approx.): 58.5 sq. m (629.7 sq. ft)