



Crosslet Vale, SE10

£350,000

A modern and well presented second floor purpose built two bedroom flat in a quiet close moments from Deptford Bridge DLR station, the accommodation comprises an entrance hall with remote entry phone system, bright and spacious living room, separate fitted kitchen, good size bedrooms and three piece bathroom.

Crosslet Vale is a short walk to Deptford Bridge DLR station, Greenwich Main Line station and DLR is just a short distance away as is the town centre with its many pubs, cafe's and restaurants.

Features

- Two Double Bedrooms
- Modern Interior
- Purpose Built Building
- Quiet Location
- Low Charges
- Close To Transport

Crosslet Vale,
London, SE10

First Floor

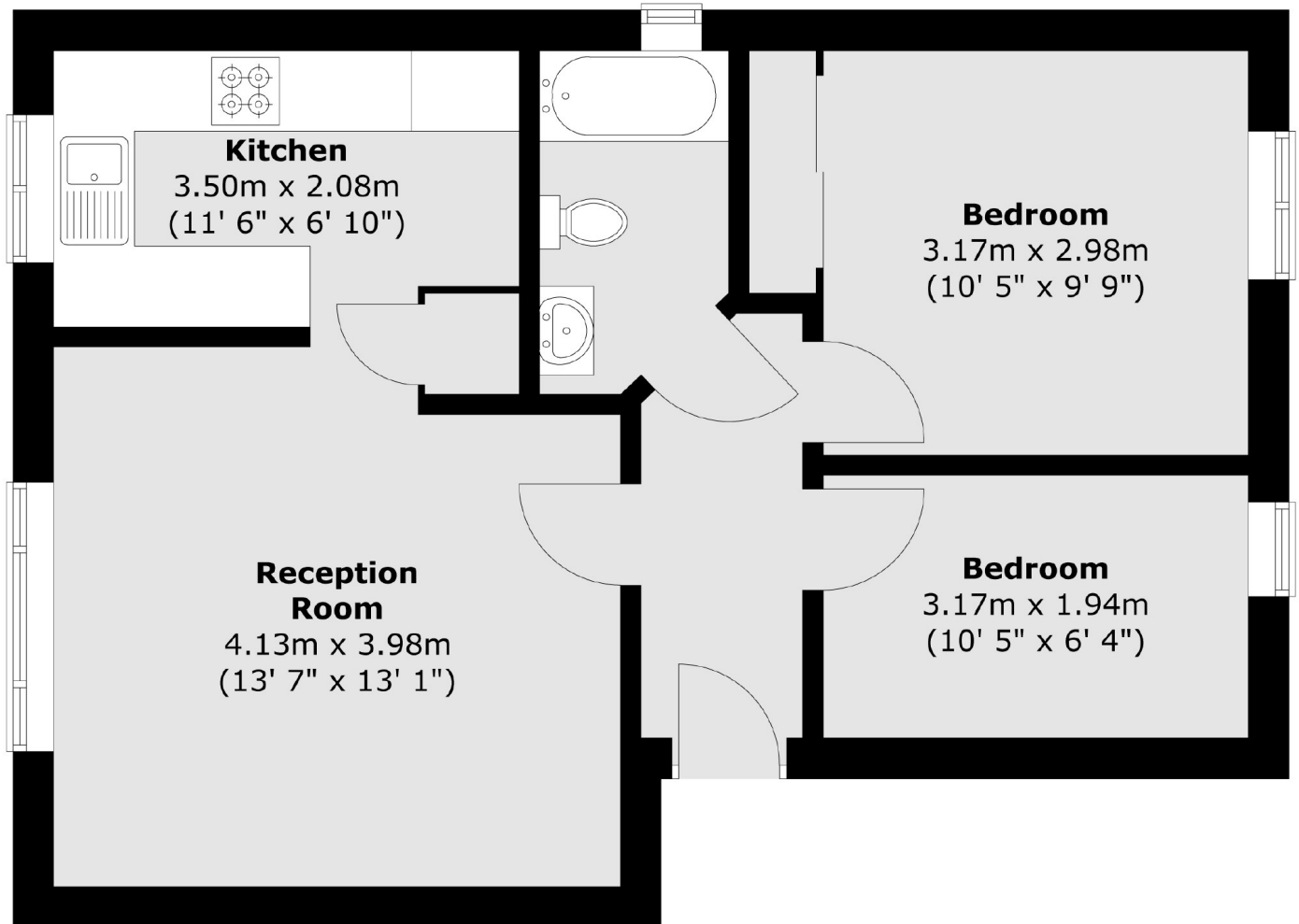

Total area (approx.) : 49.9 sq. m (537 sq. ft)