



Glaiser Street, SE8 £450,000

A charming riverside two bedroom, two bathroom modern apartment which is situated in a sought after location and benefits from private parking and a private balcony with views onto the river.

Excellent location enjoying views of the river and just minutes away from Greenwich DLR and overground stations that take you into London Bridge, Cannon Street and Canary Wharf in a matter of minutes. There are also plenty of restaurants, bars and shops located a short walk away along the river. Situated on the Thames river path, taking you through Greenwich past the Cutty Sark and onto the o2 .

Features

- Modern
- Quiet, Sought After Location
- Free Underground Parking
- River Views
- Floor To Ceiling Windows
- Fourth Floor

Glaiser Street,
London, SE8

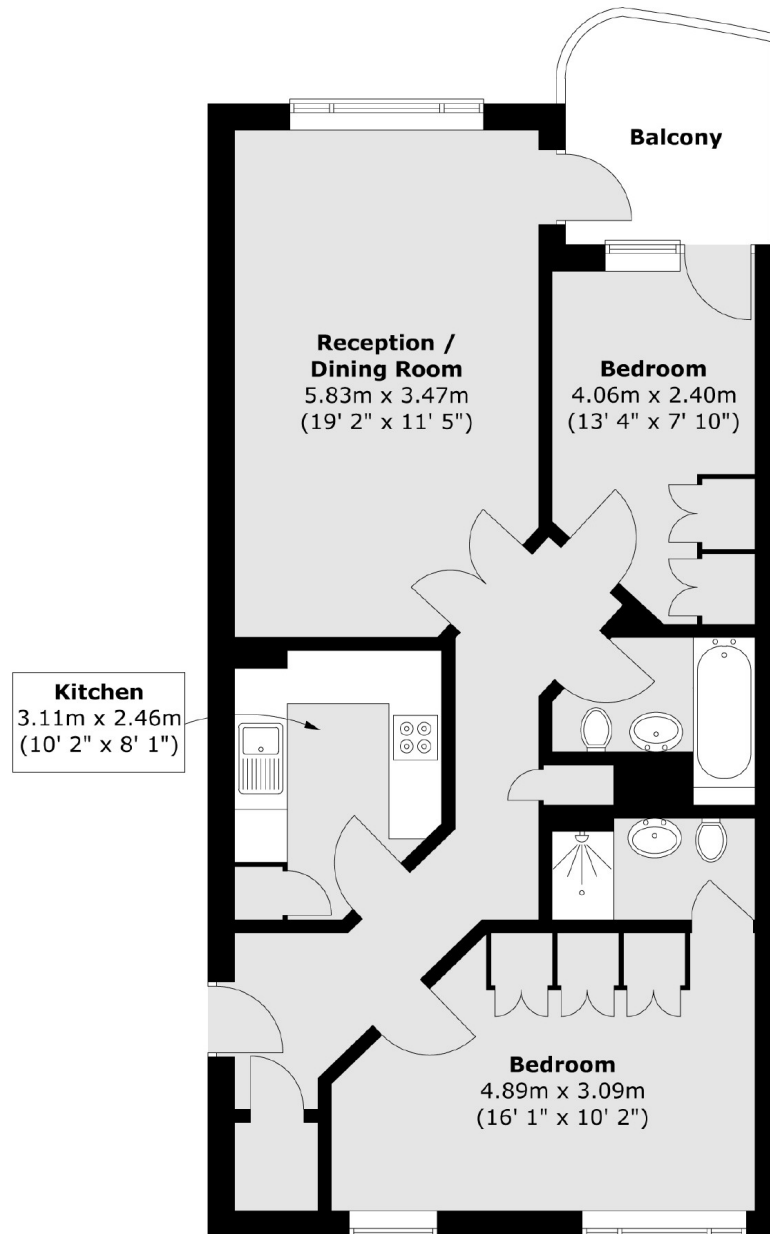

Total area (approx.) : 68.9 sq. m (742 sq. ft)
Total balcony area (approx.) : 6.2 sq. m (67 sq. ft)