

Telcon Way, SE10

£392 Per week

Well presented one bedroom apartment located within a secure development, features open plan living with hardwood flooring, fully fitted kitchen with integrated appliances, private sheltered balcony and a large double bedroom with built in storage and family size bathroom.

This apartment is ideally located for the commuter, situated between a choice of three stations, which include North Greenwich (Jubilee), Maze Hill & Westcombe Park (Overground), with a large selection of (A) roads close by, making Central London and beyond easily accessible. The picturesque riverside location makes the walk into Greenwich town centre extremely enjoyable, whilst you are just a short distance from the beautiful open spaces of Greenwich Park.

Features

- One Bedroom
- Open Plan Living
- Private Balcony
- Secure Development
- Close to the River
- Unfurnished

Telcon Way,
London, SE10

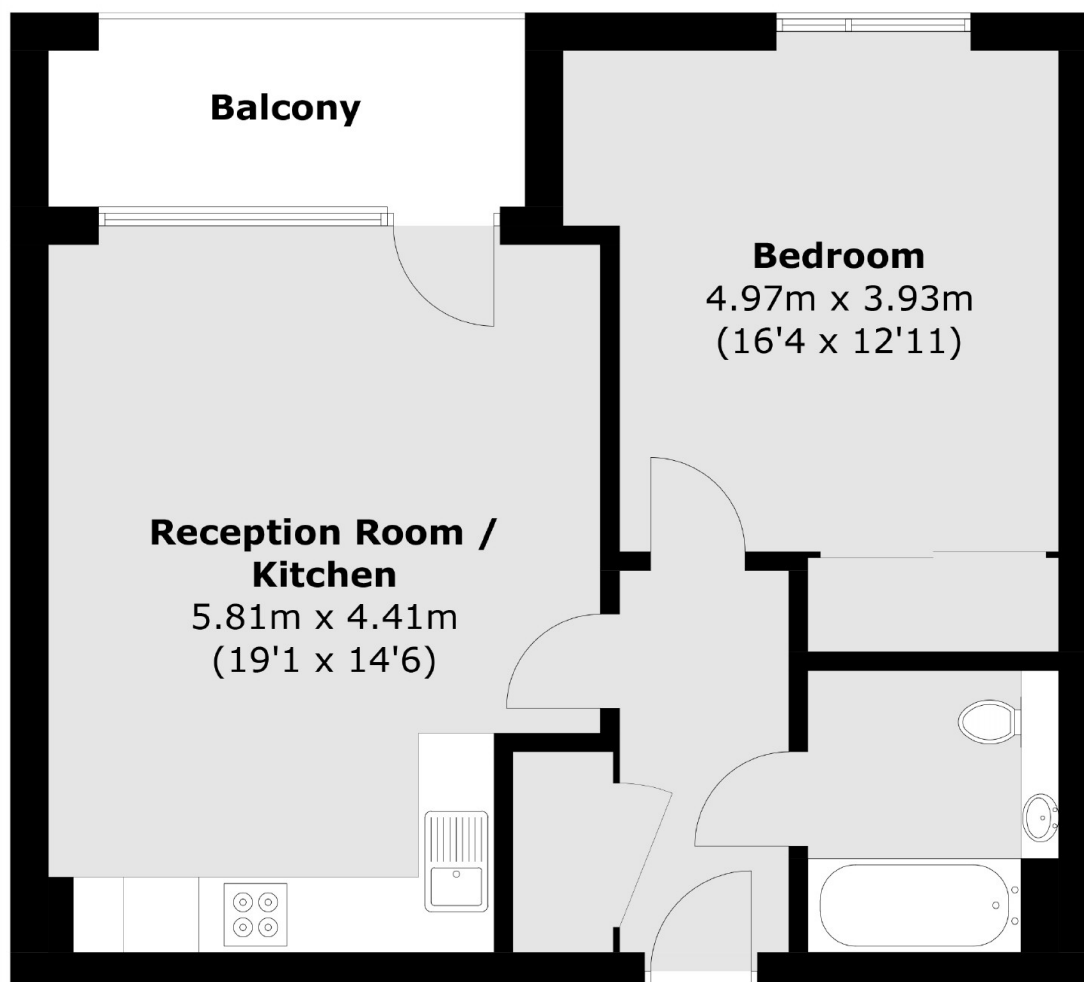

Total area (approx.): 52.4 sq. m (564.0 sq. ft)
Balcony area (approx.): 5.6 sq. m (60.3 sq. ft)

Dexters

Greenwich
275 Greenwich High Road
Greenwich
London
Lettings
020 8815 2216

Energy Rating: B. We aim to make our particulars both accurate and reliable. However they are not guaranteed; nor do they form part of an offer or contract. If you require clarification on any points then please contact us, especially if you're traveling some distance to view. Please note that appliances and heating systems have not been tested and therefore no warranties can be given as to their good working order.

 **RICS** | Regulated
Estate Agent
and Letting Agent

dexters.co.uk