



Peartree Way, SE10

£600 Per week

Two bedroom two bathroom apartment spanning over 1000 sq ft, features large open plan living space opening to private balcony, two larger than average double bedrooms, main with en-suite.

The apartment is located within walking distance of the O2 which hosts a wide selection of bars, restaurants and cinema, The Emirates cable car is also nearby. North Greenwich tube station provides links to Canary Wharf and London Bridge. Charlton and Westcombe Park overground. Greenwich Millennium Village features an abundance of landscaped green areas and riverside walkways.

Features

- Two Bedrooms
- Two Bathrooms
- Over 1000 sq ft
- Large Open Plan
- Private Balcony
- Secure Development

Peartree Way,
London, SE10

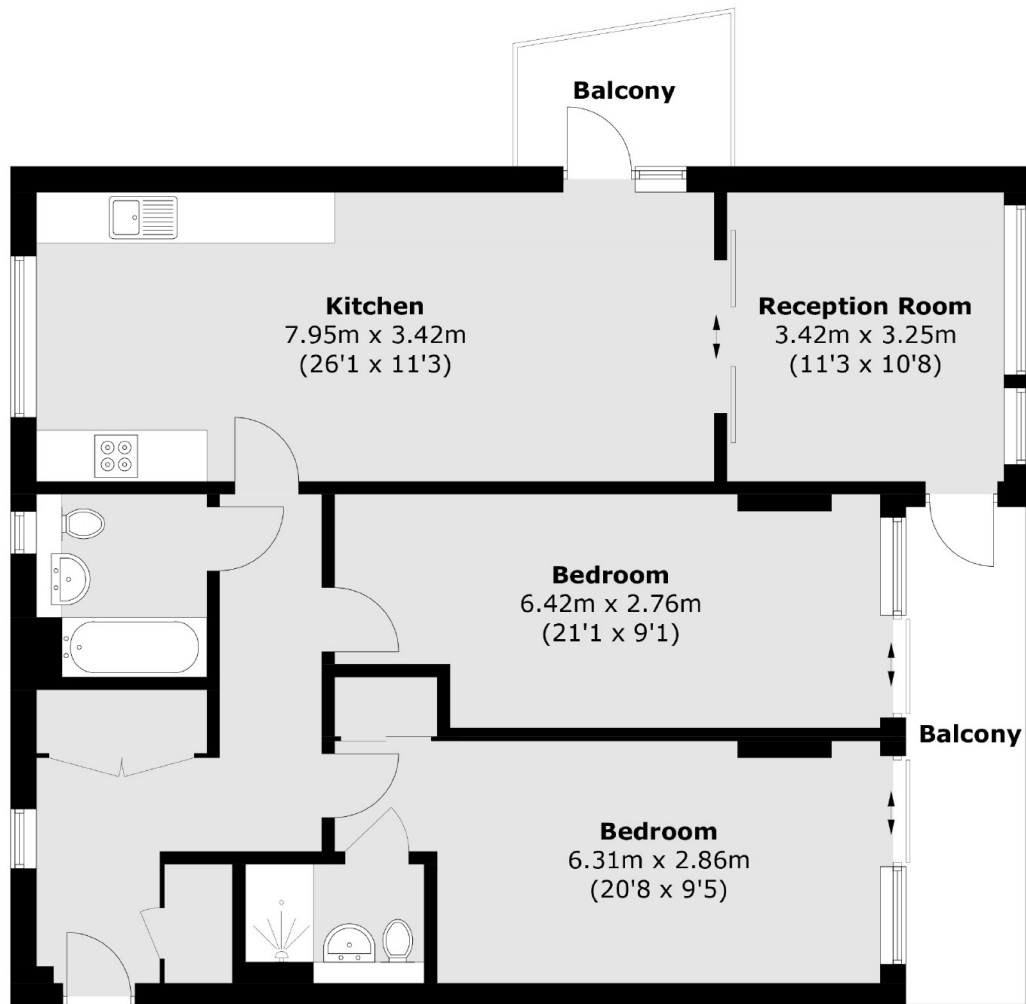

Total area (approx.): 97.7 sq. m (1,051.6 sq. ft)
Balcony : 12.2 sq. m (131.3 sq. ft)

Dexters

Greenwich
275 Greenwich High Road
Greenwich
London
Lettings
020 8815 2216

Energy Rating: D. We aim to make our particulars both accurate and reliable. However they are not guaranteed; nor do they form part of an offer or contract. If you require clarification on any points then please contact us, especially if you're traveling some distance to view. Please note that appliances and heating systems have not been tested and therefore no warranties can be given as to their good working order.

 **RICS** | Regulated
Estate Agent
and Letting Agent

dexters.co.uk