



## Ashburnham Place, SE10

£1,500,000

A well presented five bedroom Victorian family home renovated to a great standard throughout. This family home boasts period features throughout, five double bedrooms, two bathrooms and potential to extend out and across the ground floor as well as into the loft STPP and further benefits from being situated in the Ashburnham Triangle conservation area.

Ashburnham Place is widely considered one of the best roads in West Greenwich and forms part of the hugely desirable Ashburnham Triangle.

### Features

- Victorian Town House
- Over 1700sq Feet
- Good Order Throughout
- Roof Terrace
- Five Bedrooms
- Two Bathrooms



## Ashburnham Place, SE10

Upon entering on the ground floor you are welcomed by a dual reception room which offers access into the garden as well as being complemented by a large bay window to the front, to the rear of the ground floor is the expansive open plan kitchen dining space which can be extended across and to the rear STPP.

On the first floor you have two exceptionally large double bedrooms, a large four piece family bathroom and a guest en-suite to the rear bedroom, on the top floor you have three further double bedrooms with the rear granting access to the roof terrace.



# Ashburnham Place, London, SE10

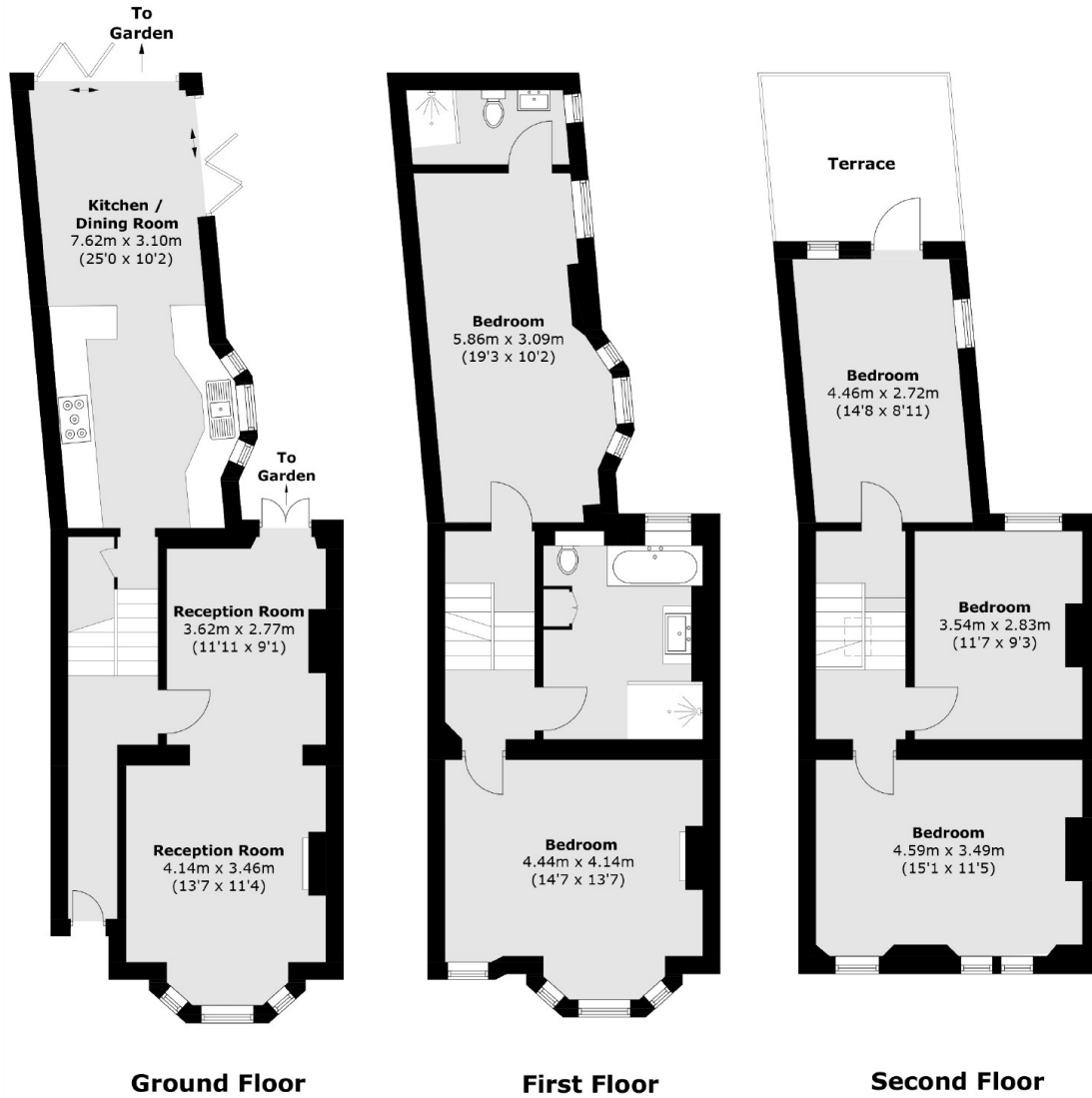

Total area (approx.): 158 sq. m (1700.7 sq. ft)  
Terrace : 9.2 sq.m (99.0 sq.ft )