



Gloucester Circus, SE10

£1,750,000

Representing a fantastic opportunity to purchase this imposing and substantial five storey Grade II-Listed Georgian residence which is located within this Prime West Greenwich crescent.

Gloucester Circus with its beautiful garden square is located moments away from Greenwich Park and Town Centre. Greenwich Mainline and DLR Station is located a short walk away providing regular and direct access to Canary Wharf, London Bridge, Cannon Street and Kings Cross. Greenwich Market is also a short distance away with its many amenities on offer.

Features

- Grade II-Listed
- Five Storey
- South Facing Garden
- Renovation Project
- Private Residence Garden
- Chain Free



Gloucester Circus, SE10

The property is offered needing an extensive refurbishment project allowing the prospective purchaser the chance to create their perfect home, the versatile layout still in its original form spread out over five floors measuring well in excess of 3000sq feet and further benefiting from a sunny south facing rear garden as well as a private residence garden.

Gloucester Circus, London, SE10

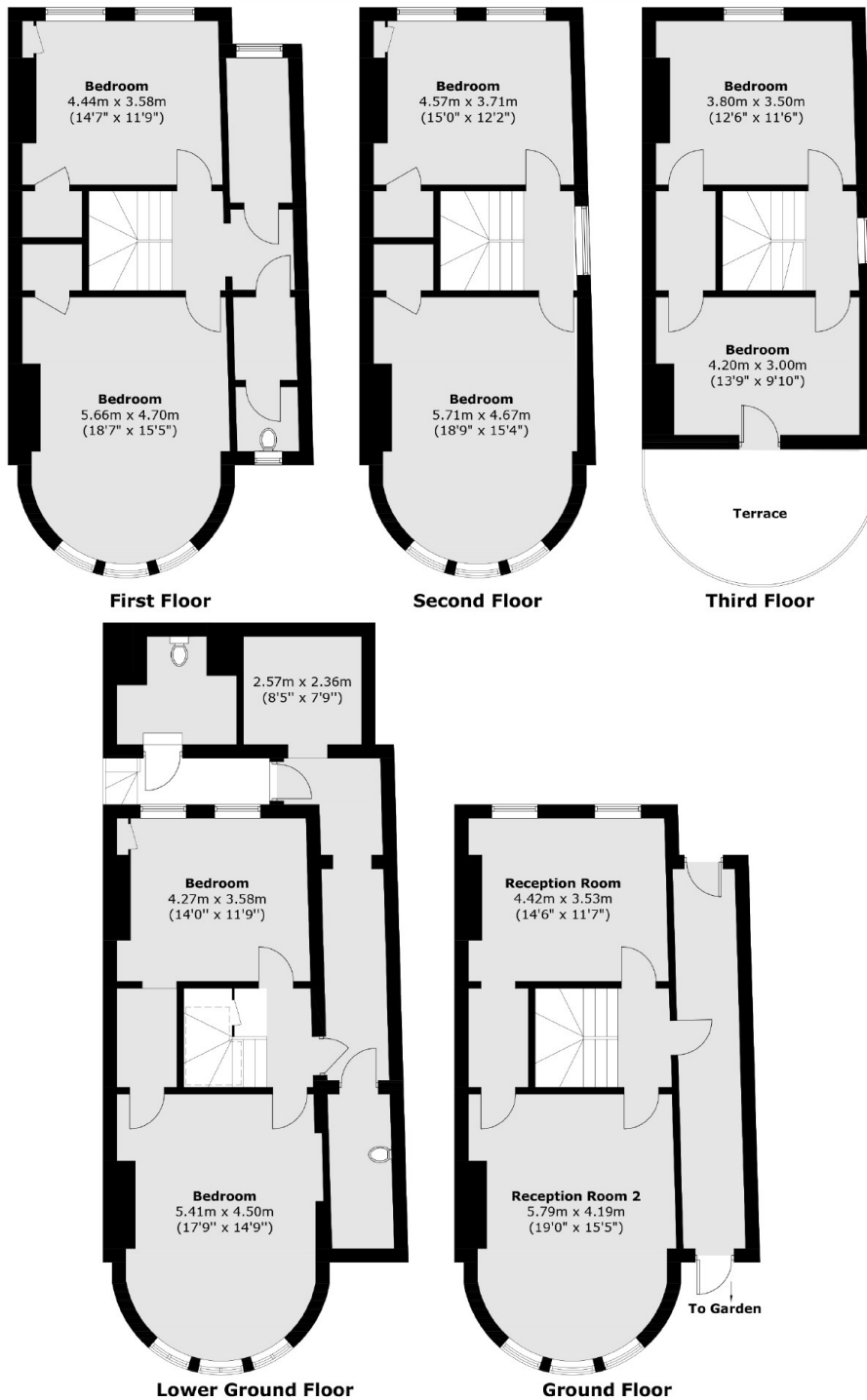

Total area (approx.): 290.0 sq. m (3121.5 sq. ft)