



Banning Street, SE10

£540,000

An opportunity to acquire this charming three bedroom apartment which is situated in a sought after location and benefits from amazing City Skyline views.

The Royal Greenwich Park and Greenwich Village are both close by as is Maze Hill station providing frequent access into Cannon Street. The Cutty Sark DLR is also within easy reach access serving Canary Wharf and buses to the O2 for the jubilee line. The Thames is close by for river transportation on the Clipper.

Features

- Three Bedrooms
- Modern
- Sought After Location
- Amazing City Skyline Views
- Long Lease
- First Floor

Banning Street,
London, SE10

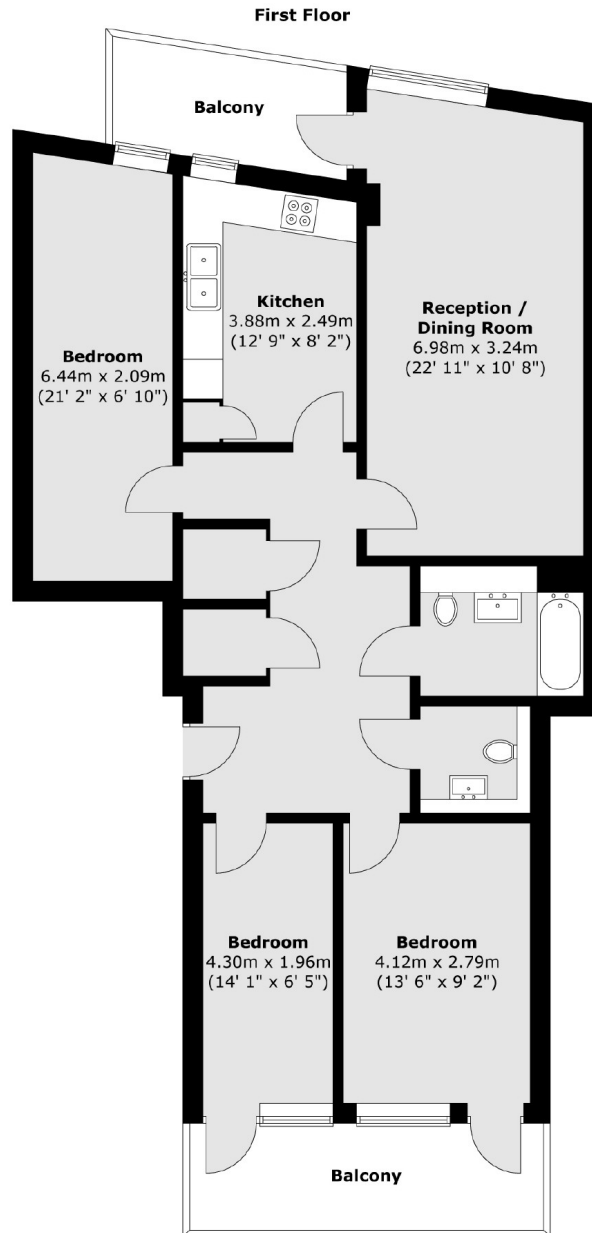

Total area (approx.) : 94.2 sq. m (1014 sq. ft)
Total balcony area (approx.) : 12.6 sq. m (136 sq. ft)