

ANWYL
thoughtful homes



the edgworth

3 bed semi-detached

A three bedroom home where you can expect the unexpected with executive levels of *luxury*. Key features include a premium suite to the second floor with a large shower room and walk in wardrobe.

www.anwylhomes.co.uk

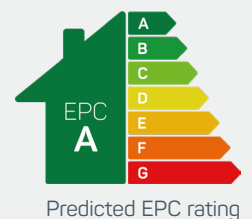

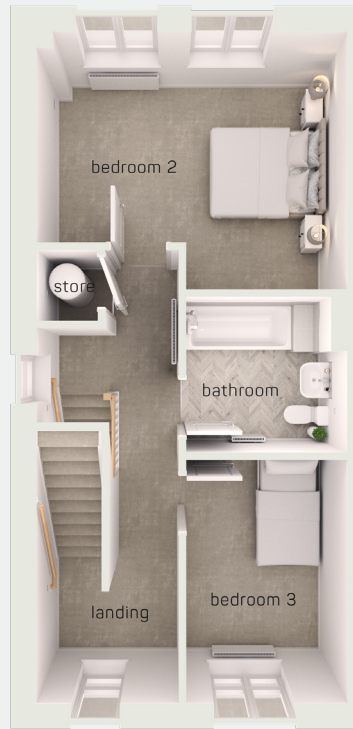

modern
open plan living

ground floor

kitchen/dining 13'11" x 13'9"
living room 10'2" x 16'4"
cloak 3'5" x 6'0"

kitchen/dining 4.25m x 4.18m
living room 3.11m x 4.97m
cloak 1.05m x 1.82m

first floor

bedroom 2 13'11" x 11'8"
bedroom 3 7'3" x 11'0"
bathroom 7'3" x 7'1"

bedroom 2 4.25m x 3.56m
bedroom 3 2.21m x 3.35m
bathroom 2.21m x 2.15m

second floor

bedroom 1 13'11" x 16'8"
en-suite 6'8" x 9'4"

bedroom 1 4.25m x 5.08m
en-suite 2.02m x 2.84m

the edgworth
3 bed semi-detached

www.anwylhomes.co.uk

ANWYL
thoughtful homes

NEW HOMES QUALITY CODE

NEW HOMES SERVICE OMBUDSMAN

Anwyl Homes is a Registered Developer with the NHQB. This is a computer-generated image of the edgworth, elevation treatment may vary. Room sizes are approximate, dimensions are taken from the longest room point (please consult homes advisor for measurement points). Plots may be handed and any garages may be single or double. Kitchen and bathroom layouts are indicative. These plans are correct at the time of going to press, but may be subject to change during construction. Please ensure that you check for specific plot details. 29/08/23.

everything considered.