



## Flat 12, Seymour House Warwick Road, Coventry

In Excess of £269,950



## Flat 12

Seymour House Warwick Road, Coventry

WOW An Absolute Luxury Apartment Set In A Beautiful Development Just 2 Minutes From Coventry Rail Station And City Centre - 2 Double Bedrooms - Lounge - Stunning Kitchen - Bathroom - En-Suite - LONG LEASE - Garage - Parking - No Chain  
Council Tax band: D

Tenure: Leasehold

EPC Energy Efficiency Rating: C

EPC Environmental Impact Rating: C





# First Floor

Approx. 76.2 sq. metres (820.6 sq. feet)

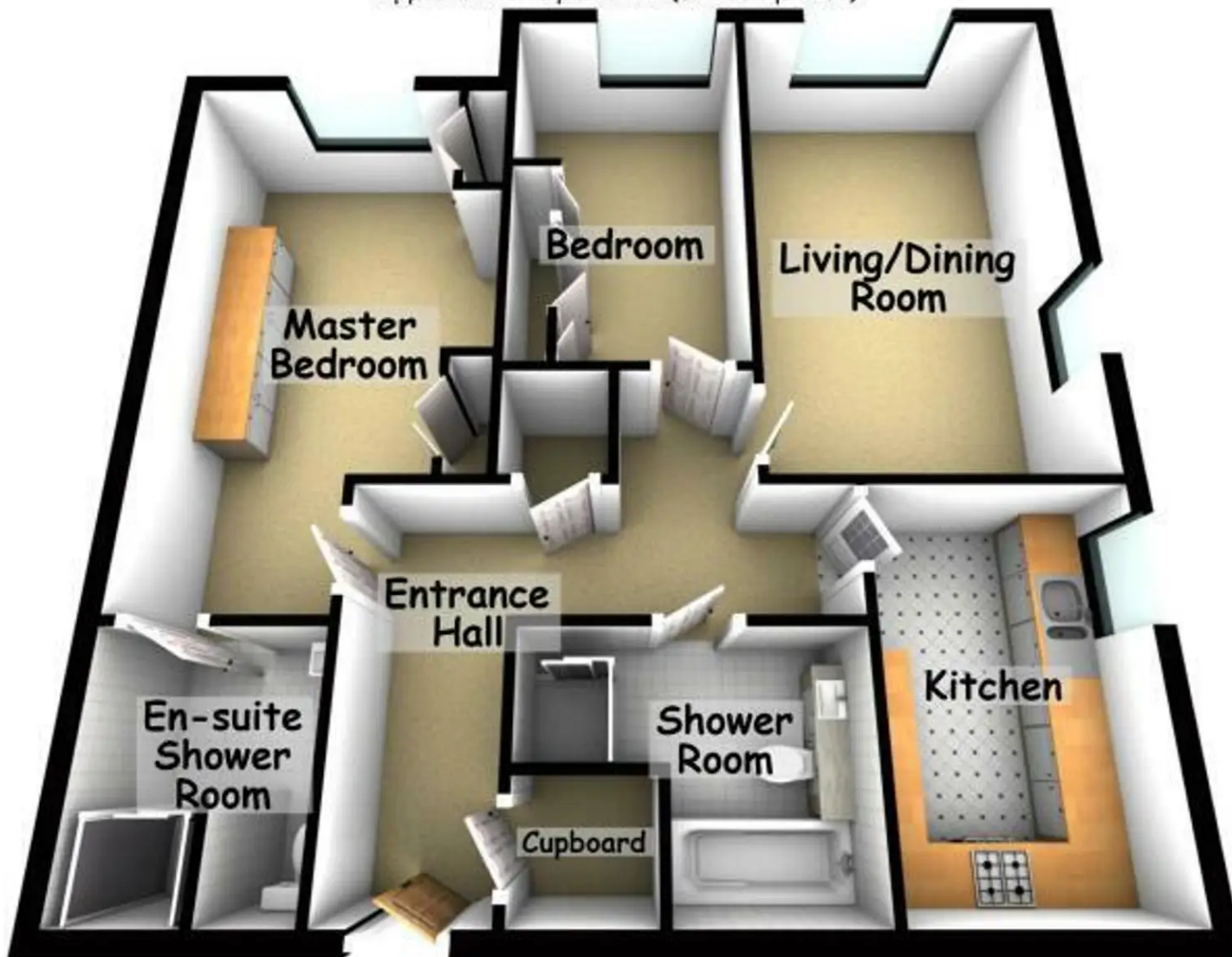

Total area: approx. 76.2 sq. metres (820.6 sq. feet)