



£850,000 leasehold

375 Kensington High Street, W14

- 1 bed room 1 bathroom
- Very large living area
- 973 sq ft
- Storage areas
- Private balcony
- Luxury resident's facilities
- Kensington High street area
- 24 hour concierge
- Excellent transport links

Beautifully proportioned one bedroom apartment in the sought after 375 Kensington High Street development. The floor to ceiling windows gives a dual aspect views. A spacious open plan kitchen and living room gives both space and light, a perfect combination for modern day living.

The bedroom includes a large built-in, mirrored wardrobe giving plenty of storage space, a good size storage cupboard is also available. The large bathroom features a hidden utility area, giving even more storage space. The development has 24 hr concierge and resident only leisure facilities including a cinema room, swimming pool and gym.

The apartment is situated moments from Kensington Olympia overground station as well as a short distance to Kensington High Street and Earls Court station giving you access to the District Line and the Circle Line. The shops and restaurants of Kensington High Street are a small walk away as well as the larger shopping centre, Westfield. For some peace and quiet from the shops, Holland Park and Kensington Palace are only moments away.



375 Kensington High Street

Benson House, W14

Approximate Gross Internal Floor Area = 55.2 sq m / 595 sq ft

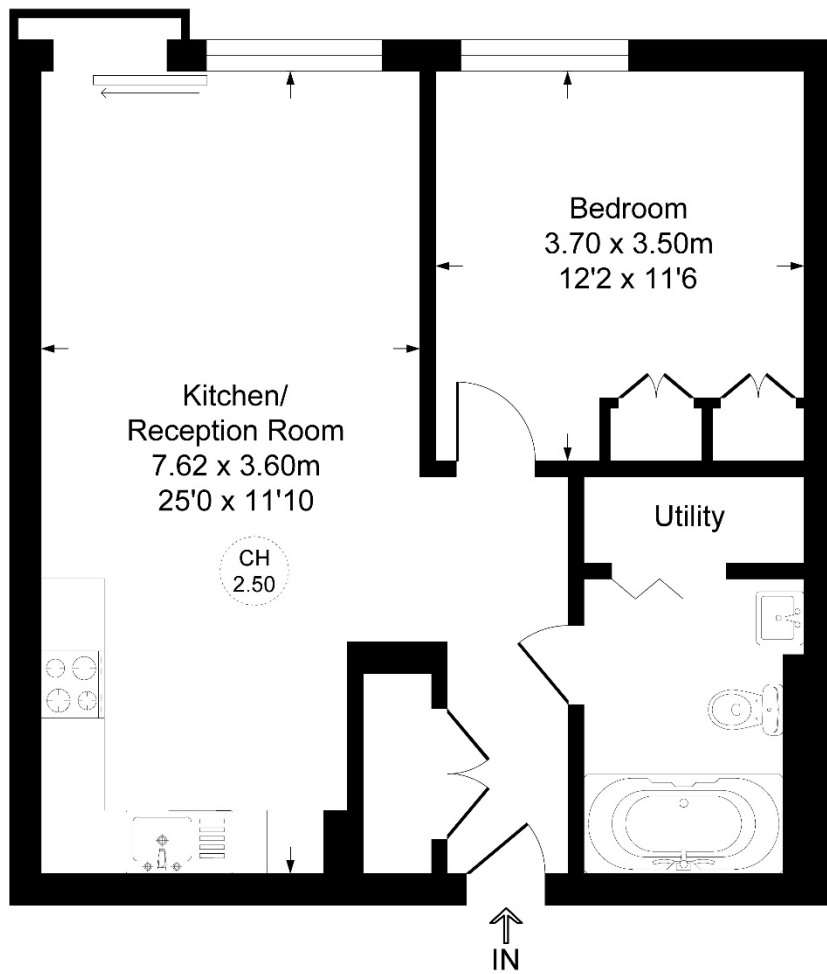
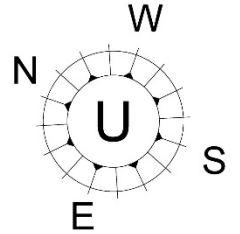

This Plan is for Layout guidance Only. Not drawn to scale unless stated. Windows and Door openings are approximate. Whilst every care is taken in the preparation of this plan, please check all dimensions, shapes and compass bearings before making any decisions reliant upon them. Please be advised that Urbanspaces/ our agents have not seen or reviewed any building regulations or planning permission in relation to works carried out to the property