



Riverlight Quay, Nine Elms, London, SW11

£4,100 pcm

- 5th floor apartment along the river Thames
- 2 bedrooms (master en-suite)
- 2 bathrooms
- Open Plan Reception
- 2 balconies
- 906 sq ft
- Modern Integrated Kitchen
- Luxury residents' facilities
- Communal garden, private cinema & games room
- 24-hour concierge

River-facing 2-bedroom 2 bathroom 906 sq.ft apartment is currently available in Riverlight Quay, an impressive modern development along the River Thames.

The property boasts a master bedroom with an en-suite, 2 balconies and lots of storage - a second spacious bedroom - a nice size bathroom - fully integrated kitchen with high standard appliances and a comfortable living room all with full-height floor-to-ceiling windows that flood the space with natural light. A desirable option of underground parking is also available.

Each bedroom in this apartment is luminous, adorned with excellent fixtures, integrated wardrobes, and private balcony access—an exceptional way to start each day, combining tranquillity and vitality. The bathrooms feature walk-in showers, large mirrors, generous storage, and elegant tiling throughout, ensuring both convenience and sophistication.

Residents of Riverlight Quay have the use of a 24-hour concierge, a residents health spa with a well-equipped “river view” gymnasium, a heated swimming pool with steam room, sauna, and a Jacuzzi, as well as a cinema screening room and virtual golf facility.



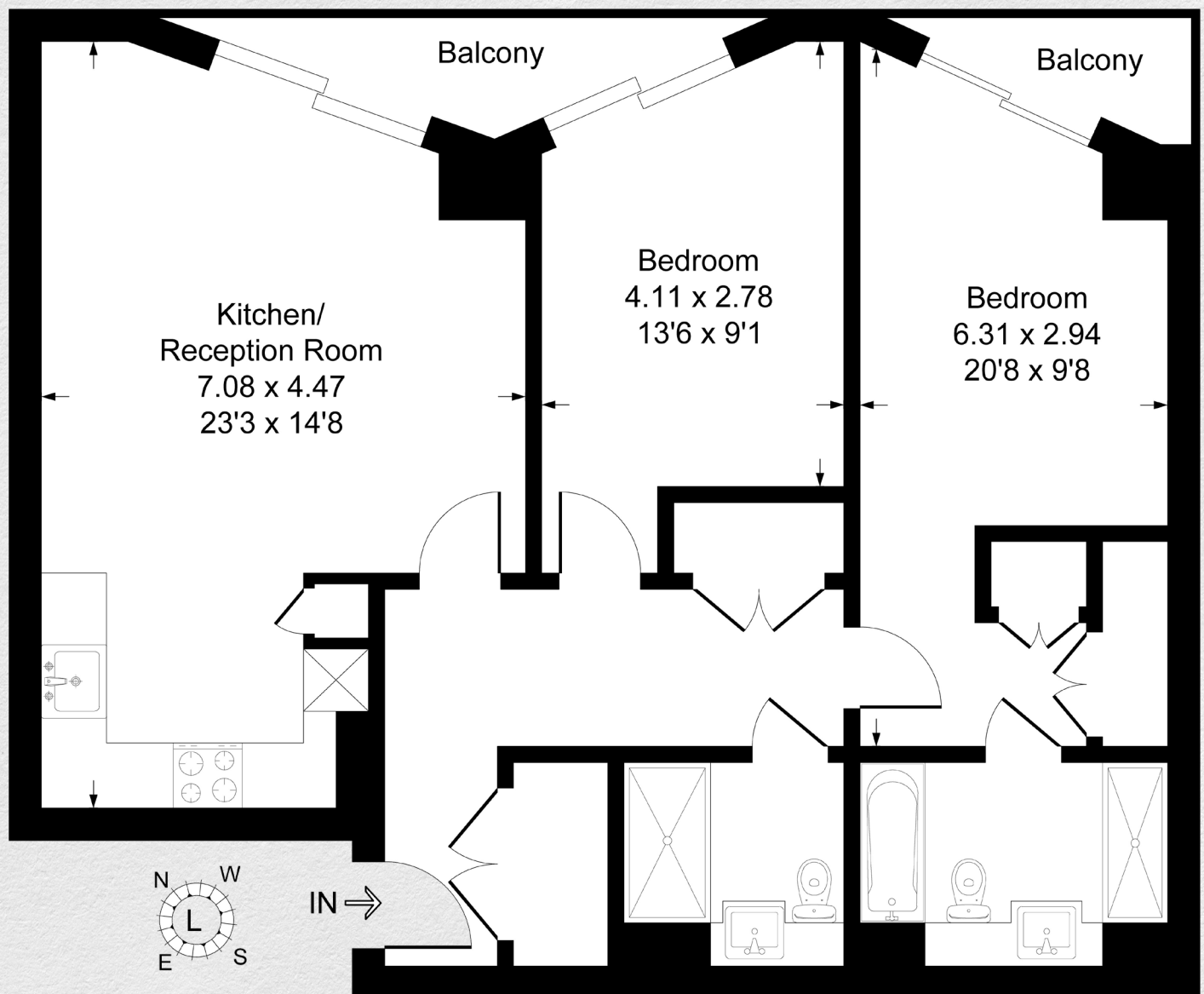

Address:

Riverlight Quay, Nine Elms, London, SW11

sq ft

906

bed

3

bath

2

*** For illustration purposes only. Could not be to scale. One-London aims to ensure accuracy but is not liable for any discrepancies.*