



Oakley House, Battersea Roof Gardens, London

£3,400 pcm

- 4th floor
- 1 bedroom
- 1 bathroom
- 617 sq ft
- Private winter garden
- Residents Lounge and Cinema
- 24 hour concierge
- Overlooking Battersea Power Station
- Sought after location
- Great transport links
- Vibrant area

Stunning, 1 bedroom, 1 bathroom apartment in the Foster & Partners designed Battersea Roof Gardens part of the Battersea Power Station development in London.

Large open plan living area leading to a large private winter garden. You have a bright kitchen and dining area with a bedroom suite at the end of the hallway.

Ideal for entertaining, this stunning apartment offers a generous amount of external space providing amazing views of the Power Station, Malaysia Square and the Electric Boulevard. This is ready to move in.

Situated on the River Thames, the apartment is ideally located for Chelsea, Battersea Park and the tube, rail and Thames Clipper transport links nearby.



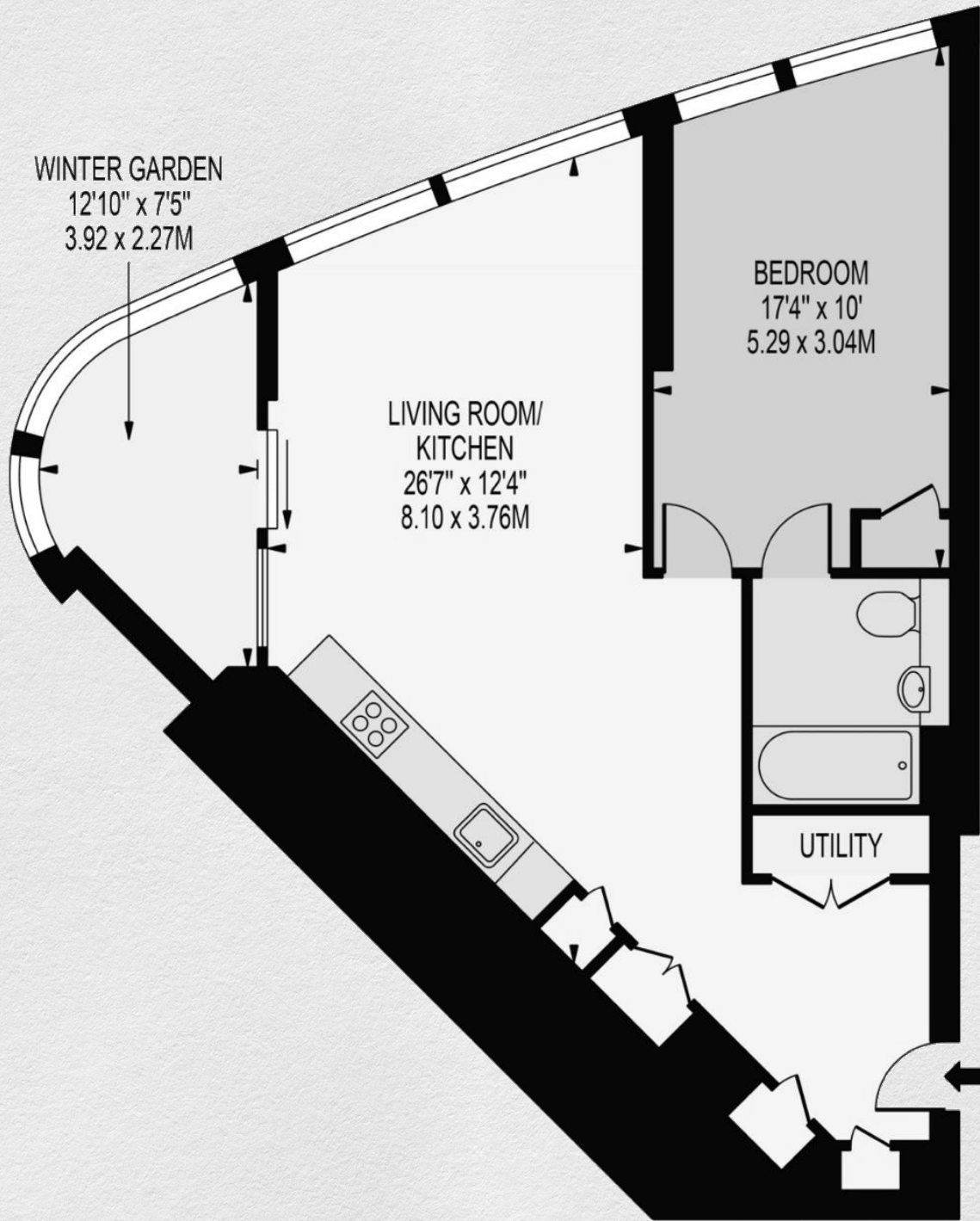

Address:

Oakley House, Battersea Roof Gardens, London

sq ft

617

bed

1

bath

1

*** For illustration purposes only. Could not be to scale. One-London aims to ensure accuracy but is not liable for any discrepancies.*