



9 Millbank, London, SW1P

£4,000,000

- 3 bedrooms
- 3 bathrooms
- Second floor apartment
- 2 parking spaces
- Large open plan living area
- 1,763 sq ft
- Laundry room
- Comfort cooling
- Five-star gym, pool & spa
- Cinema screening room
- 24-hour concierge
- List access
- Great transport links
- Prestigious location

Stunning 3 bedroom - 3 bathroom apartment set on the second floor the within a prestigious luxury development in Westminster, 9 Millbank.

Crafted to the highest of specifications, this apartment has a bright spacious and open plan living room with floor to ceiling windows featuring a luxury kitchen with integrated Kuppertsbusch appliances, master bedroom with a walk in wardrobe and en suite shower room, a second en suite double bedroom, third guest bedroom, family rainfall shower room, and a laundry room. 2 parking spaces are also available. The apartment further benefits from engineered timber flooring, comfort cooling and underfloor heating throughout.

9 Millbank's defining feature is the rich mix of old and new – the restoration of a stunning 1920s Grade II listed building into homes that exemplify contemporary sophistication and capture the very essence of British luxury and style. Along with the original office building, the impressive former Imperial Chemical Industries' (ICI) headquarters, a new building Millbank Quarter was created alongside to complement and enhance the entire development.

This new addition also features stunning homes as well as commercial space at ground level, enhancing Horseferry Road and this entire riverside neighbourhood. Inside the exquisitely renovated residences you'll find original features and architectural detail just as majestic and beautiful as the exterior, making these homes truly unique and special.

All residents will have access to state-of-the-art amenities designed by Goddard Littlefair including a gym, swimming pool with spa and treatment room, cinema screening room, meeting rooms, secure underground parking and 24-hour concierge.



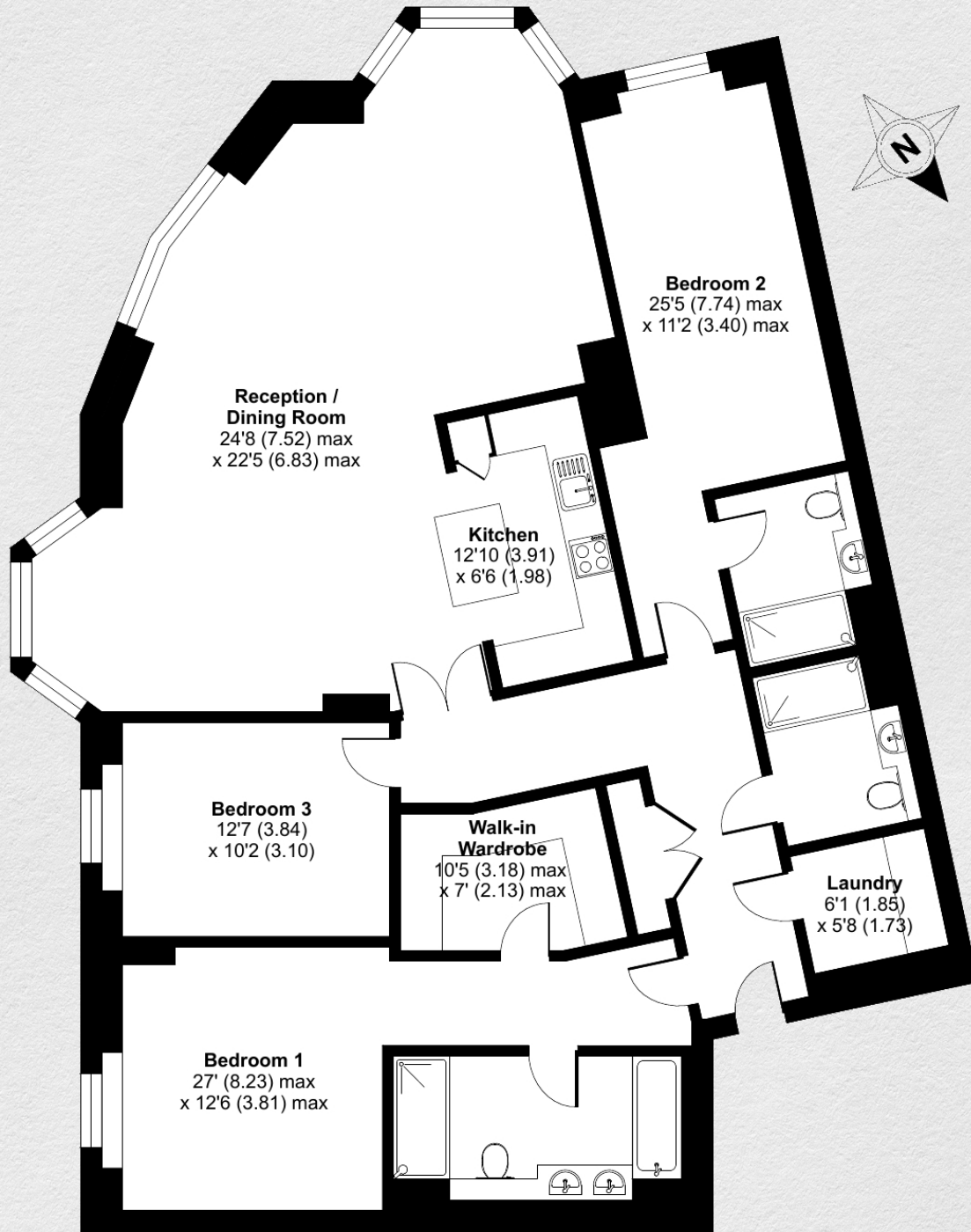

SECOND FLOOR

Address:	sq ft	bed	bath
9 Millbank, London, SW1P	1763	3	3

*** For illustration purposes only. Could not be to scale. One-London aims to ensure accuracy but is not liable for any discrepancies.*