



The Arbor. West Hamstead, NW6

£625,000

Situated next to an attractive slice of urban greenery, this spacious, bright, elegant apartment has stylish interiors and a high quality finish throughout, with accommodation including a superb open plan reception/kitchen, bedroom with dressing area and en-suite, and useful separate guest WC. Further features include ample inbuilt storage, quality floor coverings, security entry phone, and long lease.

- Private Balcony
- Floor to ceiling windows
- Underfloor heating
- Communal landscaped courtyard
- Views over Kilburn Grange Park
- Locked cycle storage & bike racks
- Secure gated development
- Siemens kitchen appliances

The Arbor Collection takes pride in its lush communal courtyard, eco-friendly green roof, and energy-efficient panels. Each apartment boasts contemporary kitchens fitted with Siemens appliances, elegant bathrooms and generously-sized bedrooms.

Transport into and out of central London is quick, convenient and efficient. The Jubilee Line runs a service from Kilburn Station to Bond Street that takes only 15 minutes and the Overground Line connects nearby Brondesbury Station to several key inner London destinations. The Thameslink rail network at West Hampstead connects with St Pancras (Eurostar), the City, the new Elizabeth Line (via Farringdon) and three of London's major international airports (Gatwick, Luton and Heathrow)..



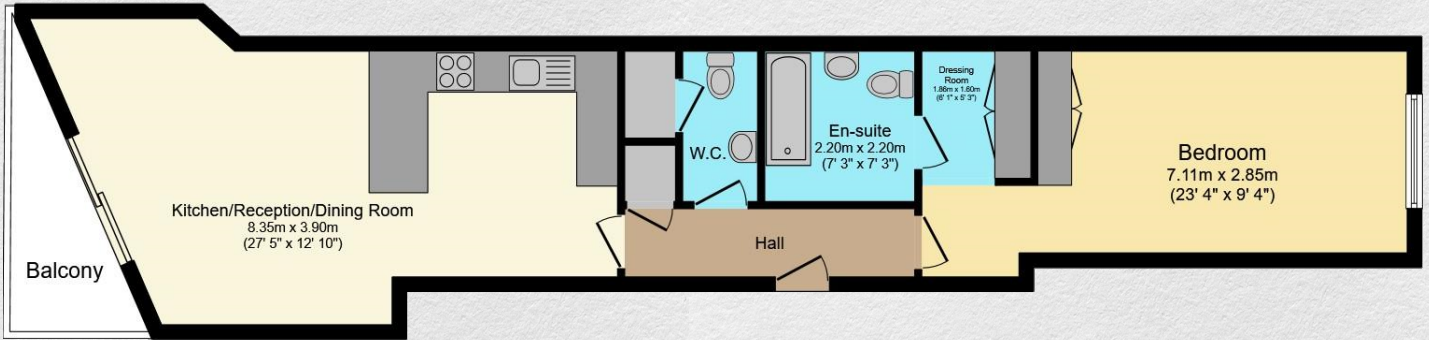

Address:	sq ft	bed	bath
The Arbor, West Hamstead, NW6	703	1	2

*** For illustration purposes only. Could not be to scale. One-London aims to ensure accuracy but is not liable for any discrepancies.*