



10 Watkin Road, Wembley, HA9

£430,000

- 1 Bedroom
- 1 Bathroom
- Spacious dining area
- 538 sq ft
- Luxury residents' facilities
- Large private balcony
- Allocated storage spaces
- Five Landscaped rooftop gardens
- 24-hour concierge
- Great transport links

Beautifully designed apartment in one of Wembley's newest developments with 23 stories and excellent transport links to central London, available to purchase.

This well-appointed one bed, one bath new build property, with a light and airy open plan living room and kitchen.

The development is only a few minutes' walk from the world-renowned SSE Arena, Box Park, London Designer shopping outlet, includes 50 outlets, cinema and 20 well-known restaurants.

The development is perfectly placed to benefit from London's vibrant culture and burgeoning art scene. From shopping on Bond Street and Oxford Street, to dining at some of the city's best restaurants, to peaceful walks in Regent's Park. There is something for everyone



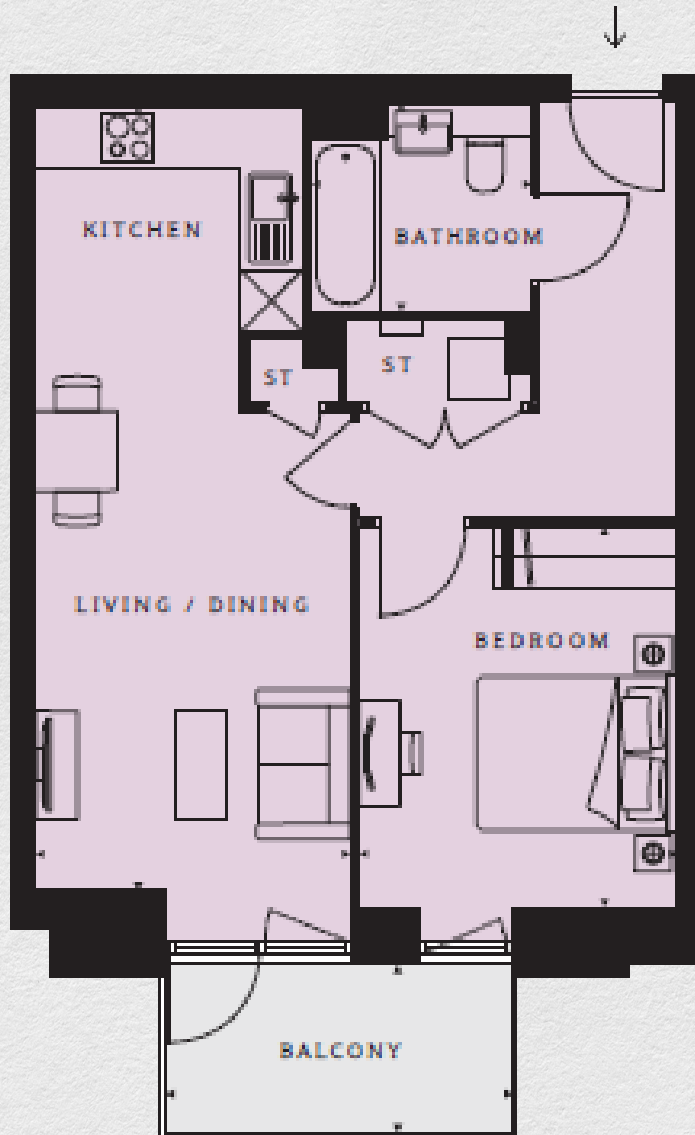

Address:

10 Watkin Road, Wembley, HA9

sq ft

538

bed

1

bath

1

*** For illustration purposes only. Could not be to scale. One-London aims to ensure accuracy but is not liable for any discrepancies.*