





# Southway, Camberley, GU15 3EA

Guide Price £225,000

🛏️ 4 🚿 1 🚻 1





A spacious four bedroom, second floor apartment offered with no onward chain complications. The property also has a store, garden and communal parking.

This large second floor apartment offers four bedrooms, living room, refitted kitchen, refitted bathroom and gas fired central heating. The property is a great first time or investment buy and is offered with no onward chain complications. The property also has a large store suitable for a bike, a garden and communal parking. The location is within easy distance to major road links and Camberley's town centre is a short drive with all of its amenities. This is one not to be missed and viewings are highly recommended to appreciate whats on offer.

Lease length – Approx 90 Years

Service Charge – Approx £110pcm

Ground Rent – Approx. £10py



5, Southway, Camberley, GU15 3EA

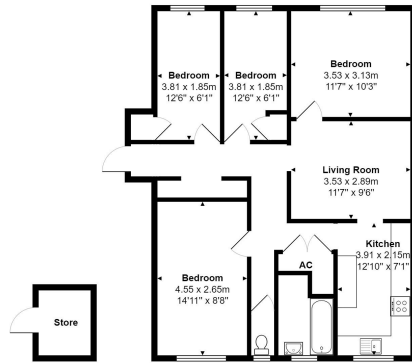

Total Area: 80.8 m<sup>2</sup> ... 869 ft<sup>2</sup>  
All measurements are approximate and for display purposes only

- Second Floor Apartment
- Over 800 sqft Of Accommodation
- Four Bedrooms
- Living Room
- Refitted Kitchen
- Refitted Bathroom
- Garden
- Bike Store
- Communal Parking
- No Onward Chain



01252 227121 [sales@labramholmes.co.uk](mailto:sales@labramholmes.co.uk)

[www.labramholmes.co.uk](http://www.labramholmes.co.uk)