



Willowbourne, Fleet, GU51 5AB

Offers Over £750,000

🛏️ 4 🚿 2 🚻 2



Situated in the highly regarded development of Edenbrook, is this stunning four bedroom detached 'Hapgood' design built by Berkeley Homes.

Offered with an array of high quality specifications including underfloor heating on the ground floor, this detached family home meets the demands of modern living. Internally, the property offers a stunning kitchen/breakfast room with fitted appliances. A large living / dining room featuring a fireplace, large bay window and offering access to the rear garden via patio doors. There is also a large integral garage. Upstairs boasts four double bedrooms, family bathroom and en suite and dressing room to the master bedroom. The front of the property offers driveway parking for two cars. The rear garden has been landscaped offering a patio seating area, well stocked plant and shrub borders, a large lawn and access to the front via a side gate.

Nearby is Hart Leisure Centre, which provides state of the art gym equipment, swimming pools and 3G pitches for a variety of sports. Fleet Station is under 2 miles away, providing direct connections to London Waterloo. Fleet town centre is also nearby (within a mile), offering a wide range of shopping facilities, cafes, bars and restaurants.

Viewings are highly recommended to appreciate what this property has to offer.



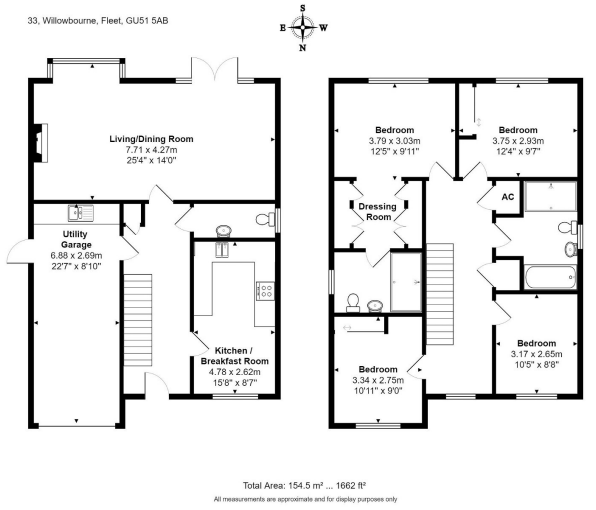

- Edenbrook Development
- Kitchen Breakfast Room
- South Facing Rear Garden
- Four Double Bedrooms
- Built By Berkeley Homes
- High Specification Throughout
- Large Living / Dining Room
- Garage & Driveway Parking
- En suite & Dressing Room To Master Bedroom
- Landscaped Gardens

