



30 Hollybrook Park

Bristol, BS15 1ST

£1,250 PCM

MAYFAIR
TOWN & COUNTRY

PROPERTY DESCRIPTION

Mayfair are delighted to offer for rent the lovely modern two bedroom apartment with Juliette Balcony and allocated parking located in Kingswood.

Unfortunately there are no pets taken at this property.

Contact us for more details or to book your appointment to view

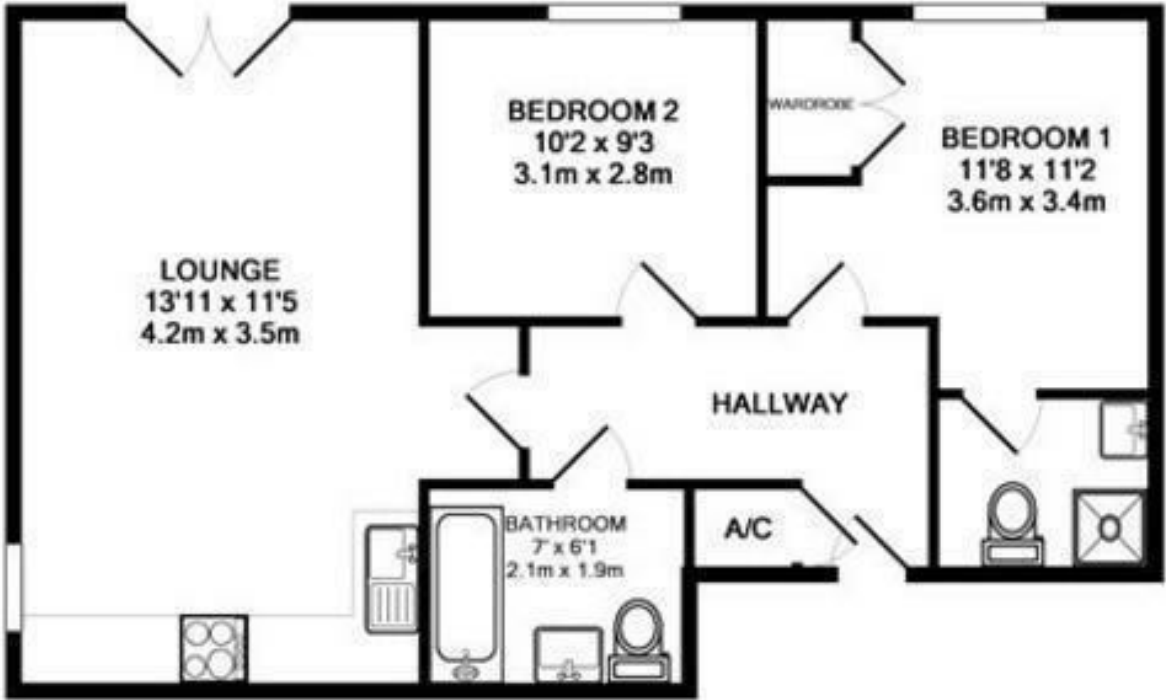

Made with Metropix ©2007

- Two Double Bedrooms
- Available Early October 2024
- Open Plan Living
- Well Presented Apartment
- Two Bathrooms
- Allocated Parking
- French Doors to a Juliet Balcony
- EPC Rating C

Energy Efficiency Rating		Current	Potential
Very energy efficient - lower running costs			
(92 plus)	A		
(81-91)	B		
(69-80)	C		
(55-68)	D		
(39-54)	E		
(21-38)	F		
(1-20)	G		
Not energy efficient - higher running costs			
England & Wales		EU Directive 2002/91/EC	



TO ARRANGE A VIEWING OR FOR FURTHER INFORMATION ON THIS PROPERTY PLEASE CONTACT OUR SALES TEAM

01275 341400

clevelandon@mayfairproperties.net

Local Authority

Bristol City Council Council Tax Band:

Tenure:

EPC Rating:



We would like to inform prospective purchasers that these sales particulars have been prepared as a general guide only. If there are any important matters likely to affect your decision to buy, please contact us before viewing the property.

1. Survey - A detailed survey has not been carried out, nor the services, appliances and fittings tested.
2. Floorplans All measurements walls, doors, windows, fittings and appliances, their sizes and locations are shown conventionally and are approximate and cannot be regarded as being representative either by the seller or his agent. Room sizes should not be relied upon for furnishing purposes and are approximate.
3. Mayfair Town & Country may make the following referrals and in exchange receive an introduction fee: Star Legal up to £120 inc VAT, Simply Conveyancing up to £240 inc VAT, HD Financial Ltd - introduction fee of up to £240 inc VAT

