



2 Dickinsons Fields

Bristol, BS3 5BG

£1,495 PCM

MAYFAIR
TOWN & COUNTRY

PROPERTY DESCRIPTION

Mayfair Town and Country are proud to present this tastefully furnished double bedroom property with parking and a garage. New flooring throughout alongside white paintwork with accent colours. The property is offered fully furnished; inclusive of sofa's, dining table, double beds and bedroom furniture. The large open plan living/dining room is perfect for entertaining guests. The separate kitchen is spacious, and includes white goods such as a washer/dryer, fridge/freezer, integrated oven and electric hobs. The second bedroom is a great size and comes inclusive of a large wardrobe, storage draws and curtains. The first bedroom comes with a separate en-suite room, and a generous sized storage cupboard; this bedroom also has two windows making the room feel light and spacious. The modern bathroom is spacious, has a shower over the bath, and includes a toilet basin and sink. There is also an additional storage section off the hallway which holds the water tank and is great for storing towels and linen. The property is fully electric throughout. The spacious garage that fits 1 car is located just outside the property, and even has an allocated parking space for another car in front of it. The property is located in the smart Dickinson's Field development and is only a short walk to Parson Street Station and the popular attractions of North Street. This flat will be perfect for working professionals or sharers. Available now.

- Two Double Bedrooms
- Fully Furnished
- Appliances Included
- Refurbished throughout
- Garage & Allocated Parking
- Family bathroom and separate en-suite
- EPC: D with electric heating
- Tax Band: B
- Deposit: £1,725
- Holding Deposit: £345

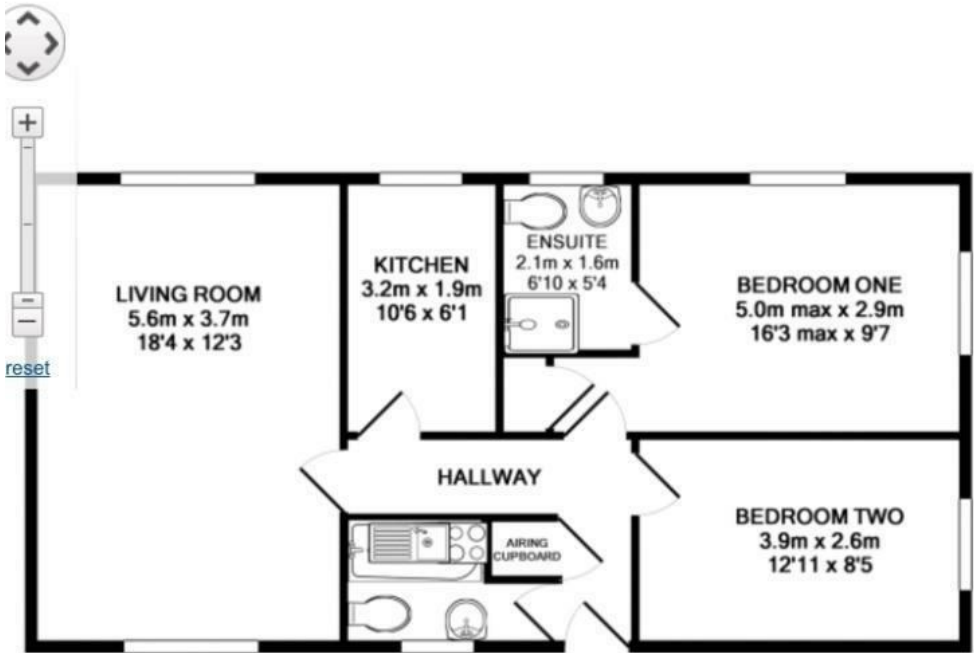

TOTAL APPROX. FLOOR AREA 62.3 SQ.M. (671 SQ.FT.)

Whilst every attempt has been made to ensure the accuracy of the floor plan contained here, measurements of doors, windows, rooms and any other items are approximate and no responsibility is taken for any error, omission, or mis-statement. This plan is for illustrative purposes only and should be used as such by any prospective purchaser. The services, systems and appliances shown have not been tested and no guarantee as to their operability or efficiency can be given
Made with Metropix ©2016

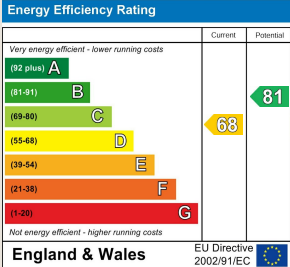

TO ARRANGE A VIEWING OR FOR FURTHER INFORMATION ON THIS PROPERTY PLEASE CONTACT OUR SALES TEAM

01275 341400

clevedon@mayfairproperties.net

Local Authority

Bristol City Council Council Tax Band: B

Tenure:

EPC Rating: D



We would like to inform prospective purchasers that these sales particulars have been prepared as a general guide only. If there are any important matters likely to affect your decision to buy, please contact us before viewing the property.

1. Survey - A detailed survey has not been carried out, nor the services, appliances and fittings tested.
2. Floorplans All measurements walls, doors, windows, fittings and appliances, their sizes and locations are shown conventionally and are approximate and cannot be regarded as being representative either by the seller or his agent. Room sizes should not be relied upon for furnishing purposes and are approximate.
3. Mayfair Town & Country may make the following referrals and in exchange receive an introduction fee: Simply Conveyancing up to £200 (plus VAT), HD Financial Ltd - introduction fee of up to £240 (plus VAT)

