



39 Fleet Street  
Beaminster, DT8 3EF

£1,100 PCM

**MAYFAIR**  
TOWN & COUNTRY

## Fleet Street, Beaminster, DT8

Approximate Area = 666 sq ft / 61.8 sq m  
For identification only - Not to scale

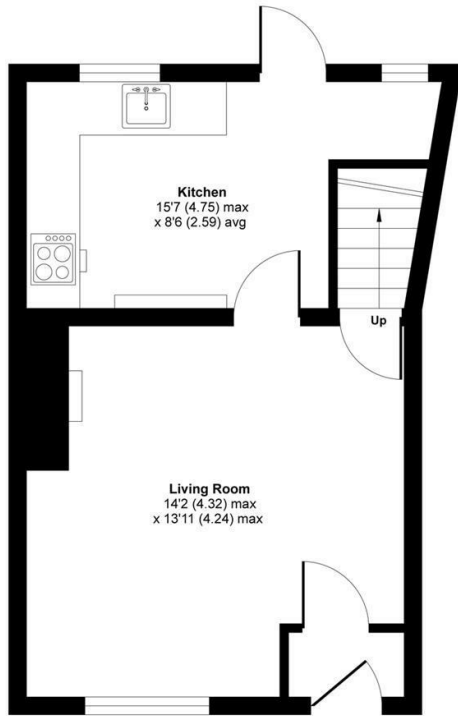

GROUND FLOOR

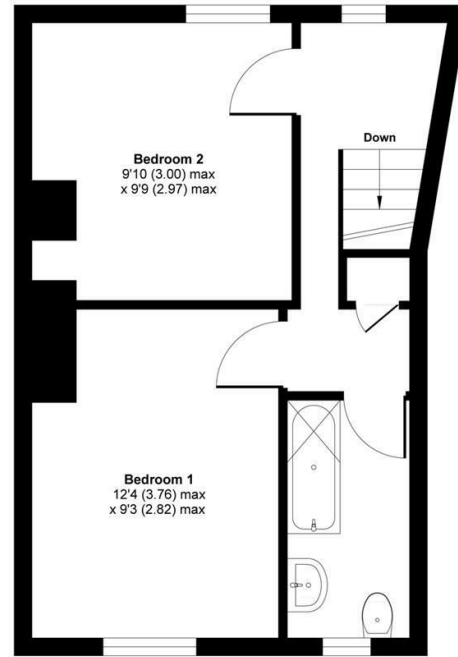

FIRST FLOOR



Floor plan produced in accordance with RICS Property Measurement Standards incorporating International Property Measurement Standards (IPMS2 Residential). © nichecom 2021. Produced for Mayfair Town & Country. REF: 680761

## PROPERTY DESCRIPTION

Charming two double bedroom period cottage with pretty garden, near the centre of Beaminster. Character cottage featuring woodburning stove, ledge and brace timber doors, deep windowsills and gas central heating.

- Quiet Central Location
- Period Features
- Refurbished To High Standard
- Short Level Walk To Town
- Woodburning Stove
- Fitted Kitchen
- Pretty Garden

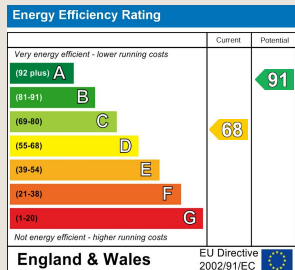

TO ARRANGE A VIEWING OR FOR FURTHER INFORMATION ON THIS PROPERTY PLEASE CONTACT OUR SALES TEAM

**01305 269200**

dorchester@mayfairproperties.net

### Local Authority

Dorset Council Council Tax Band: B

Tenure:

EPC Rating: D



We would like to inform prospective purchasers that these sales particulars have been prepared as a general guide only. If there are any important matters likely to affect your decision to buy, please contact us before viewing the property.

1. Survey - A detailed survey has not been carried out, nor the services, appliances and fittings tested.
2. Floorplans All measurements walls, doors, windows, fittings and appliances, their sizes and locations are shown conventionally and are approximate and cannot be regarded as being representative either by the seller or his agent. Room sizes should not be relied upon for furnishing purposes and are approximate.
3. Mayfair Town & Country may make the following referrals and in exchange receive an introduction fee: Simply Conveyancing up to £200 (plus VAT), HD Financial Ltd - introduction fee of up to £240 (plus VAT)

